

# 2021 MULE PRO-FXT™ EPS PARTS DIAGRAM

Transmission

E1361

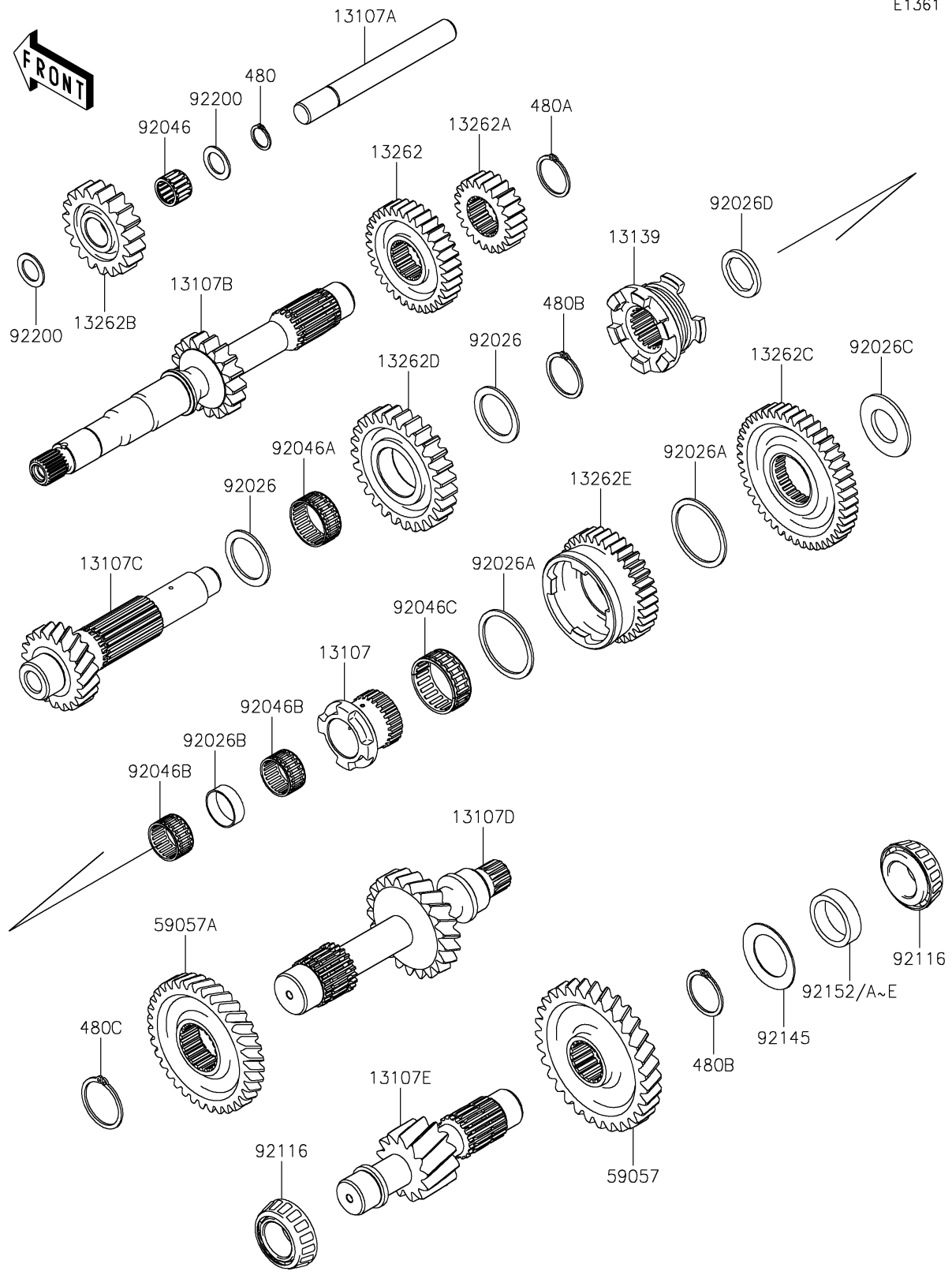

## 2021 MULE PRO-FXT™ EPS PARTS LIST

### Transmission

| ITEM NAME                                | PART NUMBER | QUANTITY |
|--|-------------|----------|
| SHAFT (Ref # 13107)                      | 13107-0779  | 1        |
| SHAFT,IDLE REV (Ref # 13107A)            | 13107-0780  | 1        |
| SHAFT,INPUT,17T (Ref # 13107B)           | 13107-0782  | 1        |
| SHAFT,COUNTER,20T (Ref # 13107C)         | 13107-0783  | 1        |
| SHAFT,3RD,21T (Ref # 13107D)             | 13107-0784  | 1        |
| SHAFT,4TH,13T (Ref # 13107E)             | 13107-0785  | 1        |
| SHIFTER (Ref # 13139)                    | 13139-0022  | 1        |
| GEAR,INPUT HI,33T (Ref # 13262)          | 13262-1085  | 1        |
| GEAR,INPUT LOW,22T (Ref # 13262A)        | 13262-1086  | 1        |
| GEAR,IDLE REV,19T (Ref # 13262B)         | 13262-1087  | 1        |
| GEAR,COUNTER LOW,45T (Ref # 13262C)      | 13262-1088  | 1        |
| GEAR,COUNTER REV,27T (Ref # 13262D)      | 13262-1089  | 1        |
| GEAR,COUNTER HI,34T (Ref # 13262E)       | 13262-1090  | 1        |
| CIRCLIP-TYPE-C,18MM (Ref # 480)          | 480J1800    | 1        |
| CIRCLIP-TYPE-C,32MM (Ref # 480A)         | 480J3200    | 1        |
| CIRCLIP (Ref # 480B)                     | 480J3500    | 2        |
| CIRCLIP (Ref # 480C)                     | 480J4000    | 1        |
| GEAR-HELICAL,31T (Ref # 59057)           | 59057-0013  | 1        |
| GEAR-HELICAL,3RD,35T (Ref # 59057A)      | 59057-0015  | 1        |
| SPACER,35.2X47X2 (Ref # 92026)           | 92026-0765  | 2        |
| SPACER,49.2X58X2 (Ref # 92026A)          | 92026-0766  | 2        |
| SPACER,29.4X31.8X10 (Ref # 92026B)       | 92026-0767  | 1        |
| SPACER (Ref # 92026C)                    | 92026-0768  | 1        |
| SPACER,28.2X39X3.6 (Ref # 92026D)        | 92026-0795  | 1        |
| BEARING-NEEDLE,FMJ-182417 (Ref # 92046)  | 92046-0040  | 1        |
| BEARING-NEEDLE,35X40X17 (Ref # 92046A)   | 92046-0611  | 1        |
| BEARING-NEEDLE,KT283317C3 (Ref # 92046B) | 92046-0621  | 2        |
| BEARING-NEEDLE,HIGH GEAR (Ref # 92046C)  | 92046-1276  | 1        |
| BEARING-ROLLER (Ref # 92116)             | 92116-0014  | 2        |

## 2021 MULE PRO-FXT™ EPS PARTS LIST

### Transmission

| ITEM NAME                        | PART NUMBER | QUANTITY |
|----------------------------------|-------------|----------|
| SPRING (Ref # 92145)             | 92145-1575  | 1        |
| COLLAR,L=12.1 (Ref # 92152)      | 92152-1815  | AR       |
| COLLAR,L=12.3 (Ref # 92152A)     | 92152-1816  | AR       |
| COLLAR,L=12.5 (Ref # 92152B)     | 92152-1817  | AR       |
| COLLAR,L=12.7 (Ref # 92152C)     | 92152-1818  | AR       |
| COLLAR,L=12.9 (Ref # 92152D)     | 92152-1819  | AR       |
| COLLAR,L=13.1 (Ref # 92152E)     | 92152-1820  | AR       |
| WASHER,18.2X28X1.5 (Ref # 92200) | 92200-0716  | 2        |