

2019 VERSYS[®] 1000 SE LT+ PARTS DIAGRAM

Engine Mount

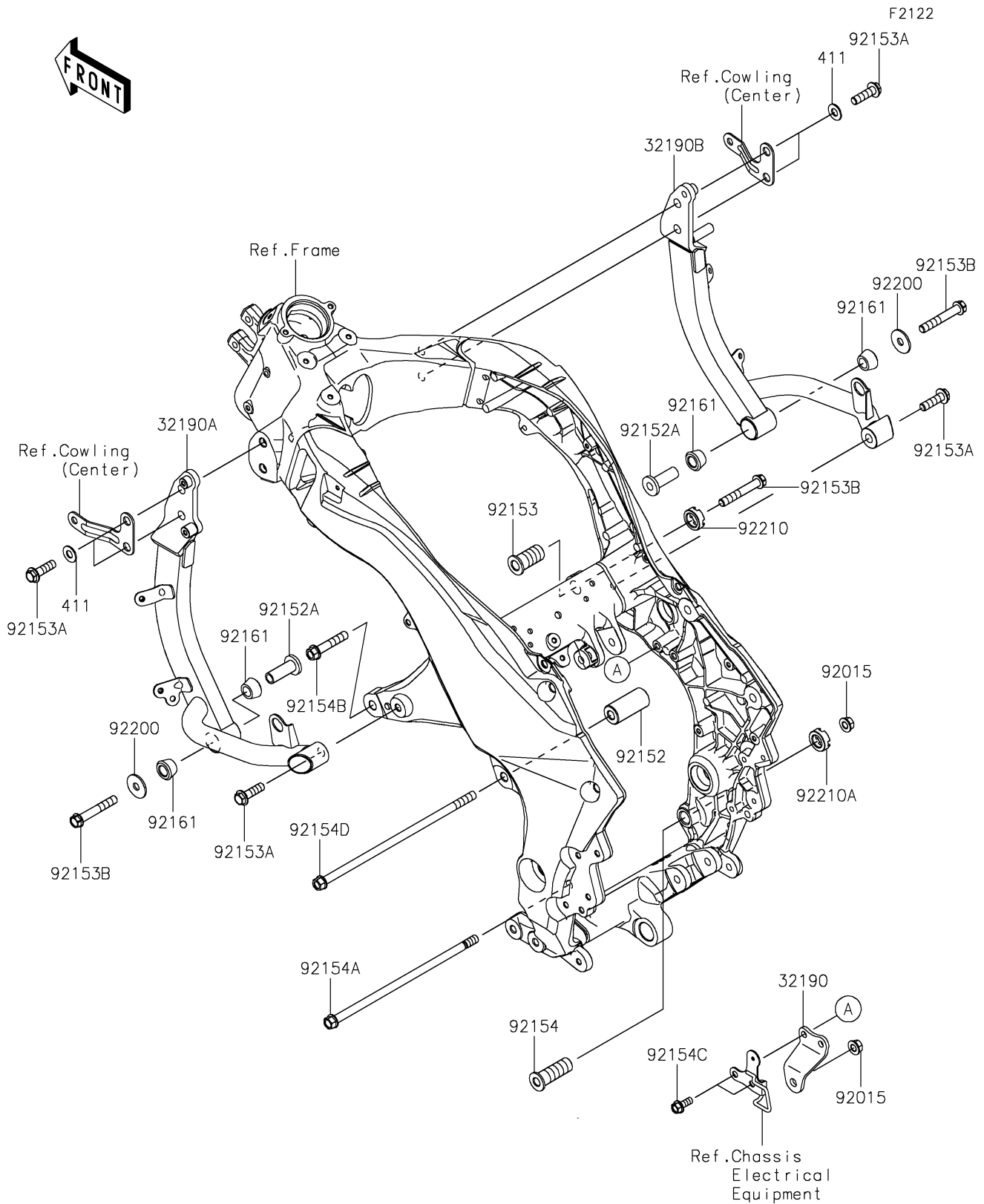

2019 VERSYS® 1000 SE LT+ PARTS LIST

Engine Mount

ITEM NAME	PART NUMBER	QUANTITY
BRACKET-ENGINE,CR CASE UPP,BLK (Ref # 32190)	32190-0458-18R	1
BRACKET-ENGINE,LH,F.S.BLACK (Ref # 32190A)	32190-0780-18R	1
BRACKET-ENGINE,RH,F.S.BLACK (Ref # 32190B)	32190-0781-18R	1
WASHER-PLAIN,10MM (Ref # 411)	411AA1000	4
NUT,FLANGED,10MM (Ref # 92015)	92015-1180	2
COLLAR,11X26X56.5 (Ref # 92152)	92152-0853	1
COLLAR,10.5X14.5X44 (Ref # 92152A)	92152-1908	2
BOLT,SOCKET,20X43 (Ref # 92153)	92153-0488	1
BOLT,FLANGED,10X35 (Ref # 92153A)	92153-0802	6
BOLT,FLANGED,10X65 (Ref # 92153B)	92153-1931	3
BOLT,ENGINE MOUNT,18X53.5 (Ref # 92154)	92154-0267	1
BOLT,FLANGED,10X255 (Ref # 92154A)	92154-0827	1
BOLT,FLANGED,10X54 (Ref # 92154B)	92154-0903	1
BOLT,FLANGED,8X20 (Ref # 92154C)	92154-1852	2
BOLT,FLANGED,10X270 (Ref # 92154D)	92154-2309	1
DAMPER,13.7X26X15 (Ref # 92161)	92161-1687	4
WASHER,10.2X32X2.3 (Ref # 92200)	92200-0978	2
NUT,20MM (Ref # 92210)	92210-0591	1
NUT,18MM (Ref # 92210A)	92210-1203	1