

1994 KX60 PARTS DIAGRAM

Clutch

E1350

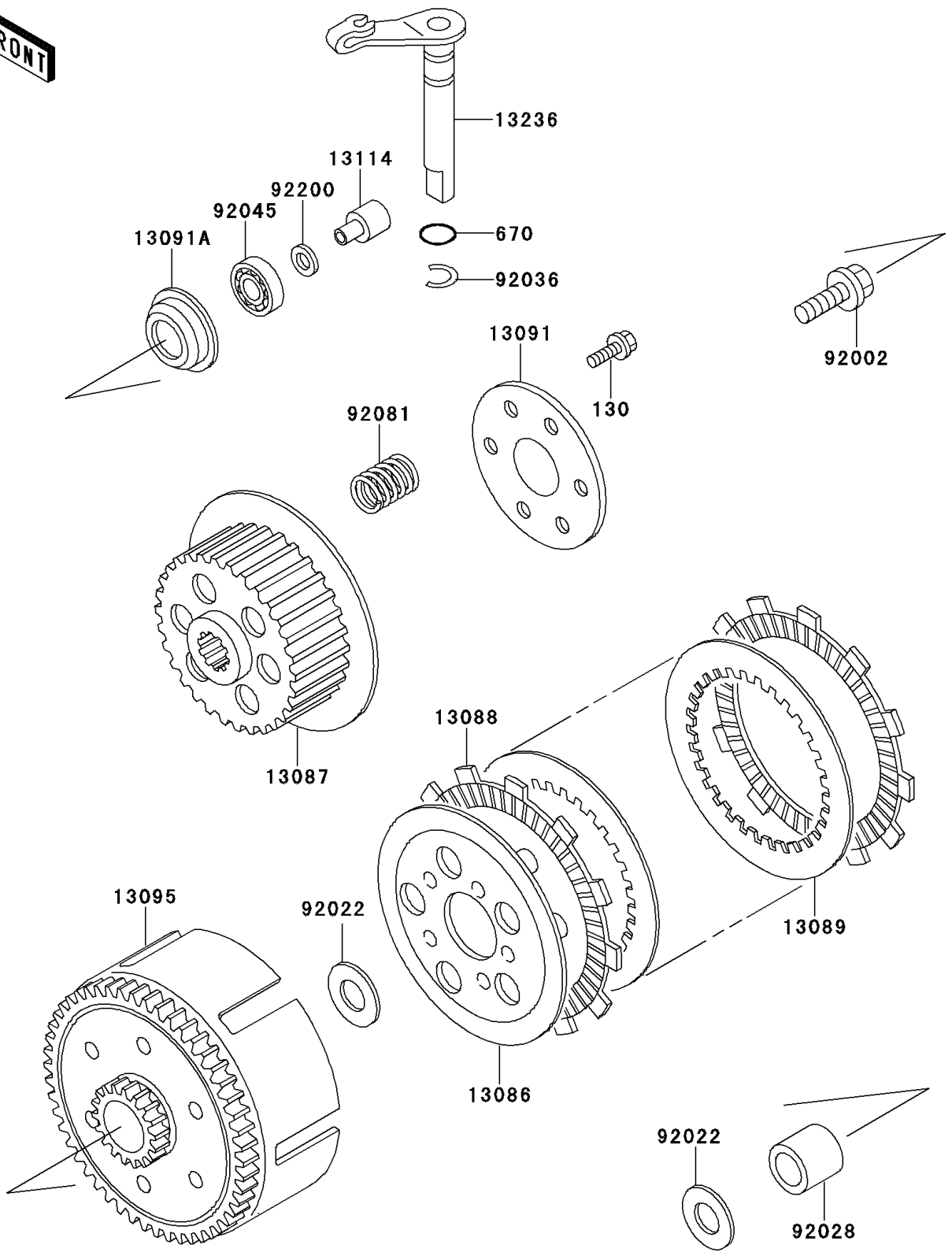

1994 KX60 PARTS LIST

Clutch

| ITEM NAME | PART NUMBER | QUANTITY |
|---|-------------|----------|
| BOLT-FLANGED (Ref # 130) | 130P0520 | 6 |
| O RING,9MM (Ref # 670) | 670B1509 | 1 |
| WHEEL-CLUTCH (Ref # 13086) | 13086-1002 | 1 |
| HUB-CLUTCH (Ref # 13087) | 13087-1051 | 1 |
| PLATE-FRICTION (Ref # 13088) | 13088-1010 | 5 |
| PLATE-CLUTCH,STEEL (Ref # 13089) | 13089-1009 | 4 |
| HOLDER,CLUTCH SPRING (Ref # 13091) | 13091-1115 | 1 |
| HOLDER,CLUTCH PUSHER (Ref # 13091A) | 13091-1133 | 1 |
| HOUSING-COMP-CLUTCH (Ref # 13095) | 13095-1042 | 1 |
| PUSHER-CLUTCH (Ref # 13114) | 13114-1055 | 1 |
| LEVER-COMP,CLUTCH RELEASE (Ref # 13236) | 13236-1161 | 1 |
| BOLT,10X30 (Ref # 92002) | 92002-1697 | 1 |
| WASHER,17.3X28X1 (Ref # 92022) | 92022-255 | 2 |
| BUSHING,17X22X21.1 (Ref # 92028) | 92028-1149 | 1 |
| RING-SNAP (Ref # 92036) | 92036-023 | 1 |
| BEARING-BALL (Ref # 92045) | 92045-1236 | 1 |
| SPRING,CLUTCH (Ref # 92081) | 92081-1143 | 6 |
| WASHER,7X12.5X0.8 (Ref # 92200) | 92200-1197 | AR |