

1989 KX80 PARTS DIAGRAM

Front Fork(L2/N2/)

F2340-0293

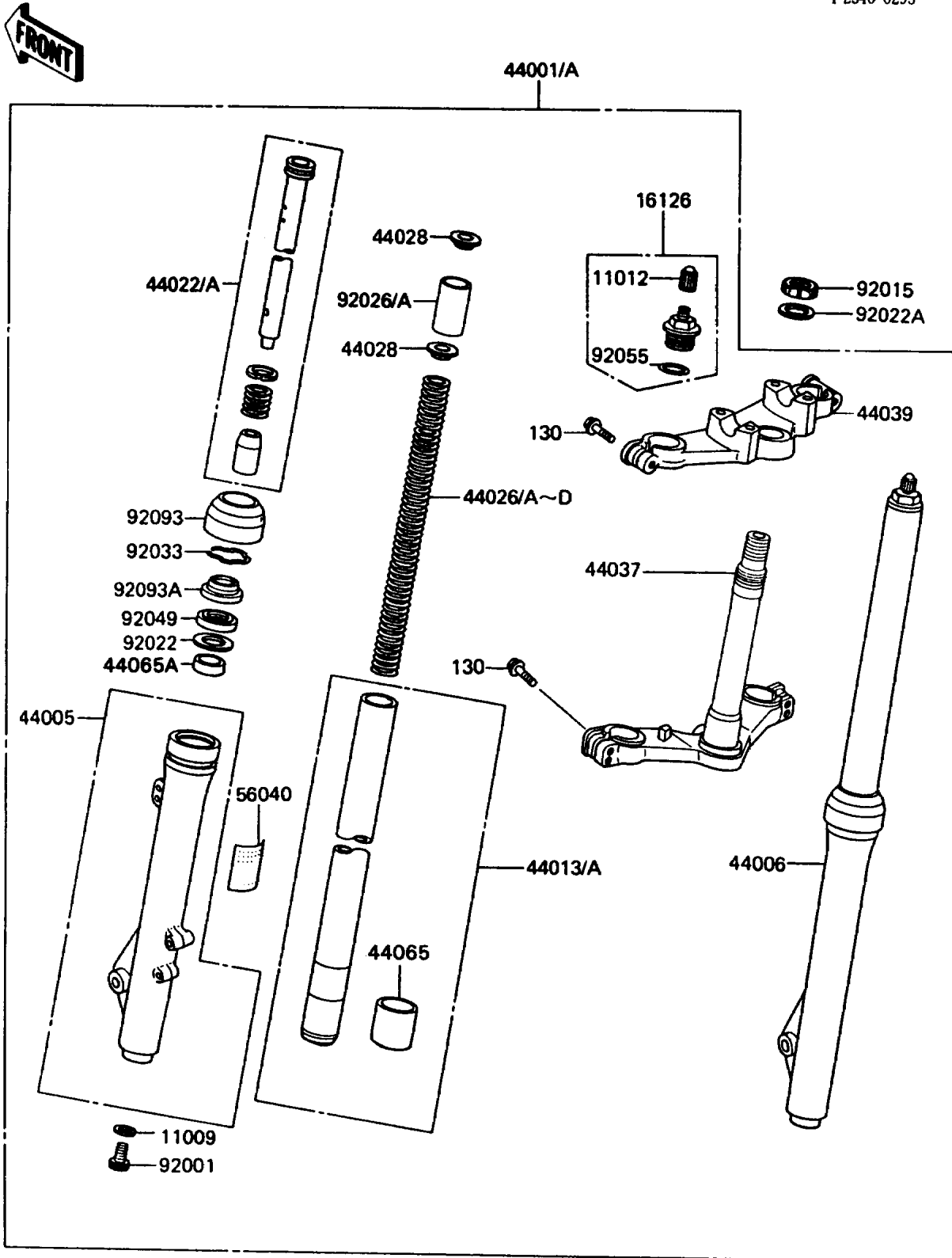

1989 KX80 PARTS LIST

Front Fork(L2/N2/)

ITEM NAME	PART NUMBER	QUANTITY
GASKET (Ref # 11009)	44045-057	2
CAP,VALVE AIR (Ref # 11012)	11012-1391	2
VALVE,AIR (Ref # 16126)	16126-1145	2
FORK-FRONT (Ref # 44001)	44001-1703	1
PIPE-LEFT FORK OUTER (Ref # 44005)	44005-1263	1
PIPE-RIGHT FORK OUTER (Ref # 44006)	44006-1260	1
PIPE-FORK INNER (Ref # 44013)	44013-1282	2
CYLINDER-FORK (Ref # 44022)	44022-1232	2
SPRING-FRONT FORK,K=0.27 (Ref # 44026)	44026-1403	2
SPRING-FRONT FORK,K=0.28 (Ref # 44026A)	44026-1405	2
SPRING-FRONT FORK,K=0.26 (Ref # 44026B)	44026-1406	2
GUIDE-FORK SPRING (Ref # 44028)	44028-1004	4
HOLDER-FORK UNDER (Ref # 44037)	44037-1225	1
HOLDER-FORK UPPER (Ref # 44039)	44039-1183	1
BUSHING-FRONT FORK,INNER PIPE (Ref # 44065)	44065-1088	2
BUSHING-FRONT FORK (Ref # 44065A)	44065-1089	2
LABEL-WARNING,FRONT FORK (Ref # 56040)	56040-1120	1
BOLT,SOCKET,FORK CYLINDER (Ref # 92001)	44041-040	2
NUT,STEERING STEM,22MM (Ref # 92015)	92015-1653	1
WASHER,FORK (Ref # 92022)	92022-1801	2
WASHER,STEERING STEM (Ref # 92022A)	92022-1873	1
SPACER,FORK,L=13.5 (Ref # 92026)	92026-1360	2
RING-SNAP (Ref # 92033)	44044-015	2
SEAL-OIL,FORK (Ref # 92049)	92049-1252	2
RING-O (Ref # 92055)	92055-1318	2
SEAL,FORK (Ref # 92093)	92093-1202	2
SEAL,FORK OUTER TUBE (Ref # 92093A)	92093-1250	2
BOLT-FLANGED,8X35 (Ref # 130)	130G0835	6