

2021 Ninja H2 SX SE+ PARTS DIAGRAM

Chassis Electrical Equipment

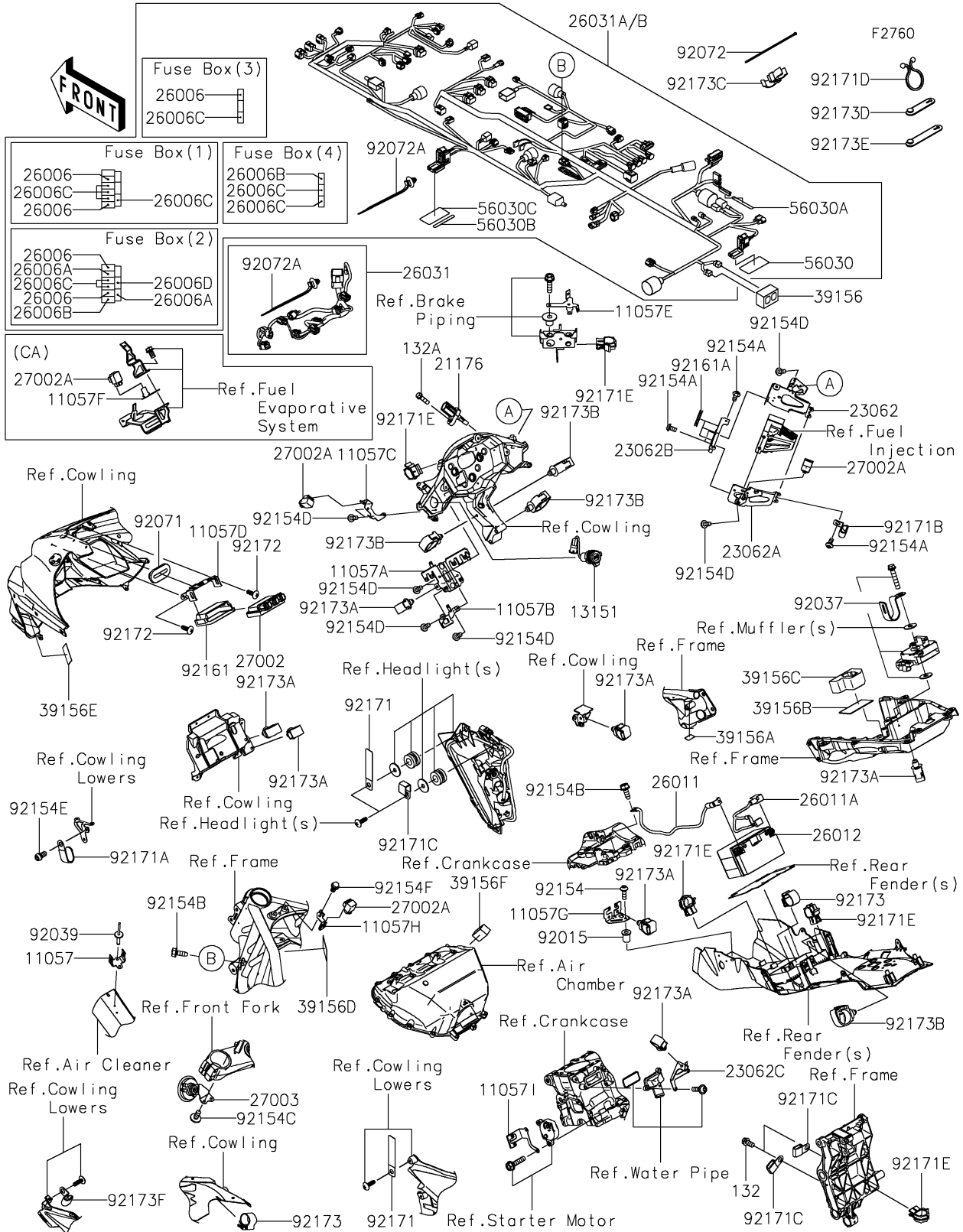

2021 Ninja H2 SX SE+ PARTS LIST

Chassis Electrical Equipment

ITEM NAME	PART NUMBER	QUANTITY
BRACKET,GRIP HEATER (Ref # 11057)	11057-1280	1
BRACKET,GYRO SENSOR (Ref # 11057A)	11057-1281	1
BRACKET,CONNECTOR (Ref # 11057B)	11057-1282	1
BRACKET,FUSE BOX (Ref # 11057C)	11057-1283	1
BRACKET,RELAY BOX (Ref # 11057D)	11057-1284	1
BRACKET,SUB HARNESS CONNECTOR (Ref # 11057E)	11057-1476	1
BRACKET,RELAY (Ref # 11057F)	11057-1477	1
BRACKET,RR FENDER (Ref # 11057G)	11057-1481	1
BRACKET,RELAY (Ref # 11057H)	11057-1636	1
BRACKET,STARTER (Ref # 11057I)	11057-1655	1
SWITCH-COMP,DC OUTLET (Ref # 13151)	13151-0579	1
SENSOR,AIR TEMPERATURE (Ref # 21176)	21176-0048	1
BRACKET-COMP,ECU,OUTER (Ref # 23062)	23062-0973	1
BRACKET-COMP,ECU,INNER (Ref # 23062A)	23062-0974	1
BRACKET-COMP,ECU,COVER (Ref # 23062B)	23062-0994	1
BRACKET-COMP,WATER PIPE (Ref # 23062C)	23062-1154	1
FUSE,MINI BLADE,15A,BLUE (Ref # 26006)	26006-0001	5
FUSE,MINI BLADE,25A,NATURAL (Ref # 26006A)	26006-0020	2
FUSE,MINI BLADE,7.5A,BROWN (Ref # 26006B)	26006-0055	2
FUSE,MINI BLADE,10A,RED (Ref # 26006C)	26006-1078	9
FUSE,MINI BLADE,30A,GREEN (Ref # 26006D)	26006-1080	1
WIRE-LEAD,BATTERY(-) (Ref # 26011)	26011-1856	1
WIRE-LEAD,BATTERY(+) (Ref # 26011A)	26011-1872	1
BATTERY,YTZ10S,12V 8.6AH (Ref # 26012)	26012-0564	1
HARNESS,SUB (Ref # 26031)	26031-2370	1
HARNESS,MAIN (Ref # 26031A)	26031-2563	1
HARNESS,MAIN (Ref # 26031B)	26031-2564	1
RELAY-ASSY (Ref # 27002)	27002-0050	1
RELAY-ASSY (Ref # 27002A)	27002-1062	3

2021 Ninja H2 SX SE+ PARTS LIST

Chassis Electrical Equipment

ITEM NAME	PART NUMBER	QUANTITY
HORN (Ref # 27003)	27003-0147	1
PAD,DIAG,40X30X56 (Ref # 39156)	39156-1991	1
PAD,15X25X1 (Ref # 39156A)	39156-2119	1
PAD,40X90X2 (Ref # 39156B)	39156-2339	1
PAD,FUSE BOX (Ref # 39156C)	39156-2426	1
PAD,73X38X1 (Ref # 39156D)	39156-2467	1
PAD,55X25X1 (Ref # 39156E)	39156-2476	1
PAD,25X50X20 (Ref # 39156F)	39156-2491	1
LABEL,FUSE BOX2 (Ref # 56030)	56030-1408	1
LABEL,FUSE BOX4 (Ref # 56030A)	56030-1458	1
LABEL,FUSE BOX3 (Ref # 56030B)	56030-1460	1
LABEL,FUSE BOX1 (Ref # 56030C)	56030-1461	1
NUT,WELL,5MM (Ref # 92015)	92015-1757	1
CLAMP,CABLE,STEEL SHEET (Ref # 92037)	92037-2014	1
RIVET (Ref # 92039)	92039-0039	2
GROMMET (Ref # 92071)	92071-0013	1
BAND,202X3.6 (Ref # 92072)	92072-0782	3
BAND,OS170-FT7(BLACK) (Ref # 92072A)	92072-1414	AR
BOLT,SOCKET,5X16 (Ref # 92154)	92154-0209	1
BOLT,SOCKET,5X10 (Ref # 92154A)	92154-0211	5
BOLT,FLANGED,6X16 (Ref # 92154B)	92154-0551	2
BOLT,SOCKET,6X14 (Ref # 92154C)	92154-0745	2
BOLT,SOCKET,5X12 (Ref # 92154D)	92154-0917	8
BOLT,SOCKET,6X12 (Ref # 92154E)	92154-1453	1
BOLT,FLANGED,6X10 (Ref # 92154F)	92154-2819	1
DAMPER,RELAY BOX (Ref # 92161)	92161-0203	1
DAMPER,ECU (Ref # 92161A)	92161-2071	3
CLAMP,L=60 (Ref # 92171)	92171-0652	2
CLAMP (Ref # 92171A)	92171-0739	1

2021 Ninja H2 SX SE+ PARTS LIST

Chassis Electrical Equipment

ITEM NAME	PART NUMBER	QUANTITY
CLAMP (Ref # 92171B)	92171-0766	1
CLAMP (Ref # 92171C)	92171-0813	3
CLAMP (Ref # 92171D)	92171-1185	2
CLAMP,EDGE CLIP (Ref # 92171E)	92171-1722	5
SCREW,TAPPING,5X10 (Ref # 92172)	92172-0335	2
CLAMP,CLIP (Ref # 92173)	92173-0127	2
CLAMP,12MM DIA. (Ref # 92173A)	92173-0736	7
CLAMP (Ref # 92173B)	92173-0861	4
CLAMP,PIPE (Ref # 92173C)	92173-0985	1
CLAMP,RUBBER PLATE (Ref # 92173D)	92173-1229	3
CLAMP (Ref # 92173E)	92173-1526	4
CLAMP,12X45 (Ref # 92173F)	92173-1839	1
BOLT-FLANGED-SMALL,6X12 (Ref # 132)	132BA0612	2
BOLT-FLANGED-SMALL (Ref # 132A)	132BB0516	1