

1993 KX80 PARTS DIAGRAM

Front Fork(KX80-R2/R3)

F 23 4 0

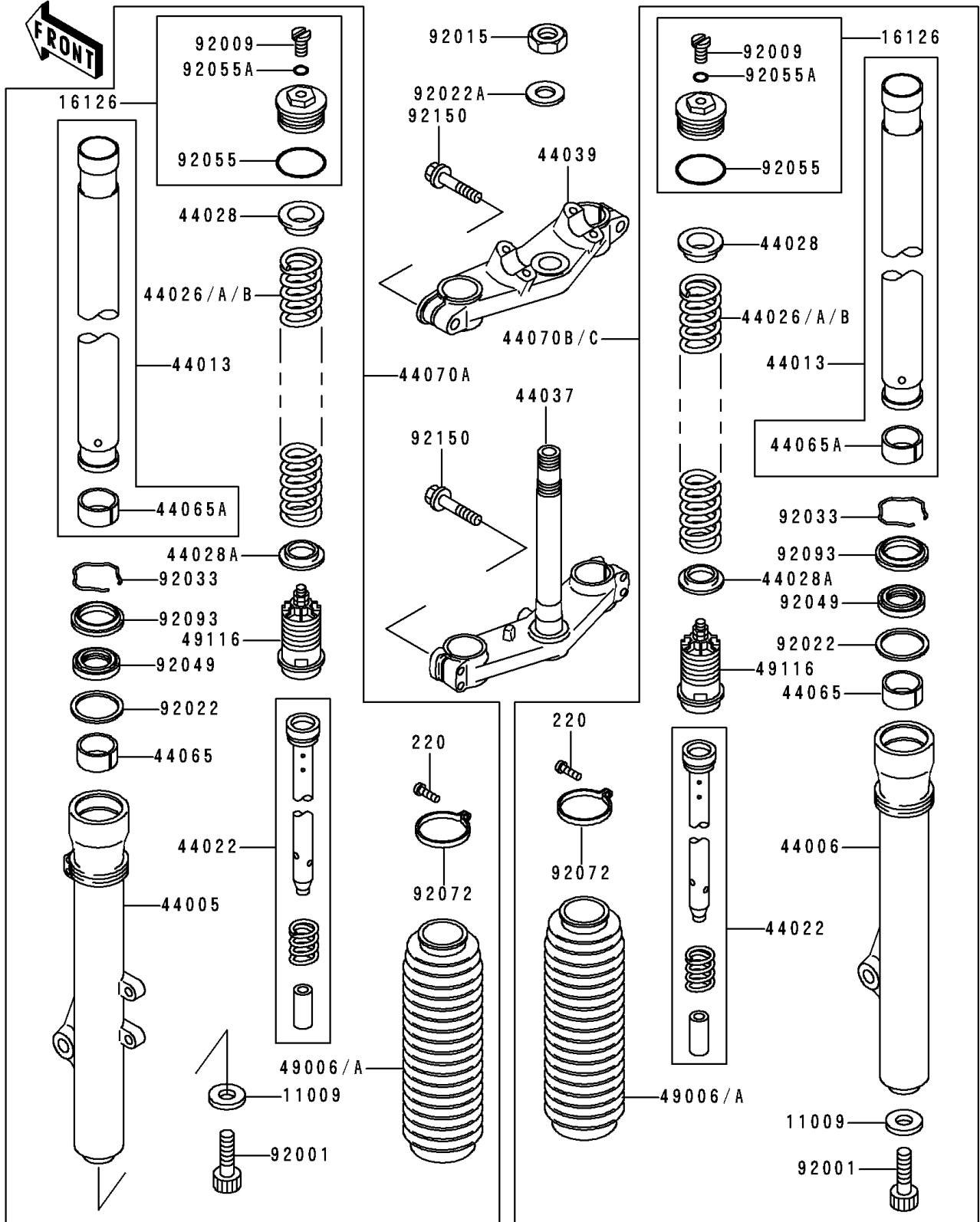

1993 KX80 PARTS LIST

Front Fork(KX80-R2/R3)

ITEM NAME	PART NUMBER	QUANTITY
SCREW-PAN-CROS (Ref # 220)	220C0416	2
GASKET,FORK CYLINDER BOLT (Ref # 11009)	11009-1127	2
VALVE,AIR (Ref # 16126)	16126-1265	2
PIPE-LEFT FORK OUTER (Ref # 44005)	44005-1314	1
PIPE-RIGHT FORK OUTER (Ref # 44006)	44006-1311	1
PIPE-FORK INNER (Ref # 44013)	44013-1360	2
CYLINDER-FORK (Ref # 44022)	44022-1271	2
SPRING-FRONT FORK,K=0.26 (Ref # 44026)	44026-1506	2
SPRING-FRONT FORK,K=0.25 (Ref # 44026A)	44026-1516	2
SPRING-FRONT FORK,K=0.27 (Ref # 44026B)	44026-1517	2
GUIDE-FORK SPRING (Ref # 44028)	44028-1059	2
GUIDE-FORK SPRING (Ref # 44028A)	44028-1068	2
HOLDER-FORK UNDER (Ref # 44037)	44037-1293	1
HOLDER-FORK UPPER (Ref # 44039)	44039-1220	1
BUSHING-FRONT FORK (Ref # 44065)	44065-1106	2
BUSHING-FRONT FORK,INNER PIPE (Ref # 44065A)	44065-1107	2
DAMPER-ASSY,FORK (Ref # 44070)	44070-5053	1
BOOT,FORK,BLUE (Ref # 49006A)	49006-1273-GF	2
VALVE-ASSY,FORK (Ref # 49116)	49116-1098	2
BOLT,FORK CYLINDER (Ref # 92001)	92001-1309	2
SCREW (Ref # 92009)	92009-1568	2
NUT,STEERING STEM,22MM (Ref # 92015)	92015-1653	1
WASHER (Ref # 92022)	92022-1242	2
WASHER,STEERING STEM (Ref # 92022A)	92022-1873	1
RING-SNAP,FORK (Ref # 92033)	92033-1047	2
CLAMP,BOOT,BLACK (Ref # 92037)	92037-1321	2
SEAL-OIL,FRONT FORK (Ref # 92049)	92049-1180	2
RING-O,FORK TOP CAP (Ref # 92055)	92055-1050	2
RING-O (Ref # 92055A)	92055-1441	2

1993 KX80 PARTS LIST

Front Fork(KX80-R2/R3)

ITEM NAME	PART NUMBER	QUANTITY
SEAL,FRONT FORK (Ref # 92093)	92093-1166	2
BOLT,FLANGED,8X35 (Ref # 92150)	92150-1499	6