

2008 Ninja® ZX™-10R PARTS DIAGRAM

Air Cleaner

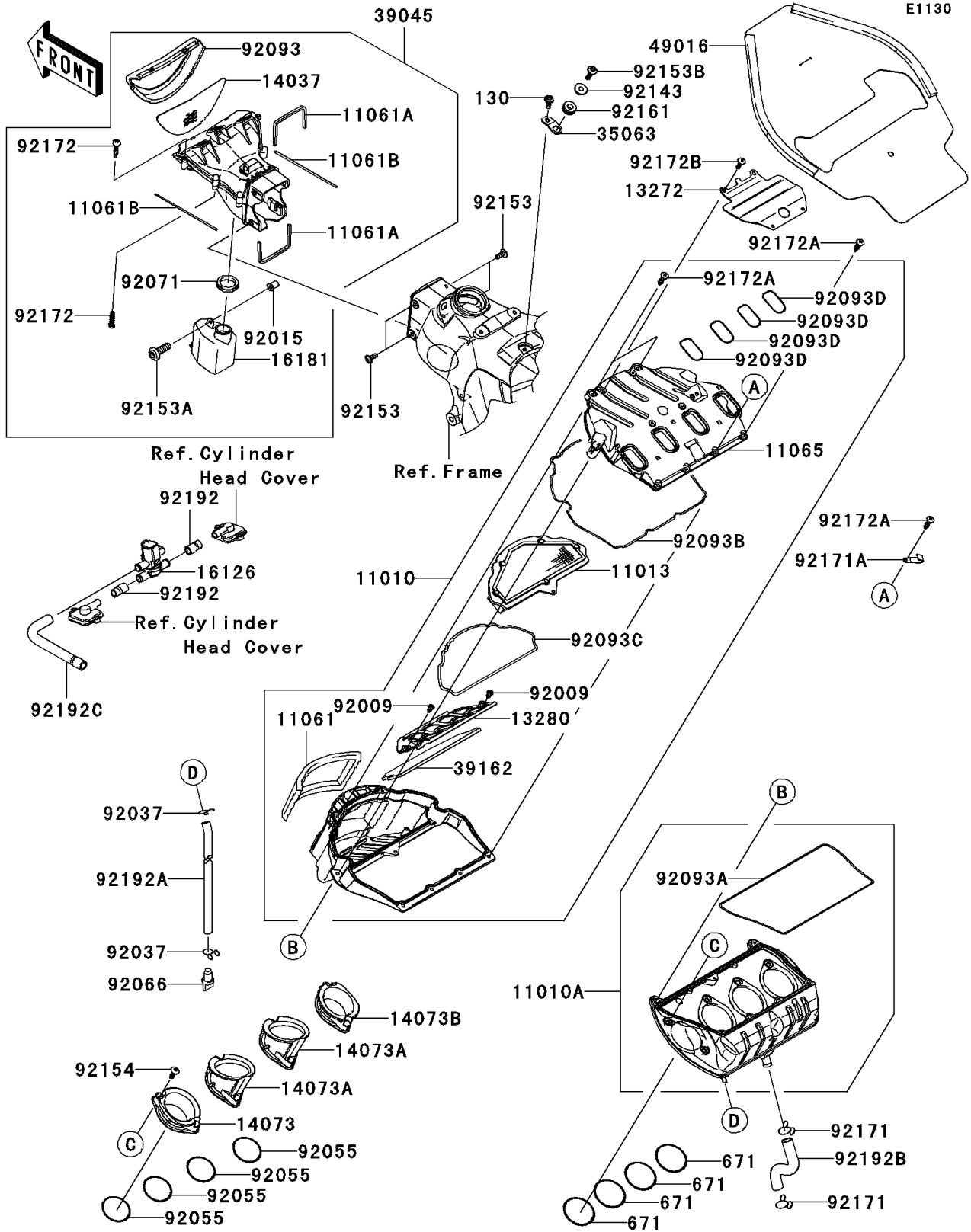

2008 Ninja® ZX™-10R PARTS LIST

Air Cleaner

| ITEM NAME | PART NUMBER | QUANTITY |
|------------------------------------|-------------|----------|
| FILTER-ASSY-AIR,UPP (Ref # 11010) | 11010-0138 | 1 |
| FILTER-ASSY-AIR,LWR (Ref # 11010A) | 11010-0170 | 1 |
| ELEMENT-AIR FILTER (Ref # 11013) | 11013-0026 | 1 |
| GASKET (Ref # 11061) | 11061-0309 | 1 |
| GASKET (Ref # 11061A) | 11061-0315 | 2 |
| GASKET (Ref # 11061B) | 11061-0316 | 2 |
| CAP (Ref # 11065) | 11065-0225 | 1 |
| PLATE (Ref # 13272) | 13272-0521 | 1 |
| HOLDER,SILENCER (Ref # 13280) | 13280-0272 | 1 |
| SCREEN (Ref # 14037) | 14037-0077 | 1 |
| DUCT,FUNNEL,#1 (Ref # 14073) | 14073-0231 | 1 |
| DUCT,FUNNEL,#2 (Ref # 14073A) | 14073-0232 | 2 |
| DUCT,FUNNEL,#4 (Ref # 14073B) | 14073-0233 | 1 |
| VALVE,AIR SWITCHING (Ref # 16126) | 16126-0038 | 1 |
| TANK-RESONATOR (Ref # 16181) | 16181-0013 | 1 |
| STAY (Ref # 35063) | 35063-0447 | 1 |
| DUCT-ASSY,RAM (Ref # 39045) | 39045-0036 | 1 |
| SILENCER-INTAKE (Ref # 39162) | 39162-0006 | 1 |
| COVER-SEAL (Ref # 49016) | 49016-0051 | 1 |
| SCREW,TAPPING,5X10 (Ref # 92009) | 92009-1499 | 2 |
| NUT,WELL,5MM (Ref # 92015) | 92015-1757 | 1 |
| CLAMP,TUBE (Ref # 92037) | 92037-147 | 2 |
| RING-O (Ref # 92055) | 92055-0156 | 4 |
| PLUG,DRAIN (Ref # 92066) | 92066-1211 | 1 |
| GROMMET (Ref # 92071) | 92071-1137 | 1 |
| SEAL (Ref # 92093) | 92093-0098 | 1 |
| SEAL,3X805 (Ref # 92093A) | 92093-0108 | 1 |
| SEAL,3X925 (Ref # 92093B) | 92093-0109 | 1 |
| SEAL,3X570 (Ref # 92093C) | 92093-0110 | 1 |

2008 Ninja® ZX™-10R PARTS LIST

Air Cleaner

| ITEM NAME | PART NUMBER | QUANTITY |
|-----------------------------------|-------------|----------|
| SEAL,3X152 (Ref # 92093D) | 92093-0111 | 4 |
| COLLAR (Ref # 92143) | 92143-1962 | 1 |
| BOLT,6X18 (Ref # 92153) | 92153-0875 | 4 |
| BOLT,SOCKET,5X16 (Ref # 92153A) | 92153-1244 | 1 |
| BOLT,SOCKET,6X22 (Ref # 92153B) | 92153-1356 | 1 |
| BOLT,SOCKET,5X17.7 (Ref # 92154) | 92154-0105 | 8 |
| DAMPER (Ref # 92161) | 92161-0154 | 1 |
| CLAMP (Ref # 92171) | 92171-0391 | 2 |
| CLAMP (Ref # 92171A) | 92171-1539 | 1 |
| SCREW-PAN-CROS,5X25 (Ref # 92172) | 92172-0056 | 6 |
| SCREW,TAPPING,5X25 (Ref # 92172A) | 92172-0337 | 9 |
| SCREW,TAPPING,5X20 (Ref # 92172B) | 92172-0382 | 4 |
| TUBE,HEAD-ASV (Ref # 92192) | 92192-0033 | 2 |
| TUBE,7X10X500 (Ref # 92192A) | 92192-0156 | 1 |
| TUBE,BREATHER (Ref # 92192B) | 92192-0237 | 1 |
| TUBE,ASV-A/C (Ref # 92192C) | 92192-0527 | 1 |
| BOLT-FLANGED,6X14 (Ref # 130) | 130AA0614 | 1 |
| O RING (Ref # 671) | 671E2565 | 4 |