

2012 NINJA® ZX™ -10R PARTS DIAGRAM

Air Cleaner

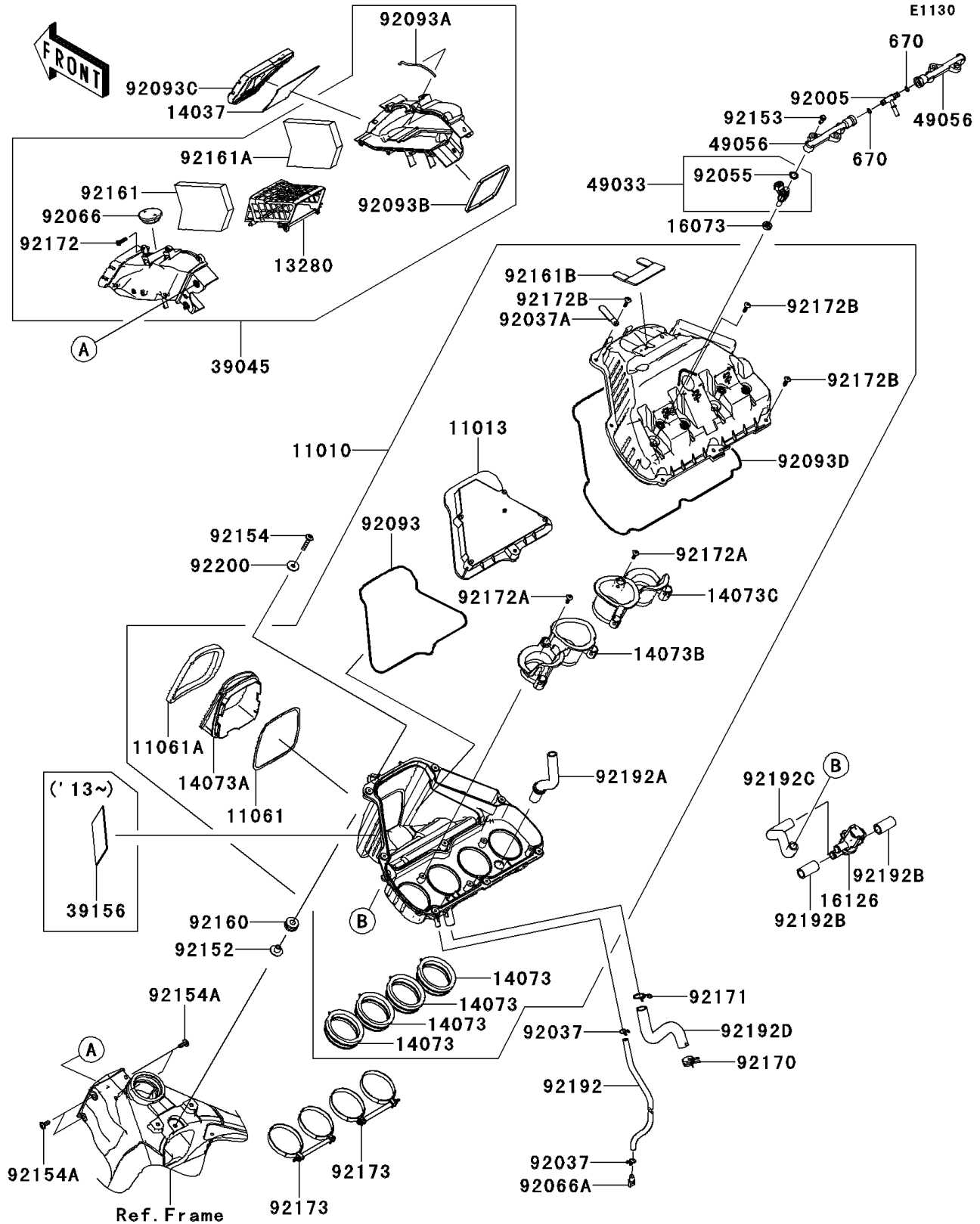

2012 NINJA® ZX™ -10R PARTS LIST

Air Cleaner

ITEM NAME	PART NUMBER	QUANTITY
FILTER-ASSY-AIR (Ref # 11010)	11010-0713	1
ELEMENT-AIR FILTER (Ref # 11013)	11013-0041	1
GASKET (Ref # 11061)	11061-0444	1
GASKET (Ref # 11061A)	11061-0445	1
HOLDER (Ref # 13280)	13280-0712	1
SCREEN (Ref # 14037)	14037-0107	1
DUCT,SUB FUNNEL (Ref # 14073)	14073-0294	4
DUCT (Ref # 14073A)	14073-0295	1
DUCT,FUNNEL,#1 (Ref # 14073B)	14073-0712	1
DUCT,FUNNEL,#3 (Ref # 14073C)	14073-0713	1
INSULATOR (Ref # 16073)	16073-0129	4
VALVE,AIR SWITCHING (Ref # 16126)	16126-0038	1
DUCT-ASSY (Ref # 39045)	39045-0056	1
NOZZLE-INJECTION (Ref # 49033)	49033-0027	4
PIPE-INJECTION (Ref # 49056)	49056-0032	2
FITTING (Ref # 92005)	92005-0125	1
CLAMP,TUBE (Ref # 92037)	92037-147	2
CLAMP,L=45 (Ref # 92037A)	92037-1539	1
RING-O,INJECTION NOZZLE (Ref # 92055)	92055-0124	4
PLUG (Ref # 92066)	92066-0717	1
PLUG,DRAIN (Ref # 92066A)	92066-1211	1
SEAL (Ref # 92093)	92093-0173	1
SEAL (Ref # 92093A)	92093-0175	1
SEAL (Ref # 92093B)	92093-0176	1
SEAL (Ref # 92093C)	92093-0177	1
SEAL (Ref # 92093D)	92093-0573	1
COLLAR,6.5X10.5X13.1 (Ref # 92152)	92152-0547	1
BOLT,FLANGED,5MM (Ref # 92153)	92153-0361	4
BOLT,SOCKET,6X30 (Ref # 92154)	92154-0435	1

2012 NINJA® ZX™ -10R PARTS LIST

Air Cleaner

ITEM NAME	PART NUMBER	QUANTITY
BOLT,FLANGE BUTTON,6X18 (Ref # 92154A)	92154-0996	4
DAMPER (Ref # 92160)	92160-1162	1
DAMPER (Ref # 92161)	92161-0973	1
DAMPER (Ref # 92161A)	92161-0974	1
DAMPER (Ref # 92161B)	92161-0984	1
CLAMP (Ref # 92170)	92170-1060	1
CLAMP (Ref # 92171)	92171-0391	1
SCREW,TAPPING,5X20 (Ref # 92172)	92172-0009	7
SCREW,TAPPING,5X16 (Ref # 92172A)	92172-0482	6
SCREW,TAPPING,5X20 (Ref # 92172B)	92172-0483	8
CLAMP (Ref # 92173)	92173-0224	2
TUBE,7X10X500 (Ref # 92192)	92192-0156	1
TUBE (Ref # 92192A)	92192-0886	1
TUBE,12X17.6X38 (Ref # 92192B)	92192-0887	2
TUBE,ASV-A/C (Ref # 92192C)	92192-0888	1
TUBE,BREATHER (Ref # 92192D)	92192-0889	1
WASHER,6.5X22X1.6 (Ref # 92200)	92200-1087	1
O RING,8MM (Ref # 670)	670E1508	2