

2000 Police 1000 PARTS DIAGRAM

Front Master Cylinder

F2291

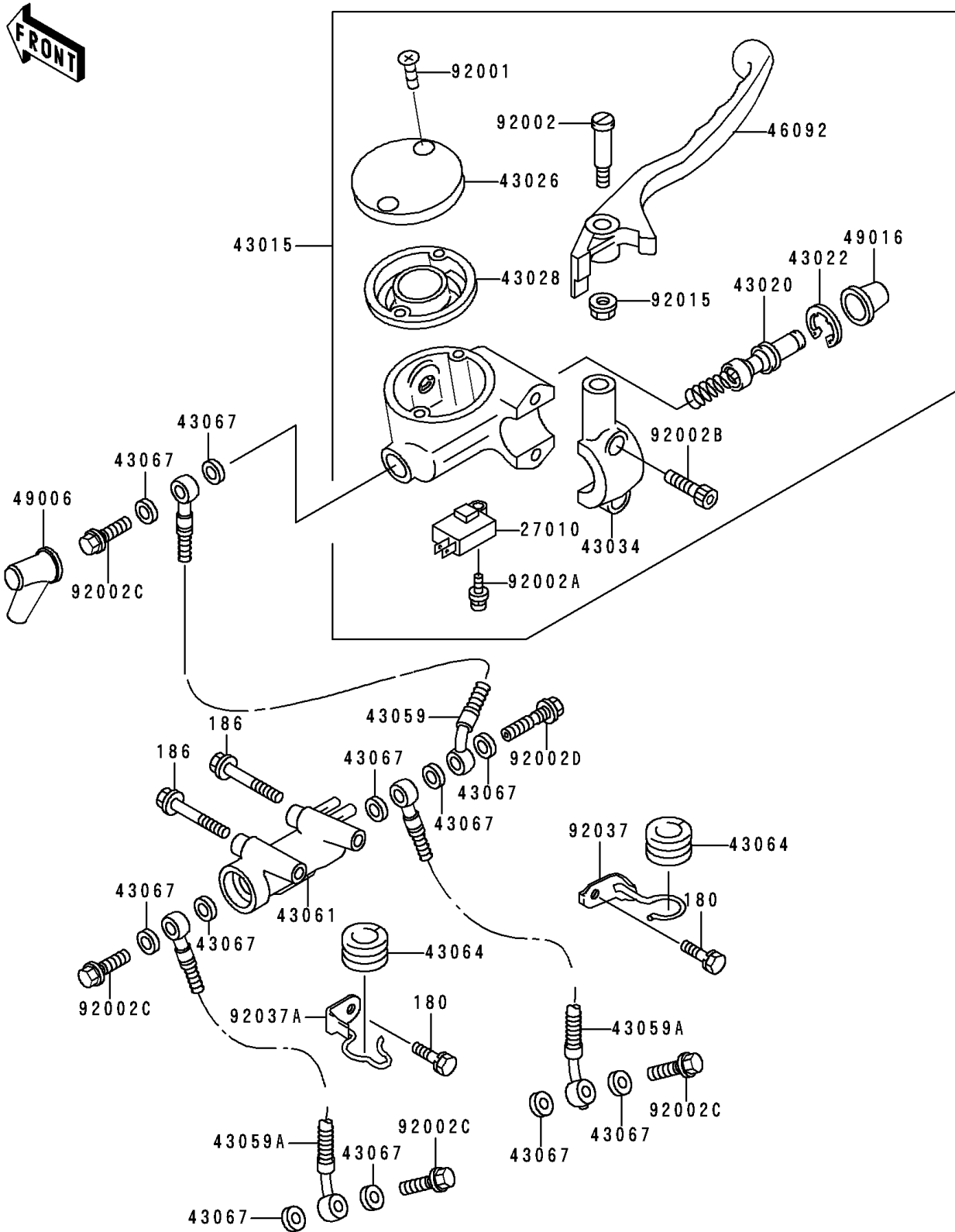

2000 Police 1000 PARTS LIST

Front Master Cylinder

| ITEM NAME | PART NUMBER | QUANTITY |
|--|-------------|----------|
| BOLT-UPSET-WS,6X12 (Ref # 180) | 180B0612 | 2 |
| BOLT-UPSET-WP (Ref # 186) | 186B0660 | 2 |
| SWITCH,BRAKE (Ref # 27010) | 27010-1170 | 1 |
| CYLINDER-ASSY-MASTER,FR (Ref # 43015) | 43015-1449 | 1 |
| PISTON-COMP-BRAKE,FR (Ref # 43020) | 43020-1054 | 1 |
| STOPPER-BRAKE,PISTON (Ref # 43022) | 43022-1010 | 1 |
| CAP-BRAKE (Ref # 43026) | 43026-1068 | 1 |
| DIAPHRAGM,MASTER CYLINDER (Ref # 43028) | 43028-1071 | 1 |
| HOLDER-BRAKE,MASTER CYLINDER (Ref # 43034) | 43034-1113 | 1 |
| HOSE-BRAKE,FR (Ref # 43059) | 43059-1784 | 1 |
| HOSE-BRAKE,FR (Ref # 43059A) | 43059-1785 | 2 |
| JOINT-BRAKE (Ref # 43061) | 43061-1004 | 1 |
| GROMMET,HOSE CLAMP (Ref # 43064) | 43064-006 | 2 |
| WASHER,10.5X15X1.5 (Ref # 43067) | 43067-001 | 11 |
| LEVER-GRIP,FRONT BRAKE (Ref # 46092) | 46092-1146 | 1 |
| BOOT,DUST (Ref # 49006) | 49006-1041 | 1 |
| COVER-SEAL,MASTER CYLINDER (Ref # 49016) | 49016-1044 | 1 |
| SCREW,5MM,BLACK (Ref # 92001) | 92001-1727 | 2 |
| BOLT,LEVER SET,BLACK (Ref # 92002) | 92002-1322 | 1 |
| BOLT,SCREW,4X12 (Ref # 92002A) | 92002-1323 | 1 |
| BOLT,SOCKET,6X20,BLACK (Ref # 92002B) | 92002-1324 | 2 |
| BOLT,OIL,L=23 (Ref # 92002C) | 92002-1888 | 4 |
| BOLT,OIL,L=37 (Ref # 92002D) | 92002-1909 | 1 |
| NUT,FLANGED,6MM,BLACK (Ref # 92015) | 92015-1233 | 1 |
| CLAMP,BRAKE HOSE (Ref # 92037) | 92037-1218 | 1 |
| CLAMP,BRAKE HOSE,LH (Ref # 92037A) | 92037-1367 | 1 |