

# 2001 Police 1000 PARTS DIAGRAM

Carburetor

E1611

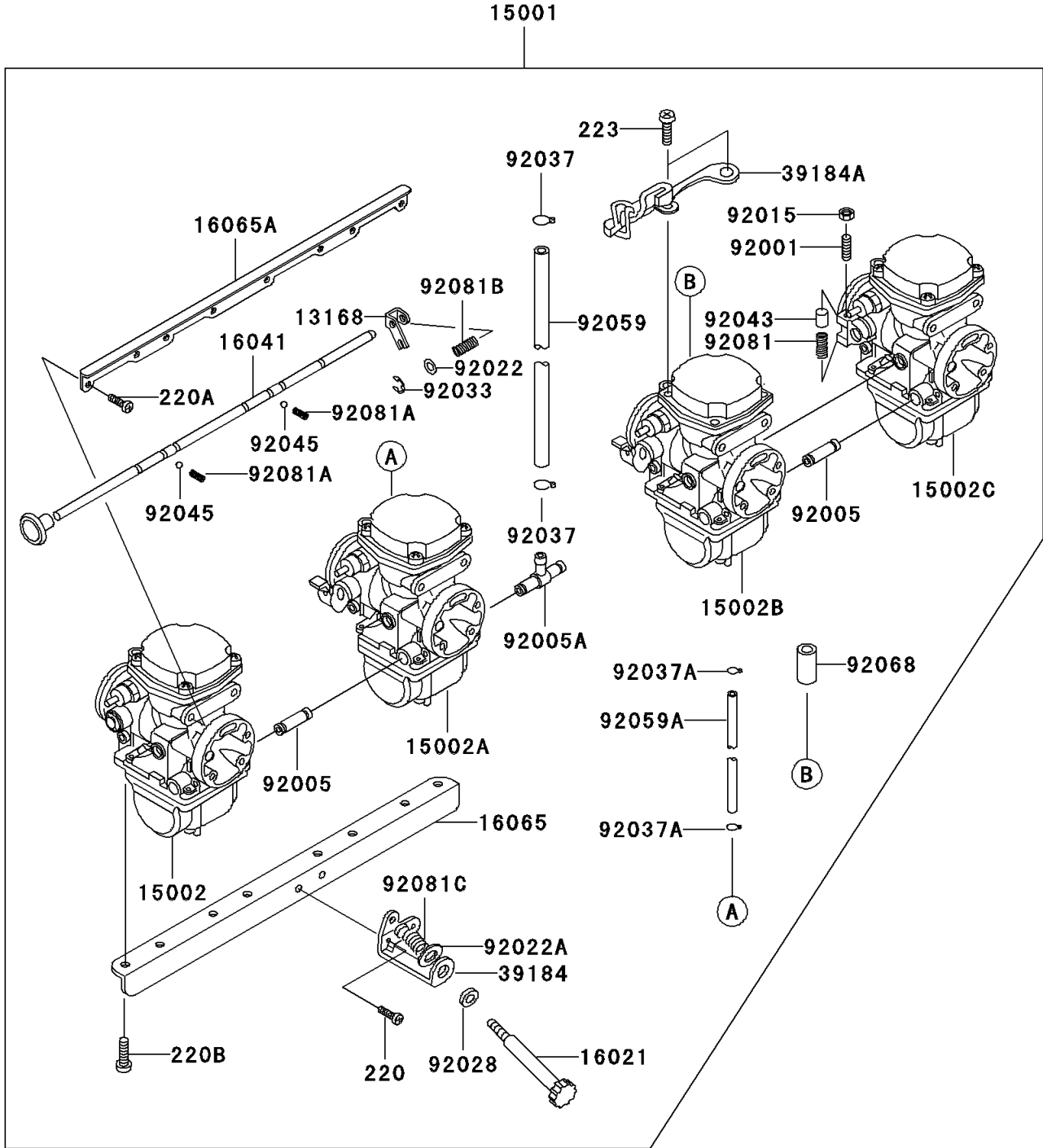

## 2001 Police 1000 PARTS LIST

### Carburetor

ITEM NAME	PART NUMBER	QUANTITY
SCREW-PAN-CROS,5X8 (Ref # 220)	220B0508	1
SCREW-PAN-CROS (Ref # 220A)	220B0510	8
SCREW-PAN-CROS,6X14 (Ref # 220B)	220B0614	8
SCREW-PAN-WS-CROS (Ref # 223)	223B0514	2
LEVER,CHOKE (Ref # 13168)	13168-1091	4
CARBURETOR-ASSY (Ref # 15001)	15001-1929	1
CARBURETOR,LH,OUTSIDE (Ref # 15002)	15002-1258	1
CARBURETOR,LH,INSIDE (Ref # 15002A)	15002-1259	1
CARBURETOR,RH,INSIDE (Ref # 15002B)	15002-1260	1
CARBURETOR,RH,OUTSIDE (Ref # 15002C)	15002-1261	1
SCREW-THROTTLE STOP (Ref # 16021)	16021-1103	1
SHAFT-CARBURETOR,CHOKE (Ref # 16041)	16041-1024	1
HOLDER-CARBURETOR,LWR (Ref # 16065)	16065-1043	1
HOLDER-CARBURETOR,UPP (Ref # 16065A)	16065-1044	1
BRACKET-ASSY,IDLING ADJUSTER (Ref # 39184)	39184-1007	1
BRACKET-ASSY,THROTTLE CABLE (Ref # 39184A)	39184-1013	1
BOLT,ADJUSTING (Ref # 92001)	92001-1447	3
FITTING,FUEL,I-TYPE (Ref # 92005)	92005-1035	2
FITTING,FUEL,T-TYPE (Ref # 92005A)	92005-1036	1
NUT,THROTTLE VALVE ADJUSTING (Ref # 92015)	92015-1119	3
WASHER,SPRING (Ref # 92022)	92022-1255	4
WASHER,THROTTLE STOP SCREW (Ref # 92022A)	92022-1491	1
BUSHING,IDLING ADJUSTER (Ref # 92028)	92028-1266	1
RING-SNAP,E-TYPE (Ref # 92033)	92033-1066	4
CLAMP,TUBE (Ref # 92037)	92037-1184	2
CLAMP,BREATHER TUBE (Ref # 92037A)	92037-174	2
PIN,THROTTLE VALVE ADJUST (Ref # 92043)	92043-1079	3
BALL-STEEL,1/8" (Ref # 92045)	92045-1044	2
TUBE,7.5X12.5X250 (Ref # 92059)	92059-1187	1

## 2001 Police 1000 PARTS LIST

### Carburetor

ITEM NAME	PART NUMBER	QUANTITY
TUBE,5X9X150 (Ref # 92059A)	92059-1188	1
PLUG,12X25 (Ref # 92068)	92068-006	1
SPRING,THROTTLE VALVE ADJUST (Ref # 92081)	92081-1259	3
SPRING,SHAFT STOP (Ref # 92081A)	92081-1260	2
SPRING,CHOKE SHAFT (Ref # 92081B)	92081-1364	4
SPRING,THROTTLE STOP SCREW (Ref # 92081C)	92081-1377	1