

# 1988 LTD PARTS DIAGRAM

Ignition Switch/Locks/Reflectors

F2770-0039

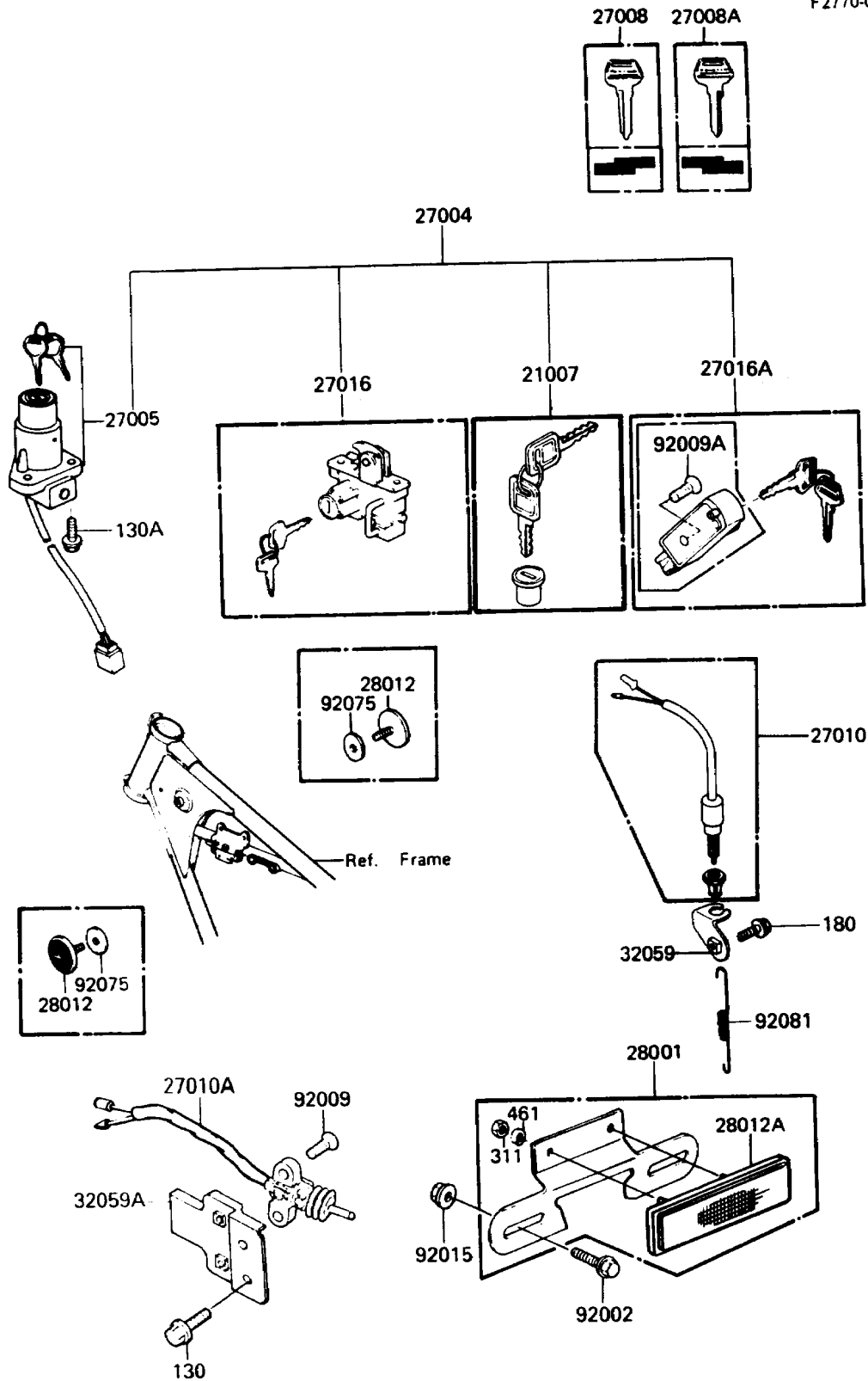

# 1988 LTD PARTS LIST

## Ignition Switch/Locks/Reflectors

ITEM NAME	PART NUMBER	QUANTITY
ROTOR,LOCK,TANK CAP (Ref # 21007)	21007-5022	1
SWITCH-ASSY (Ref # 27004)	27004-5323	1
SWITCH-ASSY-IGNITION (Ref # 27005)	27005-1029	1
KEY-LOCK,BLANK,#A (Ref # 27008)	27008-1034	1
KEY-LOCK,BLANK,#B (Ref # 27008A)	27008-1035	1
SWITCH,REAR BRAKE (Ref # 27010)	27010-1019	1
SWITCH,SIDE STAND (Ref # 27010A)	27010-1222	1
LOCK-ASSY,SEAT&HELMET (Ref # 27016)	27016-5028	1
LOCK-ASSY,HELMET (Ref # 27016A)	27016-5029	1
REFLECTOR-ASSY-REFLEX (Ref # 28001)	28001-1012	1
REFLECTOR-REFLEX,FR (Ref # 28012)	28012-016	2
REFLECTOR-REFLEX,RR (Ref # 28012A)	28012-1005	1
BRACKET-SWITCH,BRAKE LAMP (Ref # 32059)	32059-1006	1
BRACKET-SWITCH (Ref # 32059A)	32059-1085	1
BOLT,6X12 (Ref # 92002)	92002-1132	2
SCREW,5X20 (Ref # 92009)	92009-1459	2
SCREW,5X18 (Ref # 92009A)	92009-1547	2
NUT,FLANGED,6MM (Ref # 92015)	92015-1193	2
DAMPER,REFLECTOR (Ref # 92075)	92094-011	2
SPRING,BRAKE LAMP SWITCH (Ref # 92081)	27011-011	1
BOLT-FLANGED (Ref # 130)	130C0510	2
BOLT-FLANGED,6X14 (Ref # 130A)	130D0614	2
BOLT-UPSET-WS (Ref # 180)	180B0618	1
NUT-HEX (Ref # 311)	311B0500	2
WASHER-SPRING,5MM (Ref # 461)	461F0500	2