

2020 Z900 ABS PARTS DIAGRAM

Chassis Electrical Equipment

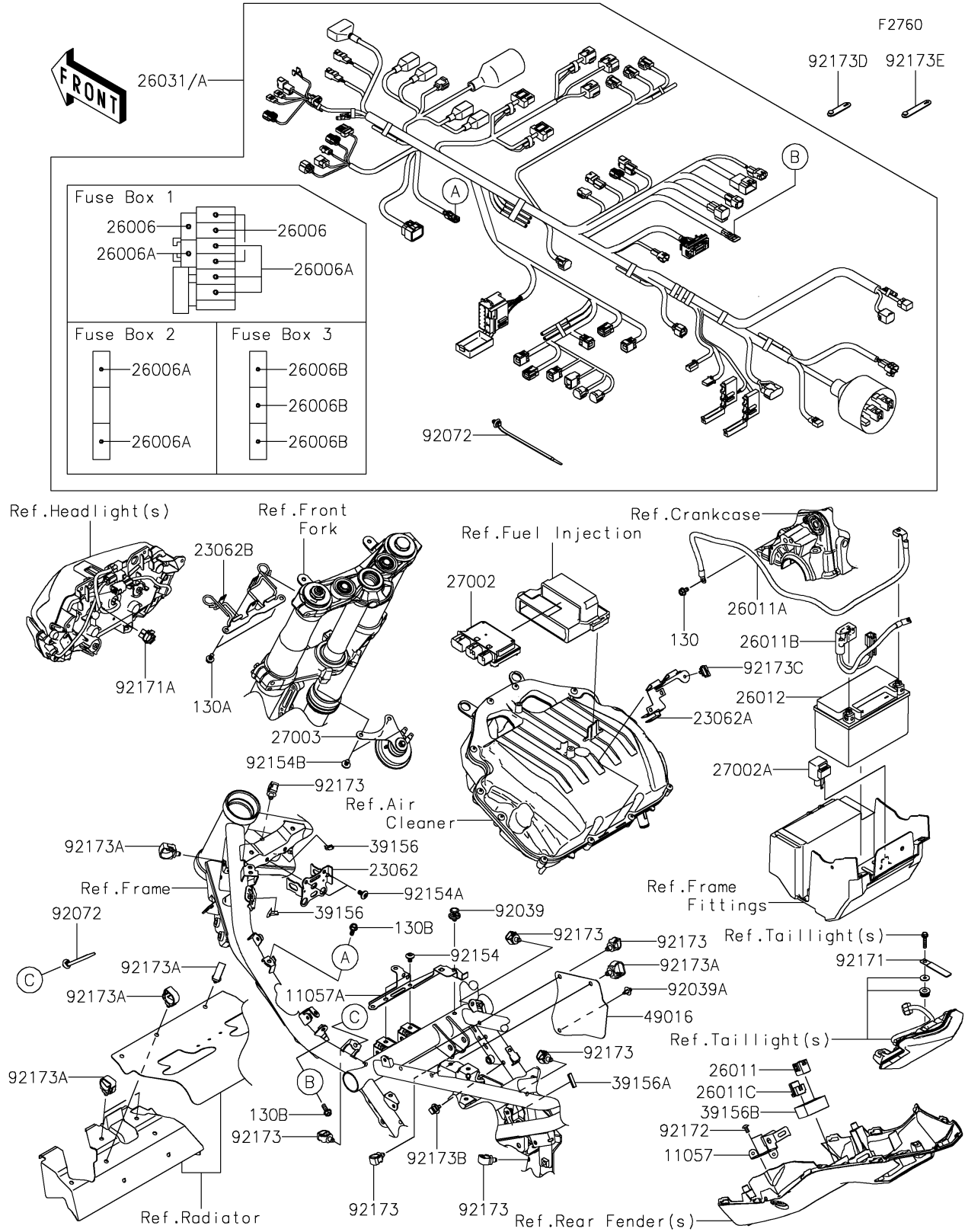

2020 Z900 ABS PARTS LIST

Chassis Electrical Equipment

ITEM NAME	PART NUMBER	QUANTITY
BRACKET,RELAY (Ref # 11057)	11057-0316	1
BRACKET,MAIN HARNESS (Ref # 11057A)	11057-2699	1
BRACKET-COMP,V.D. SENSOR (Ref # 23062)	23062-0894	1
BRACKET-COMP,A/C BOX (Ref # 23062A)	23062-1240	1
BRACKET-COMP,FORK UPPER HOLDER (Ref # 23062B)	23062-1261	1
FUSE,MINI BLADE,15A,BLUE (Ref # 26006)	26006-0001	4
FUSE,MINI BLADE,7.5A,BROWN (Ref # 26006A)	26006-0055	6
FUSE,MINI BLADE,30A,GREEN (Ref # 26006B)	26006-1080	3
WIRE-LEAD,CONNECTOR COVER (Ref # 26011)	26011-0275	1
WIRE-LEAD,BATTERY(-) (Ref # 26011A)	26011-0972	1
WIRE-LEAD,BATTERY(+) (Ref # 26011B)	26011-1888	1
WIRE-LEAD,DIAG CONNECTOR (Ref # 26011C)	26011-1901	1
BATTERY,FTX9-BS,12V 8AH (Ref # 26012)	26012-0608	1
HARNESS,MAIN (Ref # 26031)	26031-2852	1
HARNESS,MAIN (Ref # 26031A)	26031-2853	1
RELAY-ASSY (Ref # 27002)	27002-0042	1
RELAY-ASSY,SIGNAL LAMP (Ref # 27002A)	27002-1097	1
HORN (Ref # 27003)	27003-0121	1
PAD,20X20X1 (Ref # 39156)	39156-2288	2
PAD,28X17X1 (Ref # 39156A)	39156-2583	1
PAD,DIAG CONNECTOR (Ref # 39156B)	39156-2584	1
COVER-SEAL,ABS CONNECTOR (Ref # 49016)	49016-0679	1
RIVET,HOLE 8MM (Ref # 92039)	92039-0014	1
RIVET (Ref # 92039A)	92039-0015	1
BAND,OS170-FT7(BLACK) (Ref # 92072)	92072-1414	AR
BOLT,SOCKET,6X10 (Ref # 92154)	92154-0774	2
BOLT,SOCKET,6X12 (Ref # 92154A)	92154-2355	2
BOLT,SOCKET,6X10 (Ref # 92154B)	92154-2667	2
CLAMP,L=60 (Ref # 92171)	92171-0652	1

2020 Z900 ABS PARTS LIST

Chassis Electrical Equipment

ITEM NAME	PART NUMBER	QUANTITY
CLAMP,EDGE CLIP (Ref # 92171A)	92171-1722	1
SCREW,5X10 (Ref # 92172)	92172-0864	2
CLAMP,12MM DIA. (Ref # 92173)	92173-0736	7
CLAMP (Ref # 92173A)	92173-0861	6
CLAMP,CABLE CLIP (Ref # 92173B)	92173-1022	1
CLAMP,CLIP,TAIL LAMP,ETC (Ref # 92173C)	92173-1429	1
CLAMP (Ref # 92173D)	92173-2198	2
CLAMP (Ref # 92173E)	92173-2199	2
BOLT-FLANGED,6X10 (Ref # 130)	130BA0610	1
BOLT-FLANGED,6X12 (Ref # 130A)	130BA0612	2
BOLT-FLANGED,6X16 (Ref # 130B)	130BA0616	2