

1997 Vulcan 1500 PARTS DIAGRAM

Transmission(VN1500-A11/A12/A13)

E1361A

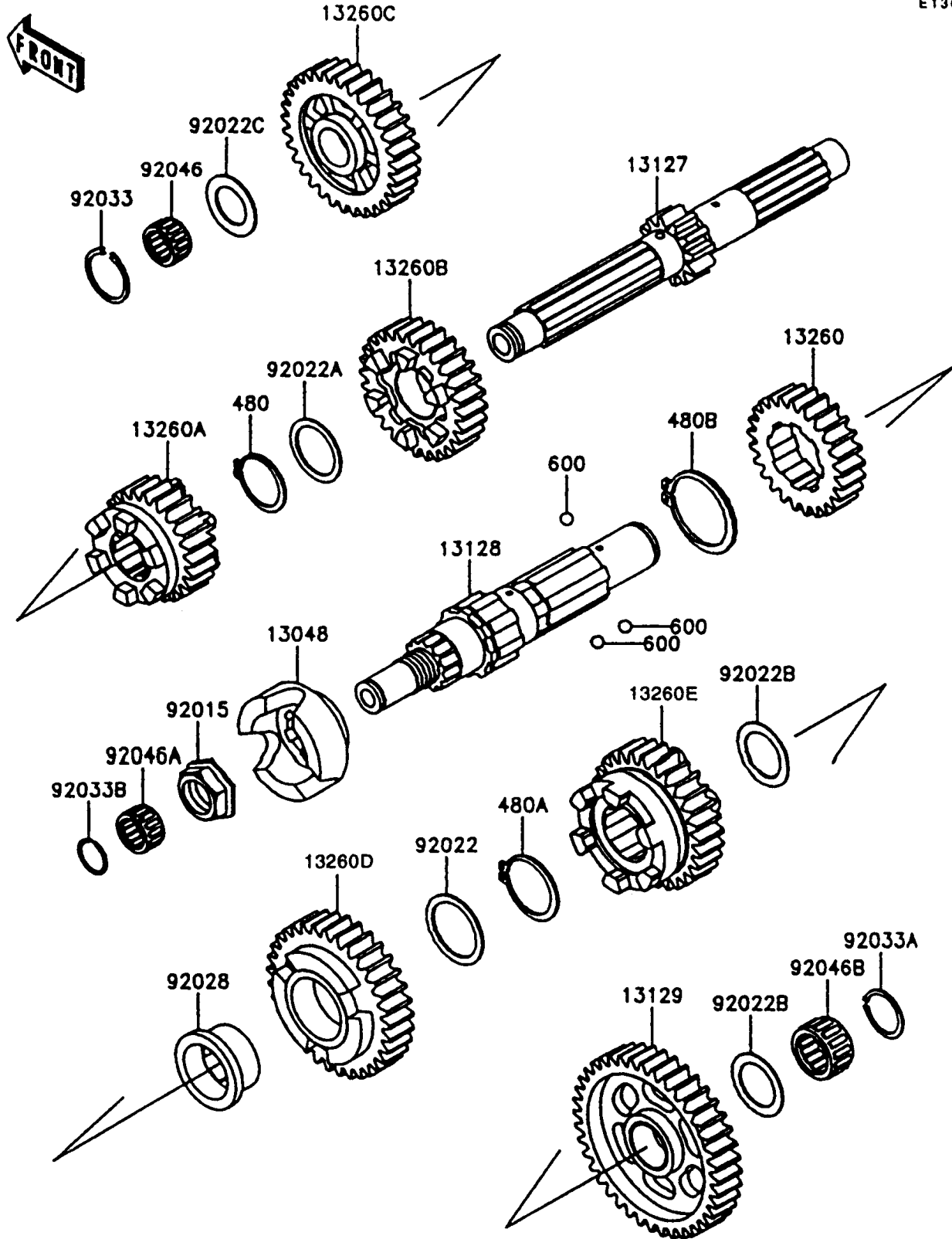

1997 Vulcan 1500 PARTS LIST

Transmission(VN1500-A11/A12/A13)

ITEM NAME	PART NUMBER	QUANTITY
CIRCLIP-TYPE-C,28MM (Ref # 480)	480J2800	1
CIRCLIP-TYPE-C,32MM (Ref # 480A)	480J3200	1
CIRCLIP (Ref # 480B)	480J4000	1
BALL-STEEL,5/32" (Ref # 600)	600A0500	3
CAM-DAMPER (Ref # 13048)	13048-1082	1
SHAFT-TRANSMISSION INPUT,16T (Ref # 13127)	13127-1155	1
SHAFT-TRANSMISSION OUTPUT (Ref # 13128)	13128-1144	1
GEAR,OUTPUT LOW,40T (Ref # 13129)	13129-1842	1
GEAR,OUTPUT 4TH,25T (Ref # 13260)	13260-1584	1
GEAR,INPUT 2ND,24T (Ref # 13260A)	13260-1586	1
GEAR,INPUT 3RD,28T (Ref # 13260B)	13260-1587	1
GEAR,INPUT 4TH,32T (Ref # 13260C)	13260-1588	1
GEAR,OUTPUT 2ND,33T (Ref # 13260D)	13260-1652	1
GEAR,OUTPUT 3RD,29T (Ref # 13260E)	13260-1653	1
NUT,20MM (Ref # 92015)	92015-1610	1
WASHER,32X40X1.6 (Ref # 92022)	92022-1693	1
WASHER,INPUT,3RD,LH (Ref # 92022A)	92022-1854	1
WASHER,OUTPUT,LOW (Ref # 92022B)	92022-1855	2
WASHER,22.3X35X1.6 (Ref # 92022C)	92022-212	1
BUSHING,OUTPUT,2ND (Ref # 92028)	92028-1478	1
RING-SNAP,20X25.5X1.2 (Ref # 92033)	92033-025	1
RING-SNAP,25MM (Ref # 92033A)	92033-1172	1
RING-SNAP (Ref # 92033B)	92033-1208	1
BEARING-NEEDLE,FWF-223014 (Ref # 92046)	92046-031	1
BEARING-NEEDLE,K182420V1 (Ref # 92046A)	92046-1154	1
BEARING-NEEDLE,RS25/18 (Ref # 92046B)	92046-1166	1