

1994 Vulcan 88 PARTS DIAGRAM

Camshaft(s)/Tensioner

E1230

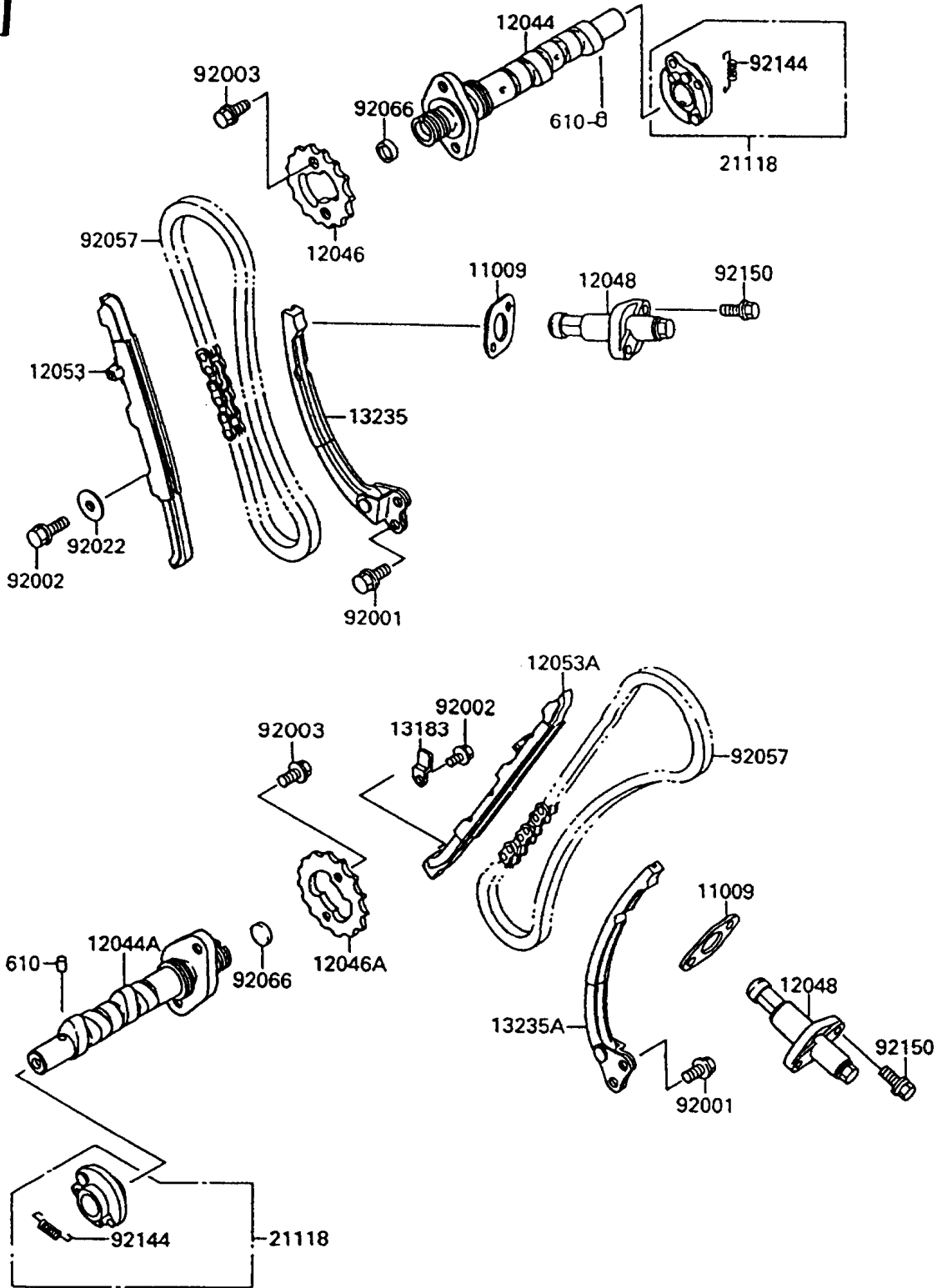

1994 Vulcan 88 PARTS LIST

Camshaft(s)/Tensioner

| ITEM NAME | PART NUMBER | QUANTITY |
|---|-------------|----------|
| ROLLER,4X6 (Ref # 610) | 610A0406 | 2 |
| GASKET,TENSIONER (Ref # 11009) | 11009-1858 | 2 |
| CAMSHAFT-VALVE,FR (Ref # 12044) | 12044-1200 | 1 |
| CAMSHAFT-VALVE,RR (Ref # 12044A) | 12044-1201 | 1 |
| SPROCKET,CAMSHAFT,FR (Ref # 12046) | 12046-1105 | 1 |
| SPROCKET,CAMSHAFT,RR (Ref # 12046A) | 12046-1106 | 1 |
| TENSIONER-ASSY (Ref # 12048) | 12048-1088 | 2 |
| GUIDE-CHAIN,FR,TENSIONER (Ref # 12053) | 12053-1219 | 1 |
| GUIDE-CHAIN,RR,TENSIONER (Ref # 12053A) | 12053-1221 | 1 |
| PLATE (Ref # 13183) | 13183-1096 | 1 |
| GUIDE-COMP (Ref # 13235) | 13235-1060 | 1 |
| GUIDE-COMP (Ref # 13235A) | 13235-1061 | 1 |
| DECOMPRESSOR (Ref # 21118) | 21118-1061 | 2 |
| BOLT,6X16 (Ref # 92001) | 92001-1457 | 4 |
| BOLT,6X12 (Ref # 92002) | 92002-1563 | 2 |
| BOLT,FLANGED,6X11 (Ref # 92003) | 92003-208 | 4 |
| WASHER,7X27X1.6 (Ref # 92022) | 92022-227 | 1 |
| CHAIN,CAM,82RH2010-144L (Ref # 92057) | 92057-1234 | 2 |
| PLUG (Ref # 92066) | 92066-1198 | 2 |
| SPRING,DECOMPRESSOR (Ref # 92144) | 92144-1209 | 2 |
| BOLT,6X20 (Ref # 92150) | 92150-1056 | 4 |