

2012 VERSYS® PARTS DIAGRAM

Front Fork

F2340

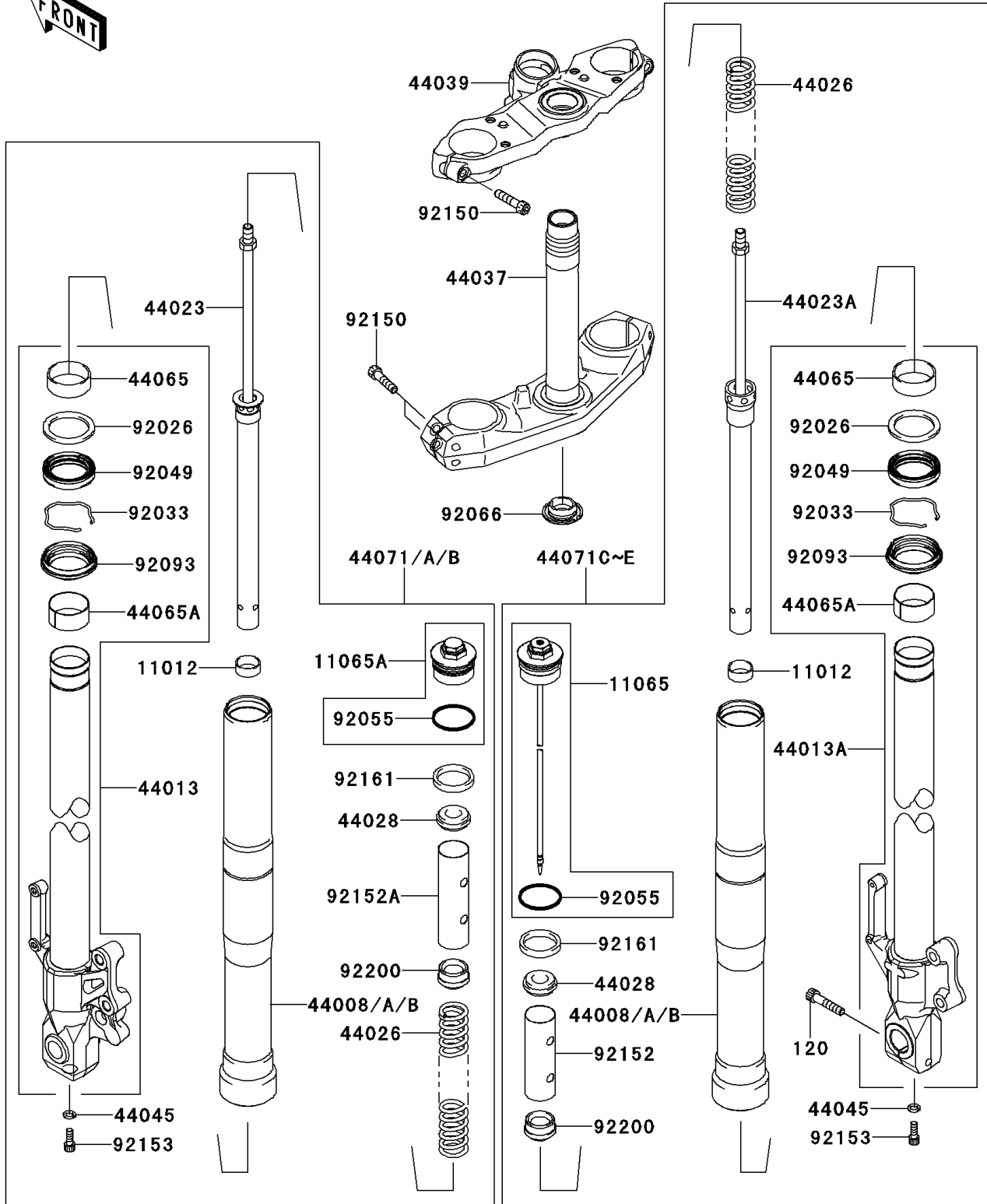

2012 VERSYS® PARTS LIST

Front Fork

| ITEM NAME | PART NUMBER | QUANTITY |
|---|----------------|----------|
| CAP (Ref # 11012) | 11012-1761 | 2 |
| CAP,FORK BOLT COMP,RH (Ref # 11065) | 11065-0196 | 1 |
| CAP,FORK BOLT COMP,LH (Ref # 11065A) | 11065-0197 | 1 |
| PIPE-FORK OUTER,SILVER (Ref # 44008) | 44008-0037-KX | 2 |
| PIPE-FORK INNER,LH,F.S.BLACK (Ref # 44013) | 44013-0156-18R | 1 |
| PIPE-FORK INNER,RH,F.S.BLACK (Ref # 44013A) | 44013-0157-18R | 1 |
| CYLINDER-SET-FORK,LH (Ref # 44023) | 44023-0048 | 1 |
| CYLINDER-SET-FORK,RH (Ref # 44023A) | 44023-0049 | 1 |
| SPRING-FRONT FORK (Ref # 44026) | 44026-0097 | 2 |
| GUIDE-FORK SPRING (Ref # 44028) | 44028-1083 | 2 |
| HOLDER-FORK UNDER (Ref # 44037) | 44037-0053 | 1 |
| HOLDER-FORK UPPER,P.SILVER (Ref # 44039) | 44039-0064-458 | 1 |
| GASKET,FORK CYLINDER BOLT (Ref # 44045) | 44045-051 | 2 |
| BUSHING-FRONT FORK,GUIDE (Ref # 44065) | 44065-0001 | 2 |
| BUSHING-FRONT FORK,SLIDE (Ref # 44065A) | 44065-0002 | 2 |
| DAMPER-ASSY,FORK,LH,SIL+BLK (Ref # 44071A) | 44071-0674-30G | 1 |
| DAMPER-ASSY,FORK,RH,SIL+BLK (Ref # 44071D) | 44071-0675-30G | 1 |
| SPACER,FORK OUTER (Ref # 92026) | 92026-1276 | 2 |
| RING-SNAP (Ref # 92033) | 92033-1222 | 2 |
| SEAL-OIL (Ref # 92049) | 92049-0058 | 2 |
| RING-O (Ref # 92055) | 92055-0131 | 2 |
| PLUG (Ref # 92066) | 92066-0032 | 1 |
| SEAL,DUST (Ref # 92093) | 92093-0035 | 2 |
| BOLT,SOCKET (Ref # 92150) | 92150-1511 | 6 |
| COLLAR,FORK,L=100 (Ref # 92152) | 92152-0497 | 1 |
| COLLAR,FORK,L=117.5 (Ref # 92152A) | 92152-0498 | 1 |
| BOLT,SOCKET,8X22 (Ref # 92153) | 92153-0028 | 2 |
| DAMPER (Ref # 92161) | 92161-0468 | 2 |
| WASHER (Ref # 92200) | 92200-1464 | 2 |

2012 VERSYS® PARTS LIST

Front Fork

| ITEM NAME | PART NUMBER | QUANTITY |
|------------------------------|-------------|----------|
| BOLT-SOCKET,8X40 (Ref # 120) | 120CB0840 | 1 |