

# 1992 Vulcan 88 PARTS DIAGRAM

Front Bevel Gear

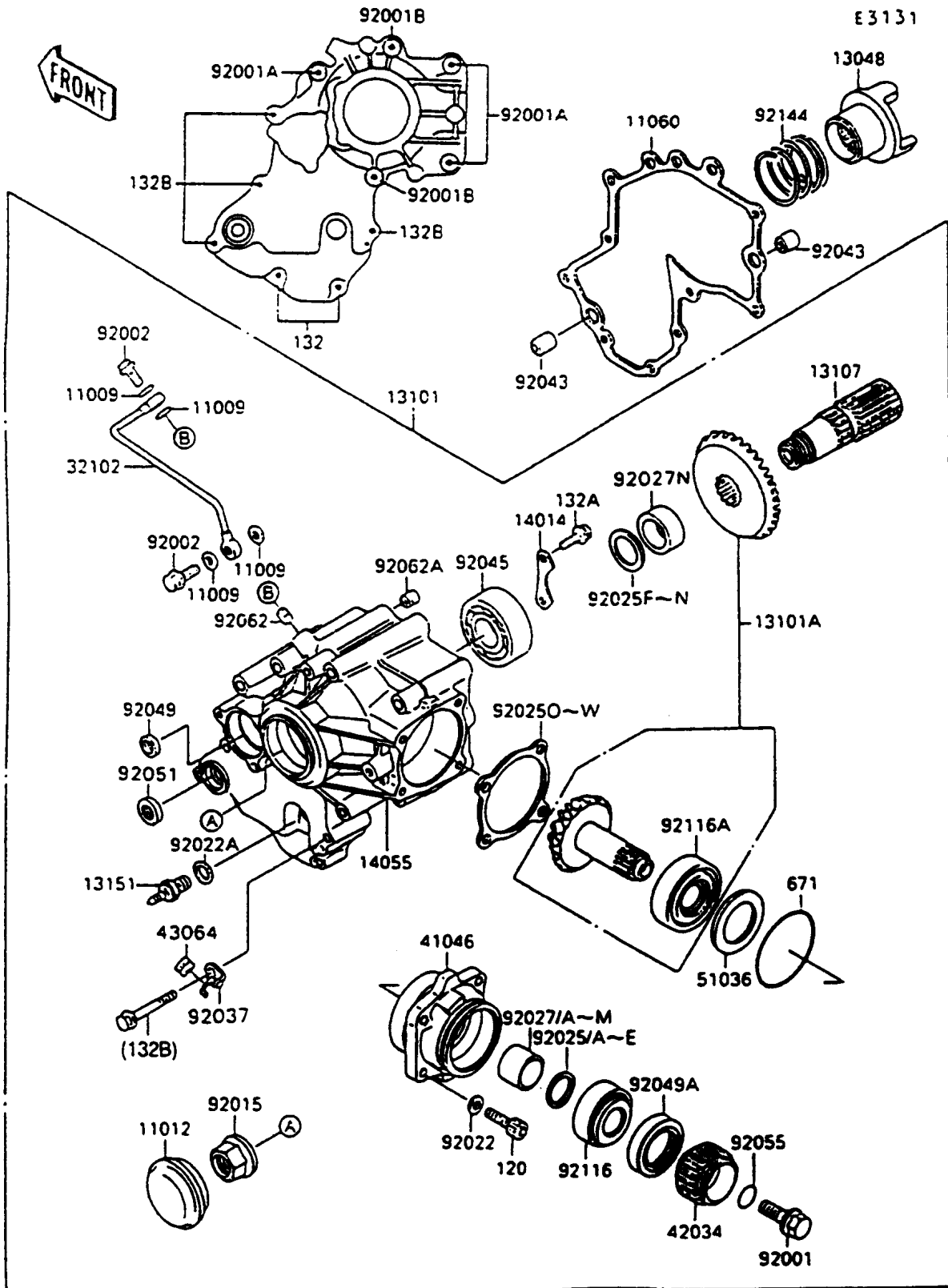

# 1992 Vulcan 88 PARTS LIST

## Front Bevel Gear

| ITEM NAME                                | PART NUMBER | QUANTITY |
|--|-------------|----------|
| GASKET,OIL PIPE,8.2X14X1.0 (Ref # 11009) | 11009-1344  | 4        |
| CAP (Ref # 11012)                        | 11012-1071  | 1        |
| GASKET,GEAR CASE (Ref # 11060)           | 11060-1120  | 1        |
| CAM-DAMPER (Ref # 13048)                 | 13048-1074  | 1        |
| GEAR-ASSY,BEVEL,FR (Ref # 13101)         | 13101-1118  | 1        |
| GEAR-ASSY,BEVEL,FR (Ref # 13101A)        | 13101-5065  | 1        |
| SHAFT,BEVEL,FR (Ref # 13107)             | 13107-1263  | 1        |
| SWITCH-COMP (Ref # 13151)                | 13151-1010  | 1        |
| PLATE-POSITION (Ref # 14014)             | 14014-1084  | 1        |
| CASE-GEAR (Ref # 14055)                  | 14055-1074  | 1        |
| PIPE (Ref # 32102)                       | 32102-1411  | 1        |
| HOUSING-BEARING (Ref # 41046)            | 41046-1085  | 1        |
| COUPLING,FR DRIVEN (Ref # 42034)         | 42034-1091  | 1        |
| GROMMET,HOSE CLAMP (Ref # 43064)         | 43064-006   | 1        |
| CUP (Ref # 51036)                        | 51036-1002  | 1        |
| BOLT,FLANGED,12X42 (Ref # 92001)         | 92001-1169  | 1        |
| BOLT,8X90 (Ref # 92001A)                 | 92001-1480  | 3        |
| BOLT,FLANGED,8X110 (Ref # 92001B)        | 92001-1597  | 2        |
| BOLT,BANJO,8X20 (Ref # 92002)            | 92002-1429  | 2        |
| NUT,24MM (Ref # 92015)                   | 92015-1554  | 1        |
| WASHER,8.5X13X1 (Ref # 92022)            | 92022-1028  | 4        |
| WASHER (Ref # 92022A)                    | 92022-1211  | 1        |
| SHIM,25.2X29.8X1.70 (Ref # 92025)        | 92025-1072  | AR       |
| SHIM,25.2X29.8X1.72 (Ref # 92025A)       | 92025-1073  | AR       |
| SHIM,25.2X29.8X1.74 (Ref # 92025B)       | 92025-1074  | AR       |
| SHIM,25.2X29.8X1.76 (Ref # 92025C)       | 92025-1075  | AR       |
| SHIM,25.2X29.8X1.78 (Ref # 92025D)       | 92025-1076  | AR       |
| SHIM,25.2X29.8X1.80 (Ref # 92025E)       | 92025-1077  | AR       |
| SHIM,25.3X36X0.15 (Ref # 92025F)         | 92025-1688  | AR       |

# 1992 Vulcan 88 PARTS LIST

## Front Bevel Gear

| ITEM NAME                            | PART NUMBER | QUANTITY |
|--------------------------------------|-------------|----------|
| SHIM,25.3X36X0.50 (Ref # 92025G)     | 92025-1689  | AR       |
| SHIM,25.3X36X0.60 (Ref # 92025H)     | 92025-1690  | AR       |
| SHIM,25.3X36X0.70 (Ref # 92025I)     | 92025-1691  | AR       |
| SHIM,25.3X36X0.80 (Ref # 92025J)     | 92025-1692  | AR       |
| SHIM,25.3X36X0.90 (Ref # 92025K)     | 92025-1693  | AR       |
| SHIM,25.3X36X1.00 (Ref # 92025L)     | 92025-1694  | AR       |
| SHIM,25.3X36X1.10 (Ref # 92025M)     | 92025-1695  | AR       |
| SHIM,25.3X36X1.20 (Ref # 92025N)     | 92025-1696  | AR       |
| SHIM,T=0.15 (Ref # 92025O)           | 92025-1818  | AR       |
| SHIM,T=0.50 (Ref # 92025P)           | 92025-1819  | AR       |
| SHIM,T=0.60 (Ref # 92025Q)           | 92025-1820  | AR       |
| BOLT-SOCKET,8X30 (Ref # 120)         | 120P0830    | 4        |
| BOLT-FLANGED-SMALL (Ref # 132)       | 132E0630    | 2        |
| BOLT-FLANGED-SMALL (Ref # 132A)      | 132G0616    | 2        |
| BOLT-FLANGED-SMALL (Ref # 132B)      | 132G0655    | 4        |
| O RING,65MM (Ref # 671)              | 671B2565    | 1        |
| SHIM,T=0.70 (Ref # 92025R)           | 92025-1821  | AR       |
| SHIM,T=0.80 (Ref # 92025S)           | 92025-1822  | AR       |
| SHIM,T=0.90 (Ref # 92025T)           | 92025-1823  | AR       |
| SHIM,T=1.00 (Ref # 92025U)           | 92025-1824  | AR       |
| SHIM,T=1.20 (Ref # 92025V)           | 92025-1825  | AR       |
| SHIM,T=0.10 (Ref # 92025W)           | 92025-1826  | AR       |
| COLLAR,25.2X29.8X22.8 (Ref # 92027)  | 92027-1152  | AR       |
| COLLAR,25.2X29.8X22.9 (Ref # 92027A) | 92027-1153  | AR       |
| COLLAR,25.2X29.8X23 (Ref # 92027B)   | 92027-1154  | AR       |
| COLLAR,25.2X29.8X23.1 (Ref # 92027C) | 92027-1155  | AR       |
| COLLAR,25.2X29.8X23.2 (Ref # 92027D) | 92027-1156  | AR       |
| COLLAR,25.2X29.8X23.3 (Ref # 92027E) | 92027-1157  | AR       |
| COLLAR,25.2X29.8X23.4 (Ref # 92027F) | 92027-1158  | AR       |

# 1992 Vulcan 88 PARTS LIST

## Front Bevel Gear

| ITEM NAME                                 | PART NUMBER | QUANTITY |
|---|-------------|----------|
| COLLAR,25.2X29.8X23.5 (Ref # 92027G)      | 92027-1159  | AR       |
| COLLAR,25.2X29.8X23.6 (Ref # 92027H)      | 92027-1160  | AR       |
| COLLAR,25.2X29.8X23.7 (Ref # 92027I)      | 92027-1161  | AR       |
| COLLAR,25.2X29.8X23.8 (Ref # 92027J)      | 92027-1162  | AR       |
| COLLAR,25.2X29.8X23.9 (Ref # 92027K)      | 92027-1163  | AR       |
| COLLAR,25.2X29.8X24 (Ref # 92027L)        | 92027-1164  | AR       |
| COLLAR,25.2X29.8X24.1 (Ref # 92027M)      | 92027-1165  | AR       |
| COLLAR,25.3X36X10 (Ref # 92027N)          | 92027-1968  | 1        |
| CLAMP (Ref # 92037)                       | 92037-1873  | 1        |
| PIN,11.5X14X14 (Ref # 92043)              | 92043-1279  | 2        |
| BEARING-BALL,6305C2 (Ref # 92045)         | 92045-1165  | 1        |
| SEAL-OIL,SD-8187 (Ref # 92049)            | 92049-1017  | 1        |
| SEAL-OIL,TC35527 (Ref # 92049A)           | 92049-1038  | 1        |
| SEAL-OIL,TB13225.5 (Ref # 92051)          | 92051-005   | 1        |
| RING-O,ID=18.64 (Ref # 92055)             | 92055-1044  | 1        |
| NOZZLE,6X8 (Ref # 92062)                  | 92062-1066  | 1        |
| NOZZLE,10X10 (Ref # 92062A)               | 92062-1067  | 1        |
| BEARING-ROLLER,HI-CAP30205 (Ref # 92116)  | 92116-1062  | 1        |
| BEARING-ROLLER,HI-CAP30305 (Ref # 92116A) | 92116-1063  | 1        |
| SPRING,CAM DAMPER (Ref # 92144)           | 92144-1193  | 1        |