

# 2016 Ninja® 650 ABS PARTS DIAGRAM

## Chassis Electrical Equipment

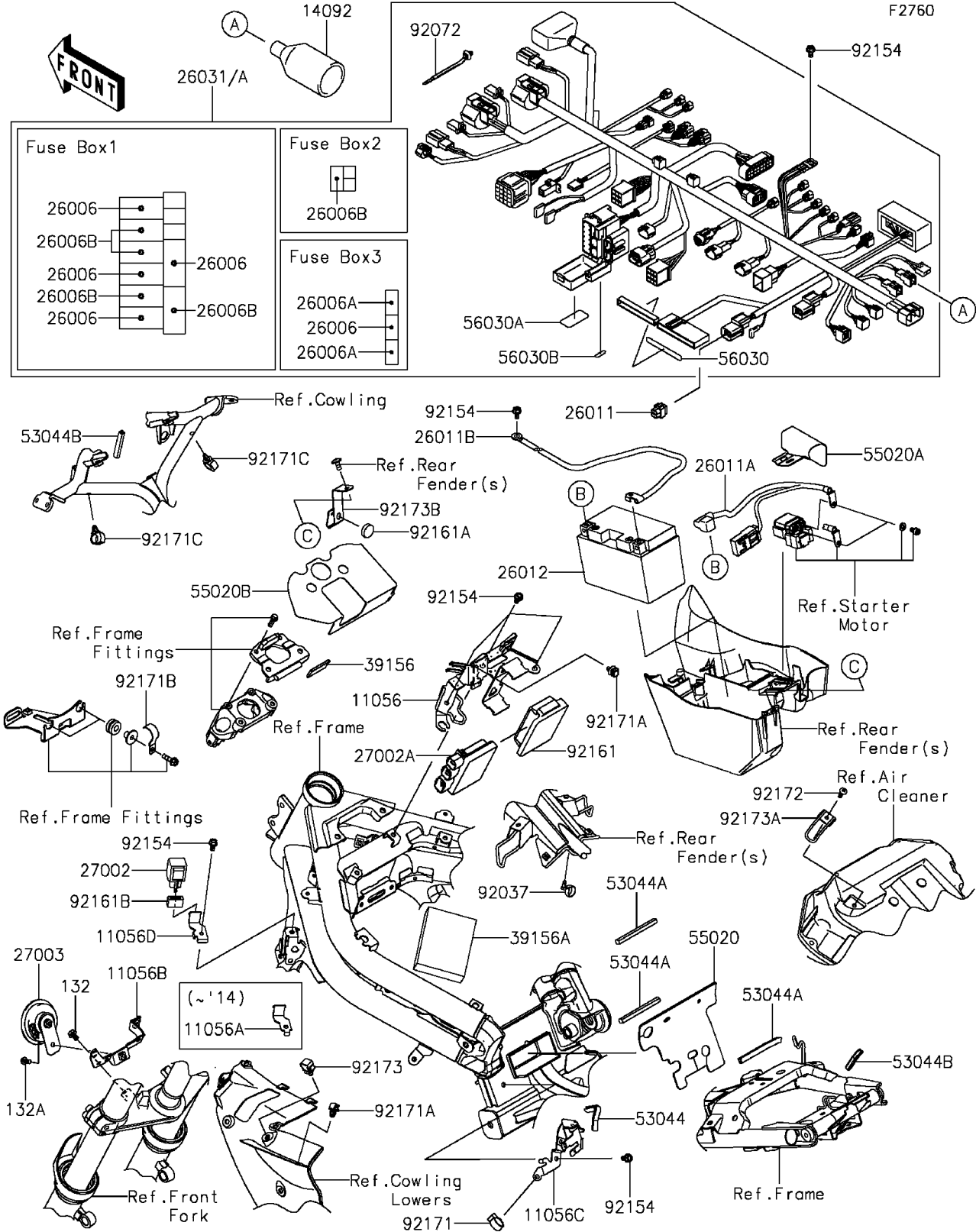

## 2016 Ninja® 650 ABS PARTS LIST

### Chassis Electrical Equipment

ITEM NAME	PART NUMBER	QUANTITY
BRACKET,RELAY-ASSY (Ref # 11056)	11056-0806	1
BRACKET,HORN (Ref # 11056B)	11056-1821	1
BRACKET,PIVOT,UPP,LH (Ref # 11056C)	11056-1888	1
BRACKET,SIGNAL RELAY (Ref # 11056D)	11056-3791	1
COVER (Ref # 14092)	14092-0902	1
FUSE,MINI BLADE,15A,BLUE (Ref # 26006)	26006-0001	5
FUSE,MINI BLADE,25A,NATURAL (Ref # 26006A)	26006-0020	2
FUSE,MINI BLADE,10A,RED (Ref # 26006B)	26006-1078	5
WIRE-LEAD,SENSOR CONNECTOR (Ref # 26011)	26011-0101	1
WIRE-LEAD,BATTERY(+) (Ref # 26011A)	26011-0710	1
WIRE-LEAD,BATTERY(-) (Ref # 26011B)	26011-0711	1
BATTERY,YT12A-BS,12V (Ref # 26012)	26012-0556	1
HARNESS,MAIN (Ref # 26031)	26031-1460	1
HARNESS,MAIN (Ref # 26031A)	26031-1462	1
RELAY-ASSY,SIGNAL LAMP (Ref # 27002)	27002-0006	1
RELAY-ASSY (Ref # 27002A)	27002-0007	1
HORN (Ref # 27003)	27003-0065	1
PAD,20X40X3 (Ref # 39156)	39156-0831	1
PAD,100X80X30 (Ref # 39156A)	39156-0872	1
TRIM (Ref # 53044)	53044-0018	1
TRIM,L=85 (Ref # 53044A)	53044-0556	3
TRIM,L=48 (Ref # 53044B)	53044-1324	2
GUARD,AIR CLEANER (Ref # 55020)	55020-0760	1
GUARD,MG. SWITCH (Ref # 55020A)	55020-0822	1
GUARD,FUSE BOX (Ref # 55020B)	55020-0826	1
LABEL,FUSE BOX3 (Ref # 56030)	56030-0400	1
LABEL,FUSE BOX1 (Ref # 56030A)	56030-0705	1
LABEL,FUSE BOX2 (Ref # 56030B)	56030-0706	1
CLAMP,SPEED,L=58 (Ref # 92037)	92037-1163	1

## 2016 Ninja® 650 ABS PARTS LIST

### Chassis Electrical Equipment

ITEM NAME	PART NUMBER	QUANTITY
BAND (Ref # 92072)	92072-1414	9
BOLT,FLANGED,6X12 (Ref # 92154)	92154-1050	7
DAMPER,RELAY BOX (Ref # 92161)	92161-0203	1
DAMPER (Ref # 92161A)	92161-0336	1
DAMPER,15X25X8.5 (Ref # 92161B)	92161-1443	1
CLAMP,BRAKE HOSE (Ref # 92171)	92171-0316	1
CLAMP (Ref # 92171A)	92171-0640	3
CLAMP,L=60 (Ref # 92171B)	92171-0652	2
CLAMP,13MM DIA. (Ref # 92171C)	92171-1415	2
SCREW,TAPPING,5X16 (Ref # 92172)	92172-0742	1
CLAMP,12MM DIA. (Ref # 92173)	92173-0736	2
CLAMP,AIR CLEANER (Ref # 92173A)	92173-0889	1
CLAMP (Ref # 92173B)	92173-0890	1
BOLT-FLANGED-SMALL,6X10 (Ref # 132)	132BA0610	2
BOLT-FLANGED-SMALL,6X12 (Ref # 132A)	132BB0612	1