

# 1993 Vulcan 88 PARTS DIAGRAM

Chassis Electrical Equipment

F2760

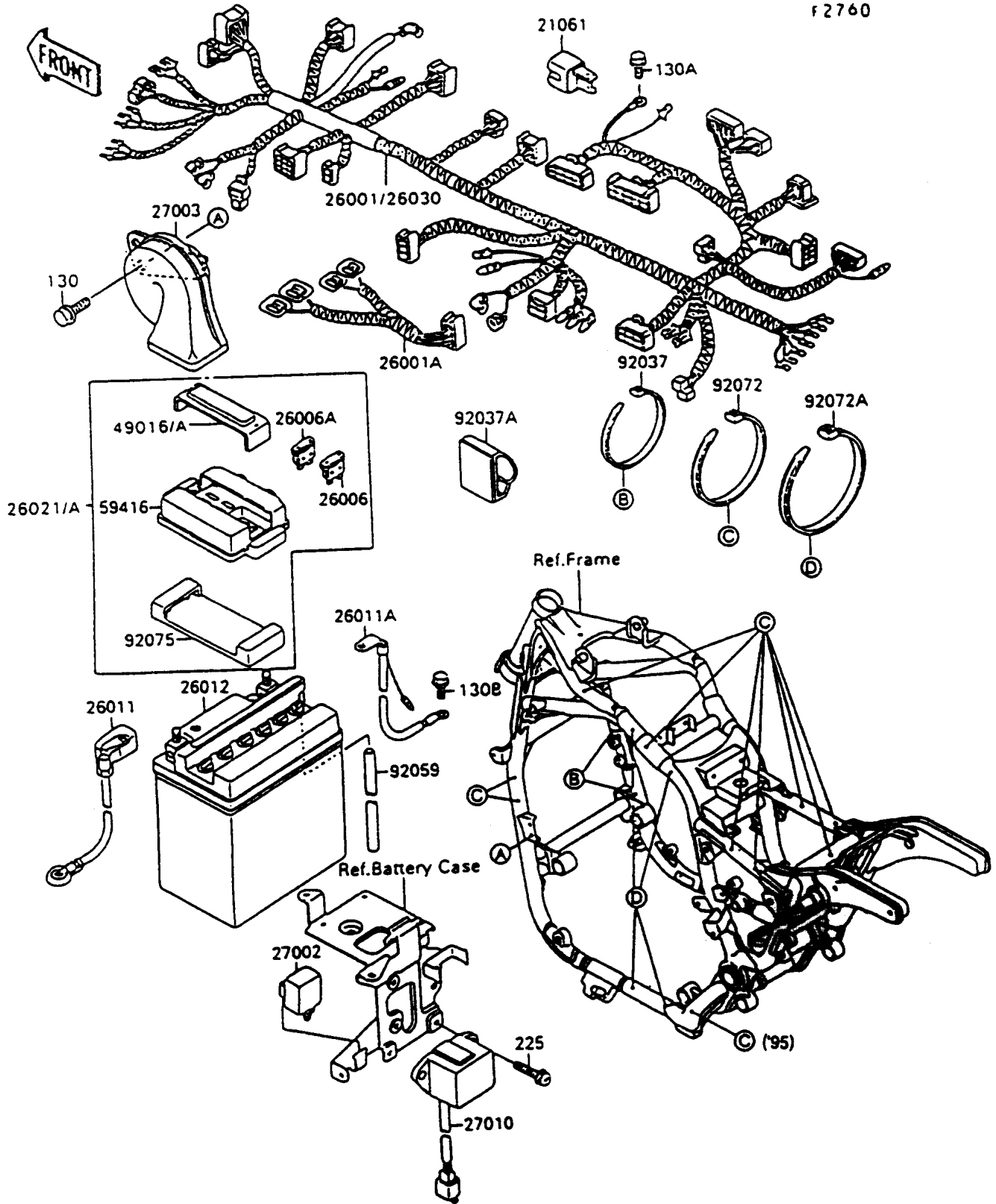

# 1993 Vulcan 88 PARTS LIST

## Chassis Electrical Equipment

| ITEM NAME                                 | PART NUMBER | QUANTITY |
|---|-------------|----------|
| BOLT-FLANGED,6X10,BLACK (Ref # 130)       | 130C0610    | 2        |
| BOLT-FLANGED (Ref # 130A)                 | 130J0610    | 1        |
| BOLT-FLANGED,6X10 (Ref # 130B)            | 130V0610    | 1        |
| SCREW-PAN-WSP-CROS (Ref # 225)            | 225B0620    | 2        |
| RECTIFIER (Ref # 21061)                   | 21061-1003  | 1        |
| HARNESS,MAIN (Ref # 26001)                | 26001-1831  | 1        |
| HARNESS,IGNITION (Ref # 26001A)           | 26001-1862  | 1        |
| FUSE,30A-G (Ref # 26006)                  | 26006-1067  | 1        |
| FUSE,10A-R (Ref # 26006A)                 | 26006-1068  | 5        |
| WIRE-LEAD,BATTERY(+) (Ref # 26011)        | 26011-1391  | 1        |
| WIRE-LEAD,BATTERY(-) (Ref # 26011A)       | 26011-1392  | 1        |
| BATTERY,12V 20AH,Y50-N18L-A (Ref # 26012) | 26012-1187  | 1        |
| JUNCTION BOX (Ref # 26021)                | 26021-1075  | 1        |
| RELAY-ASSY,TURN SIGNAL (Ref # 27002)      | 27002-1053  | 1        |
| HORN,LOW TONE (Ref # 27003)               | 27003-1264  | 1        |
| SWITCH,RESERVE LIGHTING (Ref # 27010)     | 27010-1069  | 1        |
| COVER-SEAL,FUSE (Ref # 49016)             | 49016-1125  | 1        |
| CASE-ELECTRIC,JUNCTION BOX (Ref # 59416)  | 59416-1065  | 1        |
| CLAMP,BAND,L=137 (Ref # 92037)            | 92037-1817  | 2        |
| CLAMP,WIRING HARNESS (Ref # 92037A)       | 92037-1954  | 2        |
| TUBE,5X8X570 (Ref # 92059)                | 92059-1840  | 1        |
| BAND,L=185 (Ref # 92072)                  | 92072-1195  | 9        |
| BAND,L=365 (Ref # 92072A)                 | 92072-1197  | 4        |
| DAMPER,JUNCTION BOX (Ref # 92075)         | 92075-1688  | 1        |