

# 2022 KLR® 650 PARTS DIAGRAM

Frame

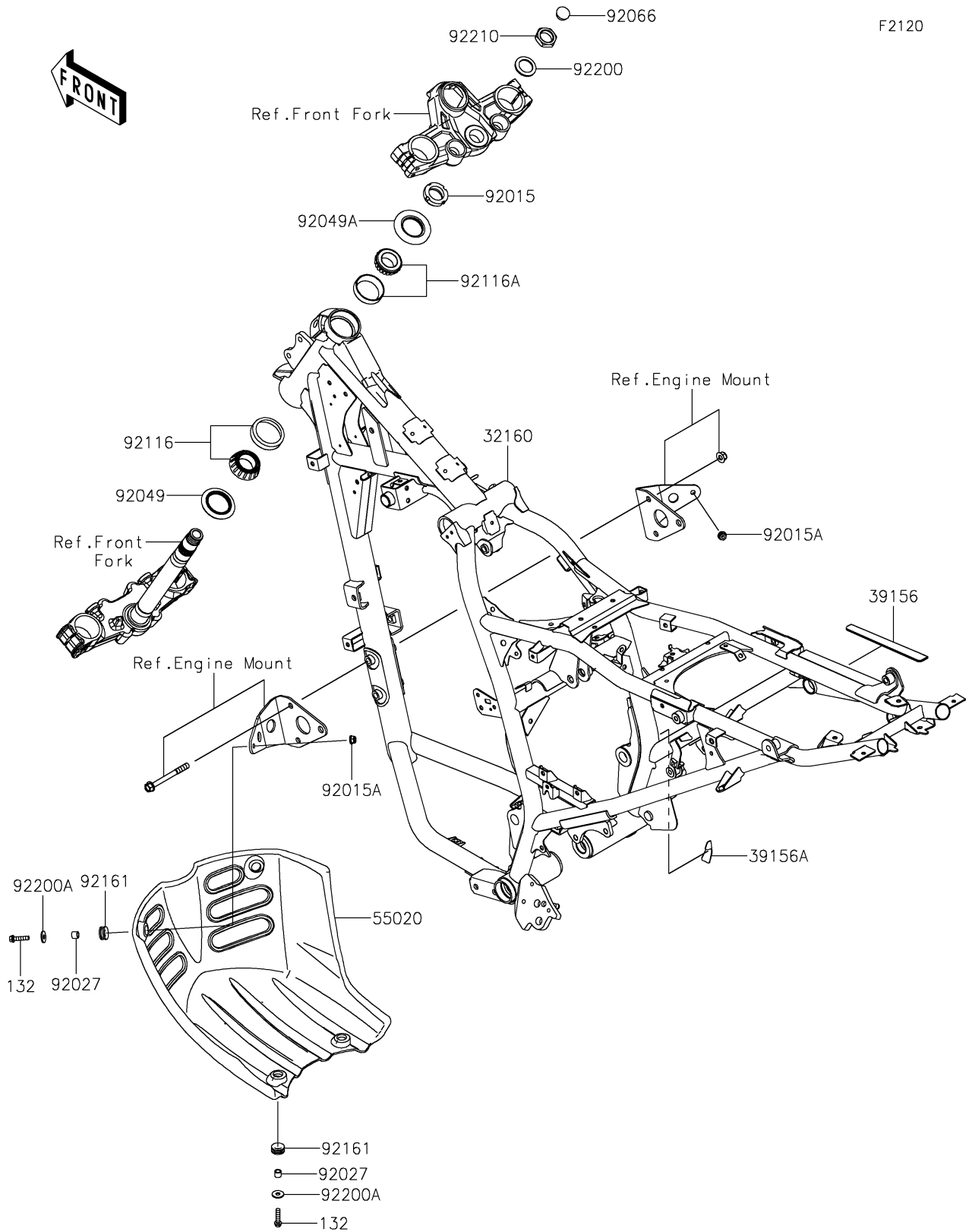

## 2022 KLR® 650 PARTS LIST

### Frame

ITEM NAME	PART NUMBER	QUANTITY
FRAME-COMP,F.S.BLACK (Ref # 32160)	32160-1906-18R	1
PAD,RH (Ref # 39156)	39156-2775	1
PAD (Ref # 39156A)	39156-2794	1
GUARD,ENGINE,F.BLACK (Ref # 55020)	55020-2372-6Z	1
NUT,25MM,T=12 (Ref # 92015)	92015-1546	1
NUT,LOCK,FLANGED,6MM (Ref # 92015A)	92015-1603	2
COLLAR,6.8X10X8.5 (Ref # 92027)	92027-129	4
SEAL-OIL,XMHE36X52X4J (Ref # 92049)	92049-1162	1
SEAL-OIL,STEERING STEM (Ref # 92049A)	92049-1214	1
PLUG (Ref # 92066)	92066-1306	1
BEARING-ROLLER,HR320/28XJ (Ref # 92116)	92116-1009	1
BEARING-ROLLER,HICAP 32005JR (Ref # 92116A)	92116-1052	1
DAMPER,10X20X8 (Ref # 92161)	92161-1828	4
WASHER,STEERING STEM (Ref # 92200)	92200-0517	1
WASHER,6.5X18X1.6 (Ref # 92200A)	92200-0766	4
NUT,STEERING STEM,22MM (Ref # 92210)	92210-1521	1
BOLT-FLANGED-SMALL,6X25 (Ref # 132)	132BB0625	4