

1999 Vulcan 1500 Nomad PARTS DIAGRAM

Saddlebags

F2873



| | |
|------------|---------------------|
| (57003/C) | Ebony |
| (57003A/D) | Boulogne/Green |
| (57003B/E) | C. A. Red/C. P. Red |
| (57003F/G) | Red |

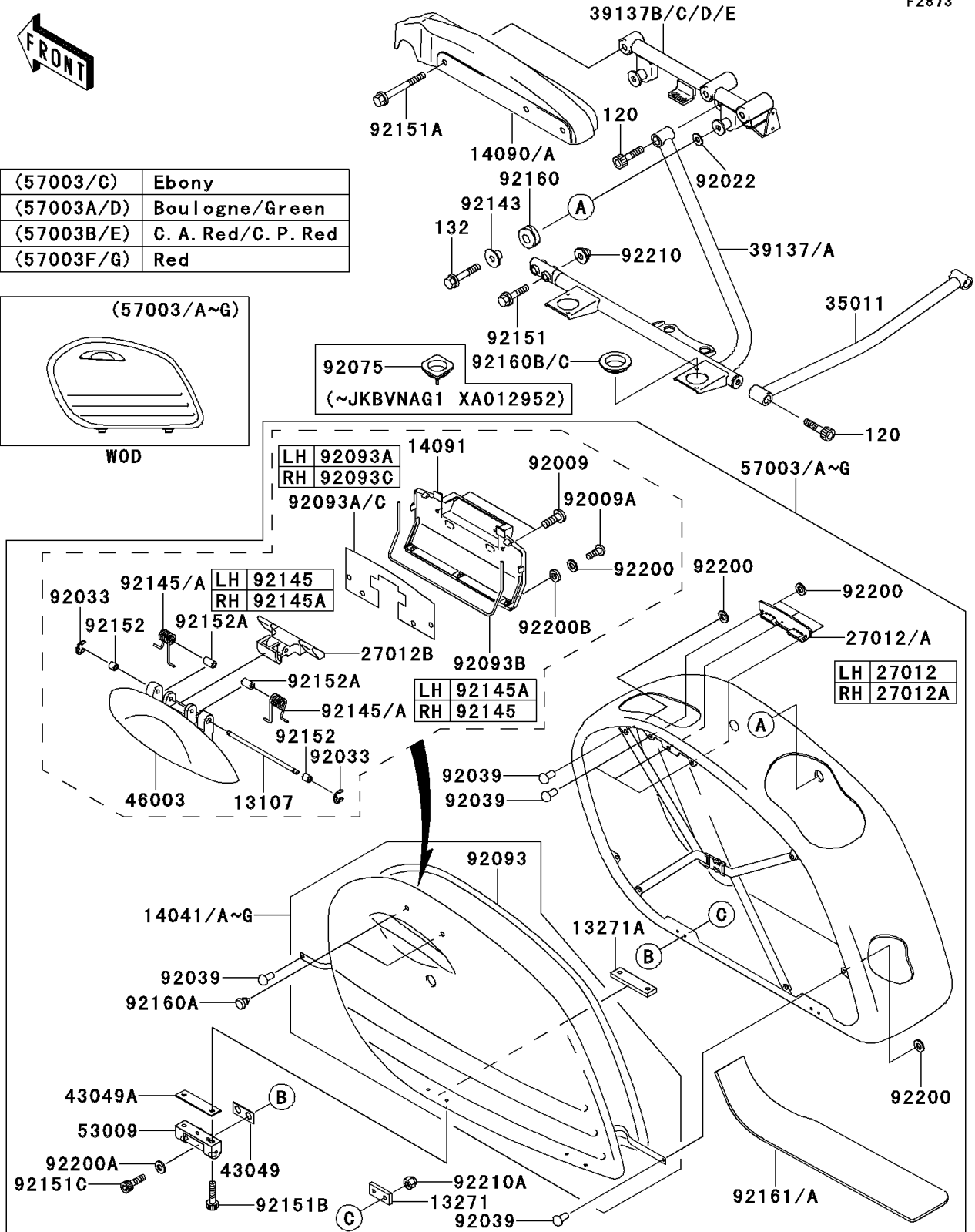
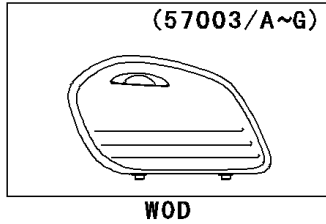

1999 Vulcan 1500 Nomad PARTS LIST

Saddlebags

| ITEM NAME | PART NUMBER | QUANTITY |
|---|---------------|----------|
| SHAFT (Ref # 13107) | 13107-1403 | 2 |
| PLATE (Ref # 13271) | 13271-1146 | 4 |
| PLATE (Ref # 13271A) | 13271-1147 | 4 |
| COVER-COMP,SIDE BAG,LH,RED (Ref # 14041) | 14041-1130-A5 | 1 |
| COVER-COMP,SIDE BAG,LH,GREEN (Ref # 14041C) | 14041-1130-81 | 1 |
| COVER-COMP,SIDE BAG,RH,RED (Ref # 14041D) | 14041-1131-A5 | 1 |
| COVER-COMP,SIDE BAG,RH,GREEN (Ref # 14041G) | 14041-1131-81 | 1 |
| COVER,RR FENDER,LH (Ref # 14090) | 14090-1894 | 1 |
| COVER,RR FENDER,RH (Ref # 14090A) | 14090-1895 | 1 |
| COVER,LID MAINTENANCE (Ref # 14091) | 14091-1069 | 2 |
| HOOK,LOCK PLATE,LH (Ref # 27012) | 27012-1571 | 1 |
| HOOK,LOCK PLATE,RH (Ref # 27012A) | 27012-1572 | 1 |
| HOOK,HANDLE (Ref # 27012B) | 27012-1575 | 2 |
| STAY,SIDE BAG (Ref # 35011) | 35011-1896 | 1 |
| STAY-COMP,SIDE BAG,LH,LWR (Ref # 39137) | 39137-1067 | 1 |
| STAY-COMP,SIDE BAG,RH,LWR (Ref # 39137A) | 39137-1068 | 1 |
| STAY-COMP,SIDE BAG,LH,UPP (Ref # 39137D) | 39137-1075 | 1 |
| STAY-COMP,SIDE BAG,RH,UPP (Ref # 39137E) | 39137-1076 | 1 |
| PACKING (Ref # 43049) | 43049-1084 | 4 |
| PACKING (Ref # 43049A) | 43049-1086 | 4 |
| HANDLE,SIDE BAG (Ref # 46003) | 46003-1505 | 2 |
| HINGE,SIDE BAG (Ref # 53009) | 53009-1104 | 4 |
| BAG-ASSY,LH,BOULOGNE+GREEN (Ref # 57003A) | 57003-1082-25 | 1 |
| BAG-ASSY,LH,RED MICA+RED (Ref # 57003B) | 57003-1082-28 | 1 |
| BAG-ASSY,RH,BOULOGNE+GREEN (Ref # 57003D) | 57003-1083-25 | 1 |
| BAG-ASSY,RH,RED MICA+RED (Ref # 57003E) | 57003-1083-28 | 1 |
| SCREW,TAPPING,4X12 (Ref # 92009) | 92009-1870 | 4 |
| SCREW,TAPPING,3X8 (Ref # 92009A) | 92009-1871 | 6 |
| WASHER,8.5X20X1.6,BLACK (Ref # 92022) | 92022-1317 | 4 |

1999 Vulcan 1500 Nomad PARTS LIST

Saddlebags

| ITEM NAME | PART NUMBER | QUANTITY |
|------------------------------------|-------------|----------|
| RING-SNAP (Ref # 92033) | 92033-1300 | 4 |
| BOLT-SOCKET,8X35,BLACK (Ref # 120) | 120S0835 | 4 |
| BOLT-FLANGED-SMALL (Ref # 132) | 132J0845 | 4 |
| RIVET (Ref # 92039) | 92039-1236 | 18 |
| SEAL,SIDE BAG COVER (Ref # 92093) | 92093-1486 | 2 |
| SEAL (Ref # 92093A) | 92093-1487 | 1 |
| SEAL (Ref # 92093B) | 92093-1488 | 2 |
| SEAL (Ref # 92093C) | 92093-1489 | 1 |
| COLLAR (Ref # 92143) | 92143-1450 | 4 |
| SPRING (Ref # 92145) | 92145-1175 | 2 |
| SPRING (Ref # 92145A) | 92145-1200 | 2 |
| BOLT,FLANGED,8X35 (Ref # 92151) | 92151-1402 | 4 |
| BOLT,FLANGED,8X75 (Ref # 92151A) | 92151-1403 | 6 |
| BOLT,SOCKET,4X22 (Ref # 92151B) | 92151-1436 | 8 |
| BOLT,SOCKET,4X18 (Ref # 92151C) | 92151-1437 | 8 |
| COLLAR (Ref # 92152) | 92152-1121 | 4 |
| COLLAR (Ref # 92152A) | 92152-1122 | 4 |
| DAMPER (Ref # 92160) | 92160-1012 | 4 |
| DAMPER (Ref # 92160A) | 92160-1976 | 4 |
| DAMPER (Ref # 92160B) | 92160-1981 | 4 |
| WASHER,3MM (Ref # 92200) | 92200-1442 | 24 |
| WASHER,4MM (Ref # 92200A) | 92200-1443 | 8 |
| WASHER,3MM (Ref # 92200B) | 92200-1444 | 6 |
| NUT,CAP,8MM (Ref # 92210) | 92210-1161 | 4 |
| NUT,CAP,4MM (Ref # 92210A) | 92210-1168 | 8 |