

# 2000 Vulcan 1500 Drifter PARTS DIAGRAM

Transmission

E1361

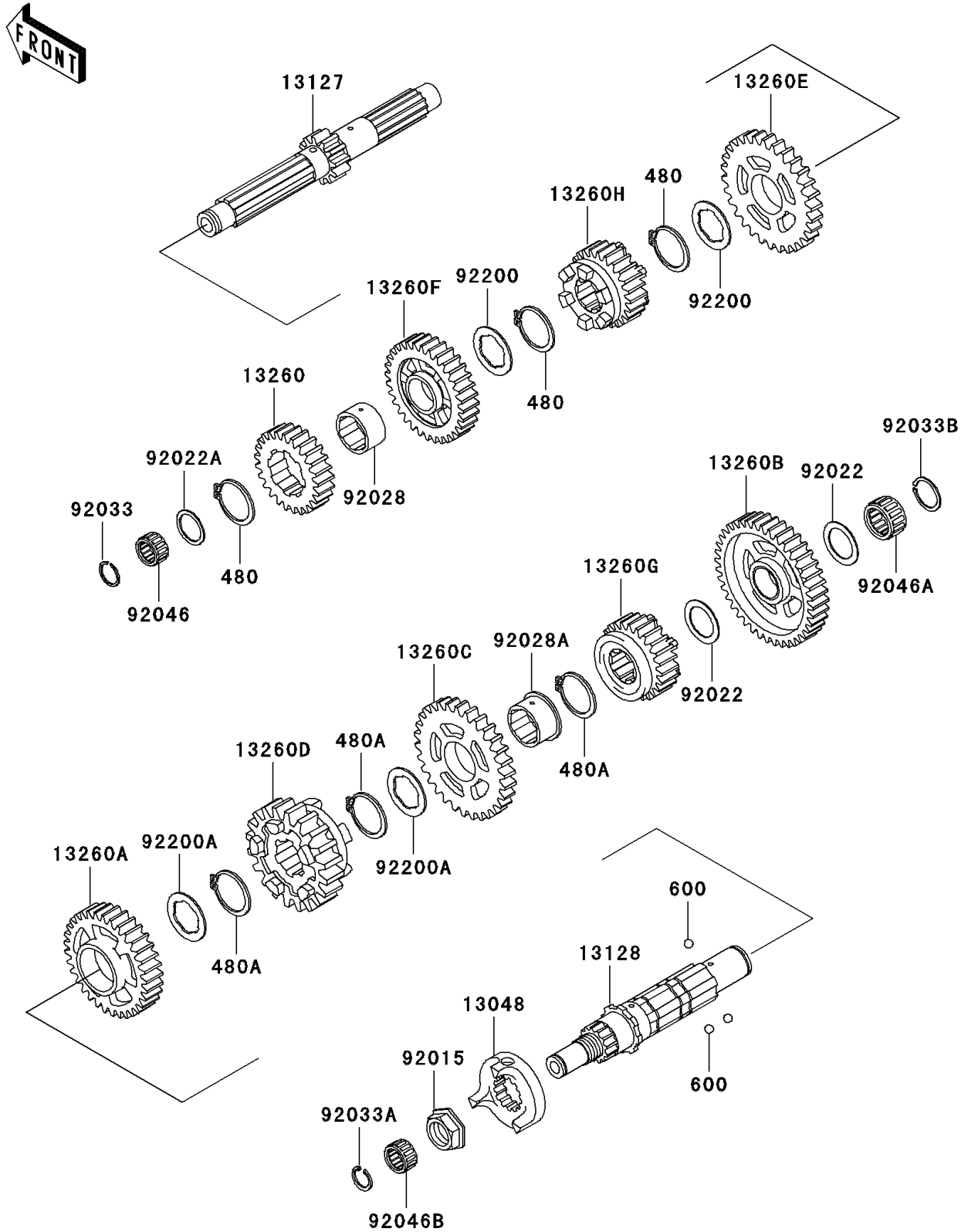

## 2000 Vulcan 1500 Drifter PARTS LIST

### Transmission

| ITEM NAME                                | PART NUMBER | QUANTITY |
|--|-------------|----------|
| CIRCLIP-TYPE-C,28MM (Ref # 480)          | 480J2800    | 3        |
| CIRCLIP (Ref # 480A)                     | 480J2900    | 3        |
| BALL-STEEL,5/32" (Ref # 600)             | 600A0500    | 3        |
| CAM-DAMPER (Ref # 13048)                 | 13048-1086  | 1        |
| SHAFT-TRANSMISSION INPUT (Ref # 13127)   | 13127-1260  | 1        |
| SHAFT-TRANSMISSION OUTPUT (Ref # 13128)  | 13128-1227  | 1        |
| GEAR,INPUT 2ND,22T (Ref # 13260)         | 13260-1695  | 1        |
| GEAR,OUTPUT 2ND,35T (Ref # 13260A)       | 13260-1700  | 1        |
| GEAR,OUTPUT LOW,40T (Ref # 13260B)       | 13260-1728  | 1        |
| GEAR,OUTPUT 3RD,31T (Ref # 13260C)       | 13260-1812  | 1        |
| GEAR,OUTPUT TOP,25T (Ref # 13260D)       | 13260-1813  | 1        |
| GEAR,INPUT 4TH,29T (Ref # 13260E)        | 13260-1814  | 1        |
| GEAR,INPUT TOP,32T (Ref # 13260F)        | 13260-1815  | 1        |
| GEAR,OUTPUT 4TH,28T (Ref # 13260G)       | 13260-1816  | 1        |
| GEAR,INPUT 3RD,26T (Ref # 13260H)        | 13260-1849  | 1        |
| NUT,20MM (Ref # 92015)                   | 92015-1610  | 1        |
| WASHER,OUTPUT,LOW (Ref # 92022)          | 92022-1855  | 2        |
| WASHER,22.3X35X1.6 (Ref # 92022A)        | 92022-212   | 1        |
| BUSHING,INPUT TOP GEAR (Ref # 92028)     | 92028-1752  | 1        |
| BUSHING,OUTPUT 3RD GEAR (Ref # 92028A)   | 92028-1831  | 1        |
| RING-SNAP,20X25.5X1.2 (Ref # 92033)      | 92033-025   | 1        |
| RING-SNAP (Ref # 92033A)                 | 92033-032   | 1        |
| RING-SNAP,25MM (Ref # 92033B)            | 92033-1172  | 1        |
| BEARING-NEEDLE,FWF-223014 (Ref # 92046)  | 92046-031   | 1        |
| BEARING-NEEDLE,TK253515 (Ref # 92046A)   | 92046-1259  | 1        |
| BEARING-NEEDLE,FWF-162222 (Ref # 92046B) | 92046-1260  | 1        |
| WASHER,T=1.5 (Ref # 92200)               | 92200-1240  | 2        |
| WASHER,30.3X40X1.5 (Ref # 92200A)        | 92200-1381  | 2        |