

2004 Vulcan 1500 Nomad Fi PARTS DIAGRAM

Clutch

E1350

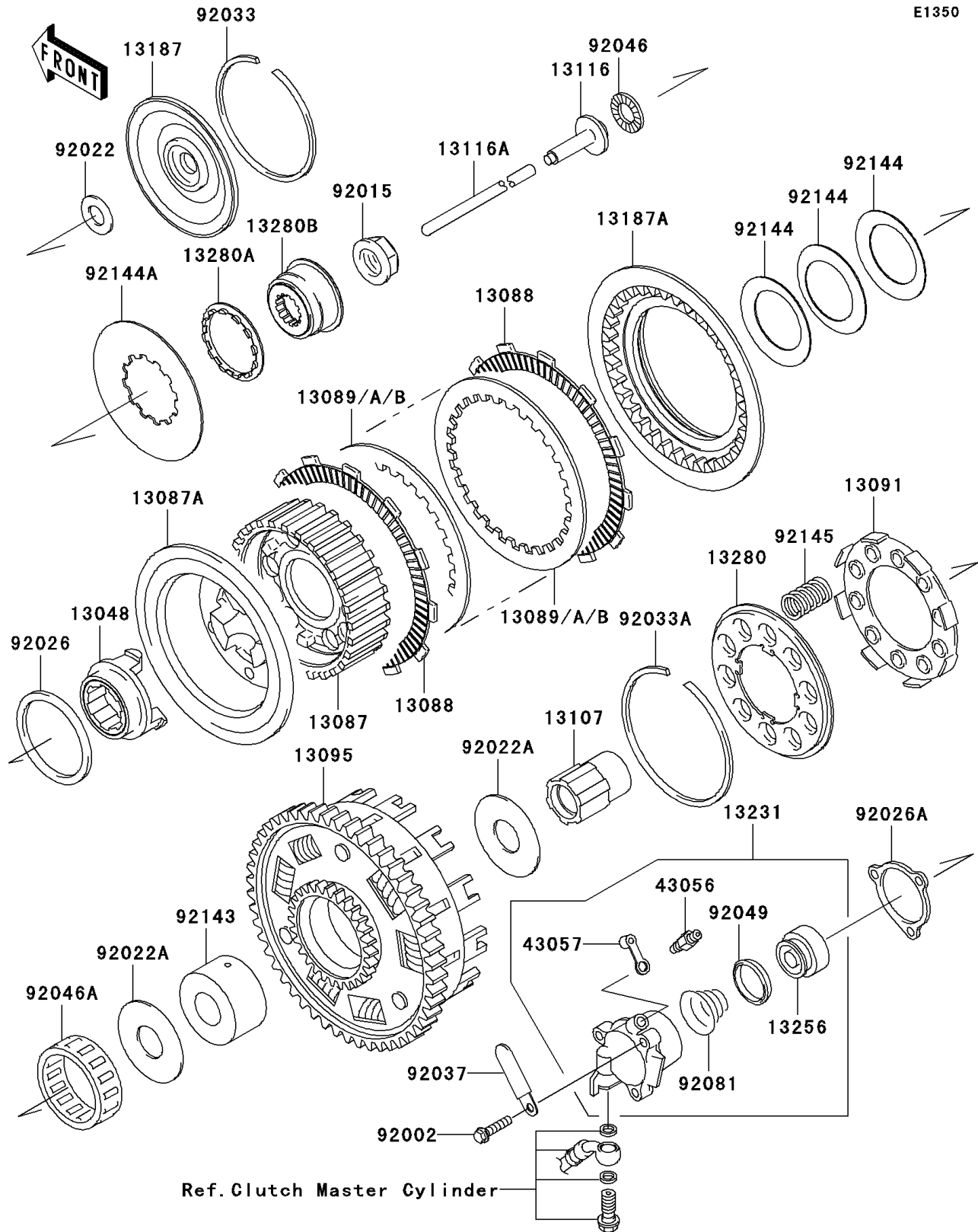

2004 Vulcan 1500 Nomad Fi PARTS LIST

Clutch

| ITEM NAME | PART NUMBER | QUANTITY |
|---------------------------------------|-------------|----------|
| CAM-DAMPER (Ref # 13048) | 13048-1087 | 1 |
| HUB-CLUTCH,OUTER (Ref # 13087) | 13087-1103 | 1 |
| HUB-CLUTCH,INNER (Ref # 13087A) | 13087-1110 | 1 |
| PLATE-FRICTION (Ref # 13088) | 13088-1146 | 8 |
| PLATE-CLUTCH,T=2.0 (Ref # 13089) | 13089-1075 | AR |
| PLATE-CLUTCH,T=1.6 (Ref # 13089A) | 13089-1080 | AR |
| PLATE-CLUTCH,T=2.3 (Ref # 13089B) | 13089-1081 | AR |
| HOLDER,DAMPER SPRING (Ref # 13091) | 13091-1495 | 1 |
| HOUSING-COMP-CLUTCH (Ref # 13095) | 13095-1395 | 1 |
| SHAFT,CLUTCH CAM DAMPER (Ref # 13107) | 13107-1237 | 1 |
| ROD-PUSH,CLUTCH (Ref # 13116) | 13116-1102 | 1 |
| ROD-PUSH (Ref # 13116A) | 13116-1132 | 1 |
| PLATE-CLUTCH OPERATING (Ref # 13187) | 13187-1063 | 1 |
| PLATE-CLUTCH OPERATING (Ref # 13187A) | 13187-1066 | 1 |
| RELEASE-ASSY-CLUTCH (Ref # 13231) | 13231-1071 | 1 |
| PISTON (Ref # 13256) | 13256-1052 | 1 |
| HOLDER,DAMPER SPRING (Ref # 13280) | 13280-1303 | 1 |
| HOLDER (Ref # 13280A) | 13280-1306 | 1 |
| HOLDER (Ref # 13280B) | 13280-1307 | 1 |
| BREATHER (Ref # 43056) | 43056-1055 | 1 |
| CAP-BREATHER (Ref # 43057) | 43057-1001 | 1 |
| BOLT,6X25 (Ref # 92002) | 92002-1612 | 3 |
| NUT,20MM (Ref # 92015) | 92015-1461 | 1 |
| WASHER,15.1X29X1.0 (Ref # 92022) | 92022-1463 | 1 |
| WASHER,25.3X56X2.0 (Ref # 92022A) | 92022-1857 | 2 |
| SPACER,59X70X3.5 (Ref # 92026) | 92026-1043 | 1 |
| SPACER,CLUTCH RELEASE (Ref # 92026A) | 92026-1263 | 1 |
| RING-SNAP (Ref # 92033) | 92033-1238 | 1 |
| RING-SNAP (Ref # 92033A) | 92033-1239 | 1 |

2004 Vulcan 1500 Nomad Fi PARTS LIST

Clutch

| ITEM NAME | PART NUMBER | QUANTITY |
|--------------------------------------|-------------|----------|
| CLAMP,L=45 (Ref # 92037) | 92037-1539 | 1 |
| BEARING-NEEDLE,AXK1102 (Ref # 92046) | 92046-1052 | 1 |
| BEARING-NEEDLE (Ref # 92046A) | 92046-1175 | 1 |
| SEAL-OIL,PISTON (Ref # 92049) | 92049-1165 | 1 |
| SPRING,CLUTCH RELEASE (Ref # 92081) | 92081-1644 | 1 |
| COLLAR,INPUT SHAFT (Ref # 92143) | 92143-1076 | 1 |
| SPRING,LIMITER (Ref # 92144) | 92144-1188 | 3 |
| SPRING,CLUTCH (Ref # 92144A) | 92144-1934 | 1 |
| SPRING (Ref # 92145) | 92145-1243 | 10 |