

2008 STX-15F PARTS DIAGRAM

Hull(A6F-A8F)

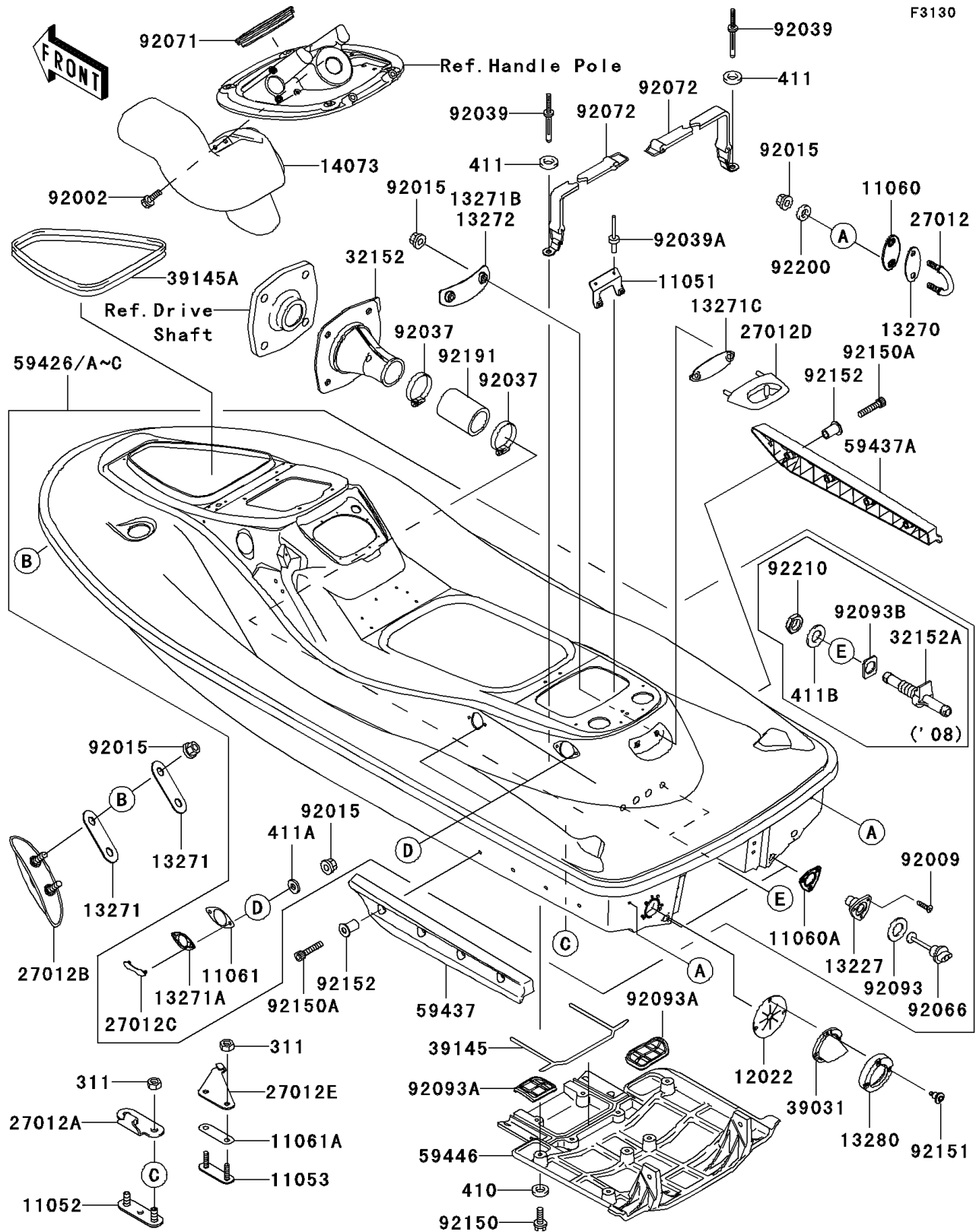

2008 STX-15F PARTS LIST

Hull(A6F-A8F)

ITEM NAME	PART NUMBER	QUANTITY
BRACKET,BREATHER-BILGE (Ref # 11051)	11051-3802	1
BRACKET,RR DUCT (Ref # 11052)	11052-3712	1
BRACKET (Ref # 11053)	11053-3746	1
GASKET,U HOOK,RR (Ref # 11060)	11060-3800	2
GASKET,DRAIN PLUG (Ref # 11060A)	11060-3801	2
GASKET,CARGO HOOK (Ref # 11061)	11061-3730	4
GASKET (Ref # 11061A)	11061-3731	1
VALVE-REED (Ref # 12022)	12022-3714	1
HOUSING,DRAIN PLUG,F.BLACK (Ref # 13227)	13227-3721-6Z	2
PLATE (Ref # 13270)	13270-3860	2
PLATE (Ref # 13271)	13271-3724	2
PLATE,CARGO NET HOOK (Ref # 13271A)	13271-3755	4
PLATE (Ref # 13271C)	13271-3889	1
PLATE,REAR TOWING HOOK (Ref # 13272)	13272-3702	1
HOLDER,EXHAUST VALVE (Ref # 13280)	13280-3718	1
DUCT (Ref # 14073)	14073-3801	1
HOOK (Ref # 27012)	27012-3797	2
HOOK (Ref # 27012A)	27012-3816	1
HOOK,BOW,F.BLACK (Ref # 27012B)	27012-3822-6Z	1
HOOK,CARGO NET,G.SILVER (Ref # 27012C)	27012-3828-F2	4
HOOK,REAR TOWING,F.BLACK (Ref # 27012D)	27012-3836-6Z	1
HOOK,WATER MUFFLER,RH (Ref # 27012E)	27012-3849	1
PIPE,DRIVE SHAFT (Ref # 32152)	32152-3703	1
PIPE (Ref # 32152A)	32152-3748	2
CAP-END (Ref # 39031)	39031-3708	1
TRIM-SEAL,JET PUMP COVER (Ref # 39145)	39145-3768	1
TRIM-SEAL,L=1412 (Ref # 39145A)	39145-3787	1
HULL-COMP,J.WHITE (Ref # 59426C)	59426-3968-8C	1
STABILIZER,LH,F.BLACK (Ref # 59437)	59437-3743-6Z	1

2008 STX-15F PARTS LIST

Hull(A6F-A8F)

ITEM NAME	PART NUMBER	QUANTITY
STABILIZER,RH,F.BLACK (Ref # 59437A)	59437-3744-6Z	1
COVER-JET PUMP (Ref # 59446)	59446-3758	1
BOLT,6X20 (Ref # 92002)	92002-3755	2
SCREW,TAPPING,4X16 (Ref # 92009)	92009-3849	6
NUT,FLANGED,8MM (Ref # 92015)	92015-3709	16
CLAMP (Ref # 92037)	92037-3009	2
RIVET (Ref # 92039)	92039-3741	2
RIVET (Ref # 92039A)	92039-3755	2
PLUG,RR,DRAIN,F.BLACK (Ref # 92066)	92066-3783-6Z	2
GROMMET (Ref # 92071)	92071-3812	1
BAND,314X18 (Ref # 92072)	92072-3814	2
SEAL (Ref # 92093)	92093-3720	2
SEAL (Ref # 92093A)	92093-3765	2
SEAL (Ref # 92093B)	92093-3783	2
BOLT,SOCKET,6X18 (Ref # 92150)	92150-3775	10
BOLT,SOCKET,6X30 (Ref # 92150A)	92150-3822	8
BOLT,SOCKET,M6,SHOULDER (Ref # 92151)	92151-3746	3
COLLAR (Ref # 92152)	92152-3715	8
TUBE,39X51X90 (Ref # 92191)	92191-3744	1
WASHER (Ref # 92200)	92200-3779	4
NUT (Ref # 92210)	92210-3707	2
NUT-HEX,6MM (Ref # 311)	311R0600	4
WASHER-PLAIN-SMALL,6MM (Ref # 410)	410S0600	10
WASHER-PLAIN,5MM (Ref # 411)	411S0500	2
WASHER-PLAIN,8MM (Ref # 411A)	411S0800	8
WASHER-PLAIN (Ref # 411B)	411S1600	2