

# 2005 Vulcan 1600 Mean Streak PARTS DIAGRAM

Muffler(s)

E1140

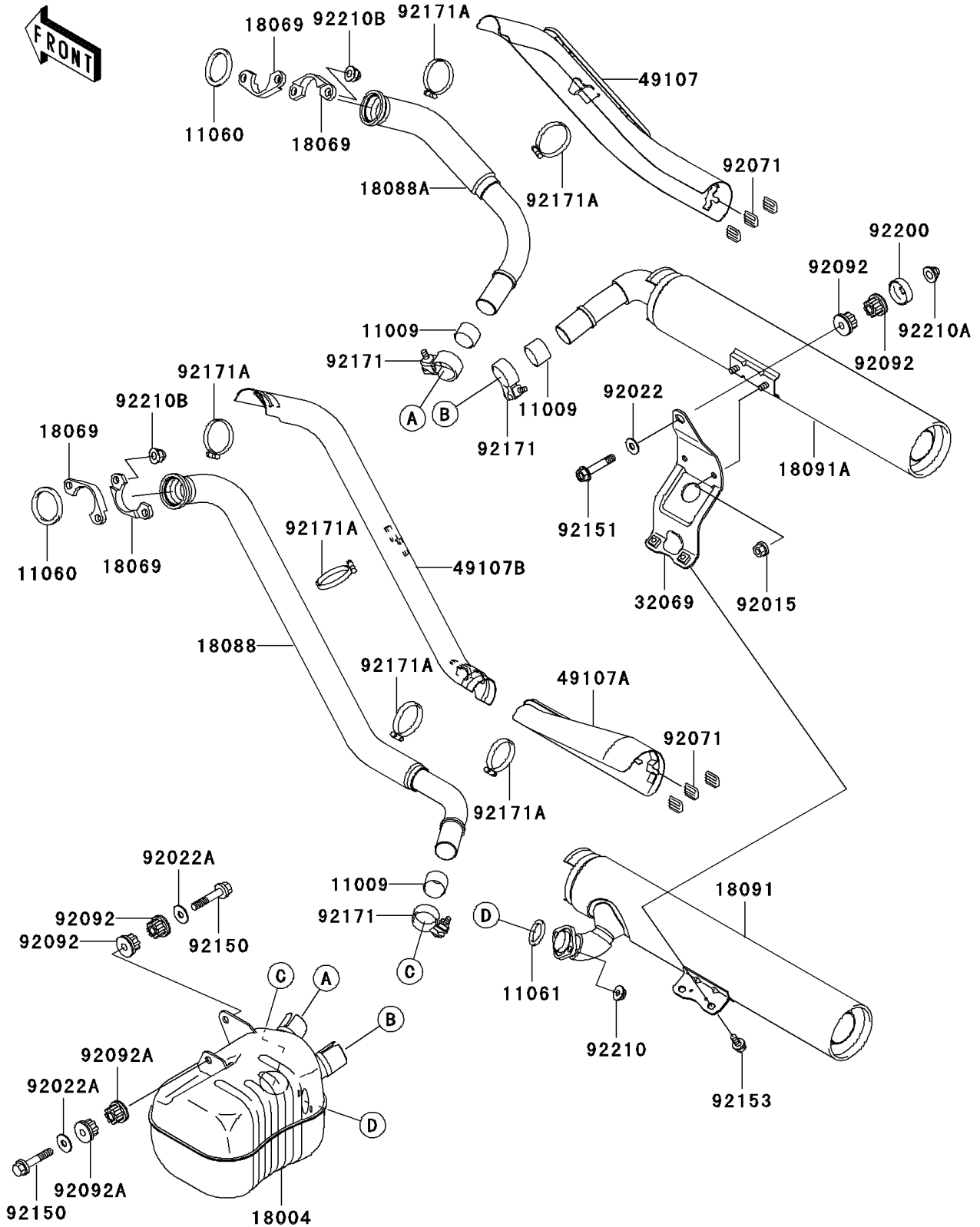

## 2005 Vulcan 1600 Mean Streak PARTS LIST

### Muffler(s)

ITEM NAME	PART NUMBER	QUANTITY
GASKET,EXHAUST MANIFOLD (Ref # 11009)	11009-1668	3
GASKET,EXHAUST PIPE (Ref # 11060)	11060-1119	2
GASKET,EXHAUST PIPE (Ref # 11061)	11061-1069	1
CHAMBER-PREMUFLER (Ref # 18004)	18004-0002	1
HOLDER-EXHAUST PIPE (Ref # 18069)	18069-1161	4
PIPE-EXHAUST,FR (Ref # 18088)	18088-1130	1
PIPE-EXHAUST,RR (Ref # 18088A)	18088-1131	1
BODY-COMP-MUFFLER,LWR (Ref # 18091)	18091-0070	1
BODY-COMP-MUFFLER (Ref # 18091A)	18091-0071	1
BRACKET-MUFFLER (Ref # 32069)	32069-1631	1
COVER-EXHAUST PIPE,RR (Ref # 49107)	49107-0023	1
COVER-EXHAUST PIPE (Ref # 49107A)	49107-1202	1
COVER-EXHAUST PIPE,FR (Ref # 49107B)	49107-1216	1
NUT,8MM (Ref # 92015)	92015-1936	2
WASHER,10.5X26X2.3 (Ref # 92022)	92022-044	1
WASHER,10.5X30X2.3,BLACK (Ref # 92022A)	92022-1302	2
GROMMET (Ref # 92071)	92071-1270	6
BUSHING-RUBBER,MUFFLER (Ref # 92092)	92092-1013	4
BUSHING-RUBBER (Ref # 92092A)	92092-1081	2
BOLT,10X55 (Ref # 92150)	92150-1749	2
BOLT,FLANGED,10X57 (Ref # 92151)	92151-1332	1
BOLT,FLANGED,8X14 (Ref # 92153)	92153-0387	2
CLAMP (Ref # 92171)	92171-0084	3
CLAMP (Ref # 92171A)	92171-0137	6
WASHER,10.5X36X2 (Ref # 92200)	92200-1664	1
NUT,8MM (Ref # 92210)	92210-0076	2
NUT,CAP,10MM (Ref # 92210A)	92210-1121	1
NUT,CAP,8MM (Ref # 92210B)	92210-1132	4