

2006 Vulcan 1600 Nomad PARTS DIAGRAM

Muffler(s)

E1140

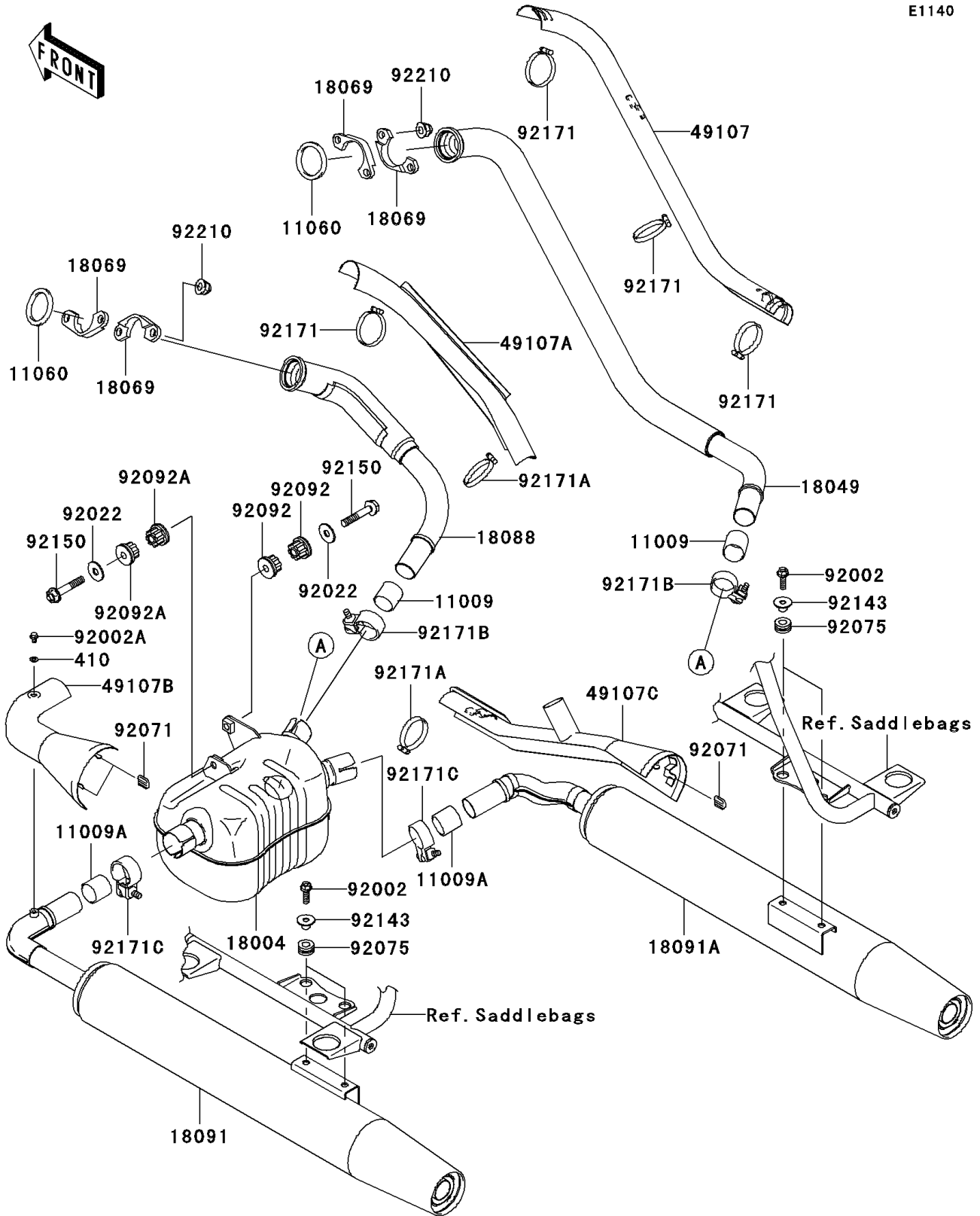

2006 Vulcan 1600 Nomad PARTS LIST

Muffler(s)

| ITEM NAME | PART NUMBER | QUANTITY |
|--|-------------|----------|
| WASHER-PLAIN-SMALL,6MM (Ref # 410) | 410S0600 | 1 |
| GASKET,EXHAUST PIPE CONNECTING (Ref # 11009) | 11009-1667 | 2 |
| GASKET,MUFFLER CONNECTING (Ref # 11009A) | 11009-1865 | 2 |
| GASKET,EXHAUST PIPE (Ref # 11060) | 11060-1119 | 2 |
| CHAMBER-PREMUFLER (Ref # 18004) | 18004-0004 | 1 |
| PIPE-EXHAUST,FR (Ref # 18049) | 18049-1906 | 1 |
| HOLDER-EXHAUST PIPE (Ref # 18069) | 18069-1161 | 4 |
| PIPE-EXHAUST,RR (Ref # 18088) | 18088-1100 | 1 |
| BODY-COMP-MUFFLER (Ref # 18091) | 18091-0199 | 1 |
| BODY-COMP-MUFFLER (Ref # 18091A) | 18091-0200 | 1 |
| COVER-EXHAUST PIPE,FRONT (Ref # 49107) | 49107-0015 | 1 |
| COVER-EXHAUST PIPE,RR (Ref # 49107A) | 49107-0055 | 1 |
| COVER-EXHAUST PIPE,LH (Ref # 49107B) | 49107-1158 | 1 |
| COVER-EXHAUST PIPE,RH (Ref # 49107C) | 49107-1180 | 1 |
| BOLT,8X25 (Ref # 92002) | 92002-1591 | 4 |
| BOLT,6X8 (Ref # 92002A) | 92002-1604 | 1 |
| WASHER,10.5X30X2.3,BLACK (Ref # 92022) | 92022-1302 | 2 |
| GROMMET (Ref # 92071) | 92071-1270 | 4 |
| DAMPER (Ref # 92075) | 92075-1898 | 4 |
| BUSHING-RUBBER,MUFFLER (Ref # 92092) | 92092-1013 | 2 |
| BUSHING-RUBBER (Ref # 92092A) | 92092-1081 | 2 |
| COLLAR (Ref # 92143) | 92143-1753 | 4 |
| BOLT,10X55 (Ref # 92150) | 92150-1749 | 2 |
| CLAMP (Ref # 92171) | 92171-0058 | 4 |
| CLAMP (Ref # 92171A) | 92171-0059 | 2 |
| CLAMP,CHAMBER-EX PIPE (Ref # 92171B) | 92171-0061 | 2 |
| CLAMP,CHAMBER-MUFFLER (Ref # 92171C) | 92171-0062 | 2 |
| NUT,CAP,8MM (Ref # 92210) | 92210-1132 | 4 |