

2006 Vulcan 1600 Nomad PARTS DIAGRAM

Chassis Electrical Equipment

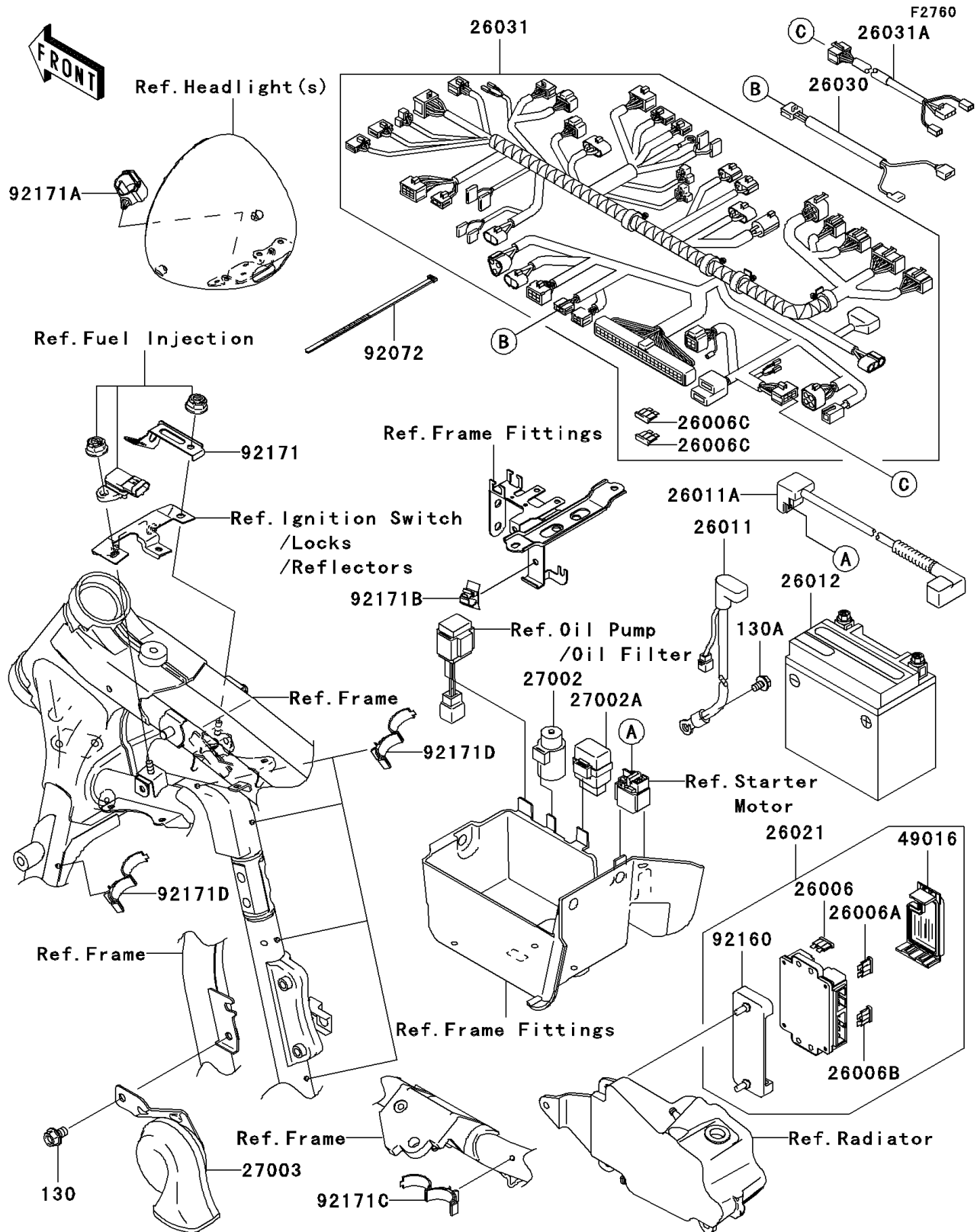

2006 Vulcan 1600 Nomad PARTS LIST

Chassis Electrical Equipment

| ITEM NAME | PART NUMBER | QUANTITY |
|--|-------------|----------|
| BOLT-FLANGED,8X12 (Ref # 130) | 130J0812 | 1 |
| BOLT-FLANGED,6X10 (Ref # 130A) | 130V0610 | 1 |
| FUSE,30A-G (Ref # 26006) | 26006-1006 | 1 |
| FUSE,10A-R (Ref # 26006A) | 26006-1007 | 7 |
| FUSE,15A-B (Ref # 26006B) | 26006-1061 | 1 |
| FUSE,15A (Ref # 26006C) | 26006-1075 | 2 |
| WIRE-LEAD,BATTERY(-) (Ref # 26011) | 26011-0007 | 1 |
| WIRE-LEAD,BATTERY(+) (Ref # 26011A) | 26011-0018 | 1 |
| BATTERY,MF,FTZ16-BS,12V 18AH (Ref # 26012) | 26012-1371 | 1 |
| JUNCTION BOX (Ref # 26021) | 26021-0002 | 1 |
| HARNESS,SUB (Ref # 26030) | 26030-1450 | 1 |
| HARNESS,MAIN (Ref # 26031) | 26031-0317 | 1 |
| HARNESS,TAIL (Ref # 26031A) | 26031-1077 | 1 |
| RELAY-ASSY (Ref # 27002) | 27002-1051 | 1 |
| RELAY-ASSY,SIGNAL LAMP (Ref # 27002A) | 27002-1113 | 1 |
| HORN (Ref # 27003) | 27003-0027 | 1 |
| COVER-SEAL,FUSE (Ref # 49016) | 49016-0005 | 1 |
| BAND,L=365 (Ref # 92072) | 92072-1197 | 1 |
| DAMPER,JUNCTION BOX (Ref # 92160) | 92160-1650 | 1 |
| CLAMP,HARNESS COUPLER (Ref # 92171) | 92171-0065 | 1 |
| CLAMP,DIA=20 (Ref # 92171A) | 92171-0069 | 1 |
| CLAMP,HARNESS (Ref # 92171B) | 92171-1269 | 1 |
| CLAMP,DIA=10 (Ref # 92171C) | 92171-1423 | 1 |
| CLAMP,DIA=15 (Ref # 92171D) | 92171-1424 | 5 |