

1995 Vulcan 750 PARTS DIAGRAM

Transmission

E1361

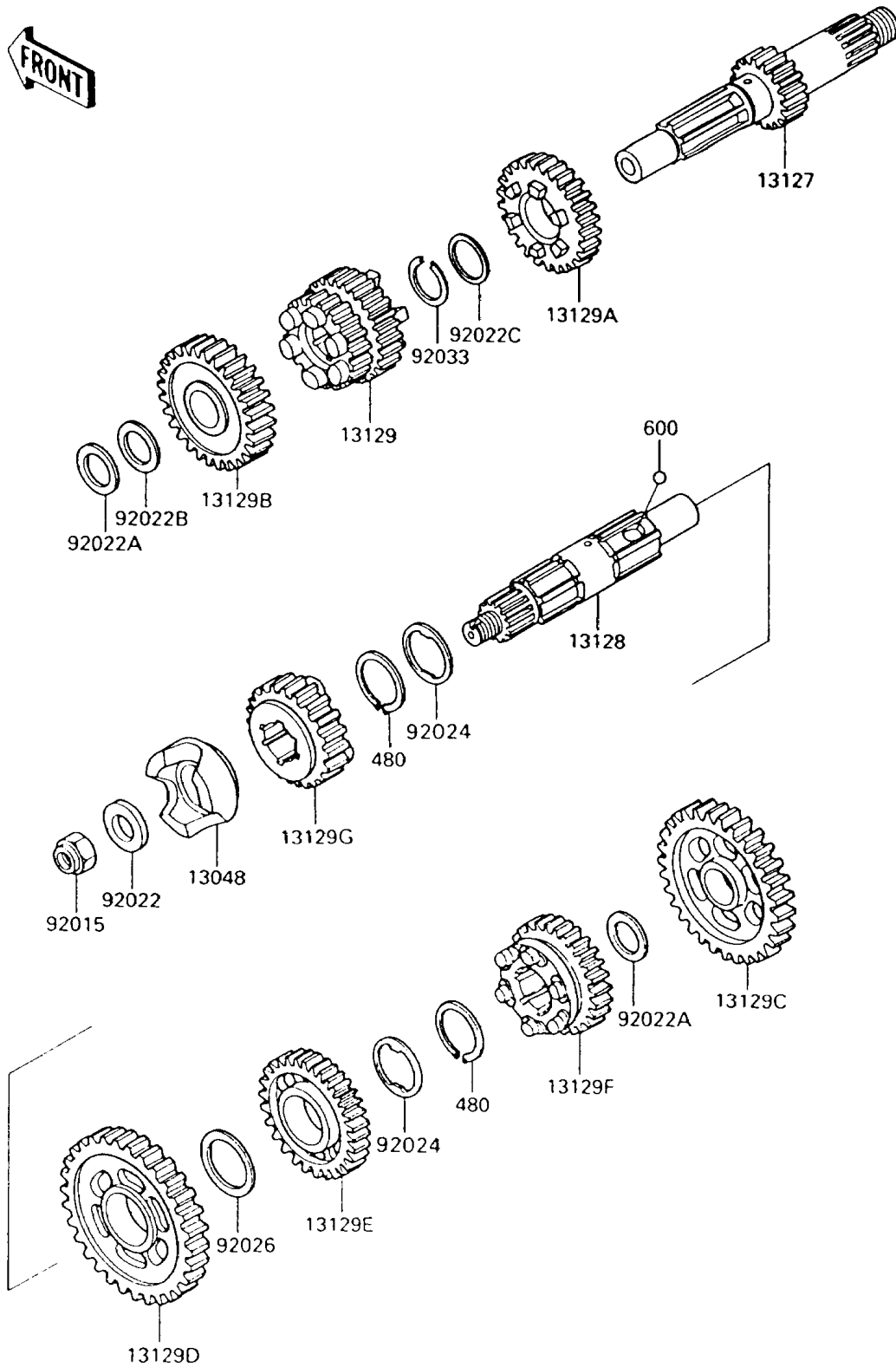

1995 Vulcan 750 PARTS LIST

Transmission

| ITEM NAME | PART NUMBER | QUANTITY |
|--|-------------|----------|
| CIRCLIP-TYPE-C,30MM (Ref # 480) | 480J3000 | 2 |
| BALL-STEEL,5/32" (Ref # 600) | 600A0500 | 3 |
| CAM-DAMPER,OUTPUT SHAFT (Ref # 13048) | 13048-1014 | 1 |
| SHAFT-TRANSMISSION INPUT (Ref # 13127) | 13127-1240 | 1 |
| SHAFT-TRANSMISSION OUTPUT (Ref # 13128) | 13128-1114 | 1 |
| GEAR,INPUT 2ND&3RD,20T&26T (Ref # 13129) | 13129-1630 | 1 |
| GEAR,INPUT 4TH,26T (Ref # 13129A) | 13129-1631 | 1 |
| GEAR,INPUT 5TH,28T (Ref # 13129B) | 13129-1632 | 1 |
| GEAR,OUTPUT LOW,36T (Ref # 13129C) | 13129-1633 | 1 |
| GEAR,OUTPUT 2ND,32T (Ref # 13129D) | 13129-1634 | 1 |
| GEAR,OUTPUT 3RD,32T (Ref # 13129E) | 13129-1635 | 1 |
| GEAR,OUTPUT 4TH,26T (Ref # 13129F) | 13129-1636 | 1 |
| GEAR,OUTPUT 5TH,24T (Ref # 13129G) | 13129-1637 | 1 |
| NUT,LOCK,14MM (Ref # 92015) | 92015-1067 | 1 |
| WASHER,14.1X31X5 (Ref # 92022) | 92022-1115 | 1 |
| WASHER,20.5X30X1,STEEL (Ref # 92022A) | 92022-112 | 2 |
| WASHER,20.5X30X0.5,STEEL (Ref # 92022B) | 92022-144 | 1 |
| WASHER,25.3X30X1 (Ref # 92022C) | 92022-161 | 1 |
| WASHER,TOOTHED,30.5X38X1 (Ref # 92024) | 92024-069 | 2 |
| SPACER,30X38X1.0 (Ref # 92026) | 92026-079 | 1 |
| RING-SNAP,24MM (Ref # 92033) | 92033-026 | 1 |