

1995 Vulcan 750 PARTS DIAGRAM

Engine Cover(s)

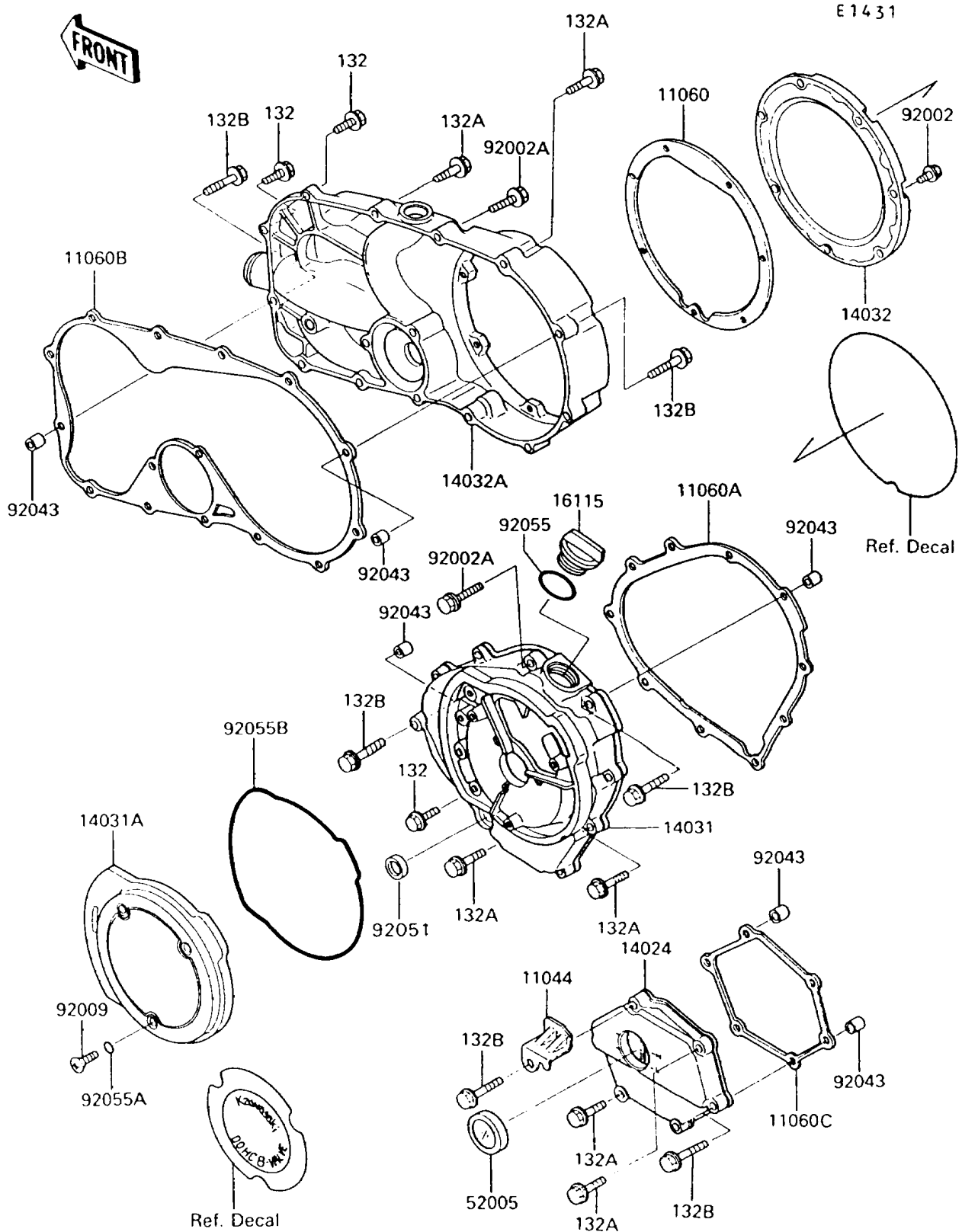

1995 Vulcan 750 PARTS LIST

Engine Cover(s)

| ITEM NAME | PART NUMBER | QUANTITY |
|---|-------------|----------|
| BOLT-FLANGED-SMALL (Ref # 132) | 132E0625 | 5 |
| BOLT-FLANGED-SMALL (Ref # 132A) | 132E0630 | 16 |
| BOLT-FLANGED-SMALL (Ref # 132B) | 132E0640 | 8 |
| BRACKET,LEAD WIRE (Ref # 11044) | 11044-1474 | 1 |
| GASKET,CLUTCH OUTSIDE COVER (Ref # 11060) | 11060-1088 | 1 |
| GASKET,GENERATOR COVER (Ref # 11060A) | 11060-1089 | 1 |
| GASKET,CLUTCH COVER (Ref # 11060B) | 11060-1090 | 1 |
| GASKET,TRANSMISSION COVER (Ref # 11060C) | 11060-1091 | 1 |
| COVER,TRANSMISSION (Ref # 14024) | 14024-1175 | 1 |
| COVER-GENERATOR (Ref # 14031) | 14031-1187 | 1 |
| COVER-GENERATOR,OUTSIDE (Ref # 14031A) | 14031-1188 | 1 |
| COVER-CLUTCH,OUTSIDE (Ref # 14032) | 14032-1207 | 1 |
| COVER-CLUTCH (Ref # 14032A) | 14032-1211 | 1 |
| CAP-OIL FILLER (Ref # 16115) | 16115-1055 | 1 |
| GAUGE,OIL LEVEL (Ref # 52005) | 52005-1009 | 1 |
| BOLT,FLANGED,6X16 (Ref # 92002) | 92002-1439 | 7 |
| BOLT,6X30 (Ref # 92002A) | 92002-1622 | 2 |
| SCREW (Ref # 92009) | 92009-1715 | 3 |
| PIN,6.2X8X14 (Ref # 92043) | 92043-1263 | 6 |
| SEAL-OIL,TB13225.5 (Ref # 92051) | 92051-005 | 1 |
| RING-O,31.5X2.6 (Ref # 92055) | 92055-049 | 1 |
| RING-O,5.28X1.78 (Ref # 92055A) | 92055-109 | 3 |
| RING-O,GENERATOR COVER (Ref # 92055B) | 92055-1319 | 1 |