

1996 Vulcan 750 PARTS DIAGRAM

Fuel Tank

F2410

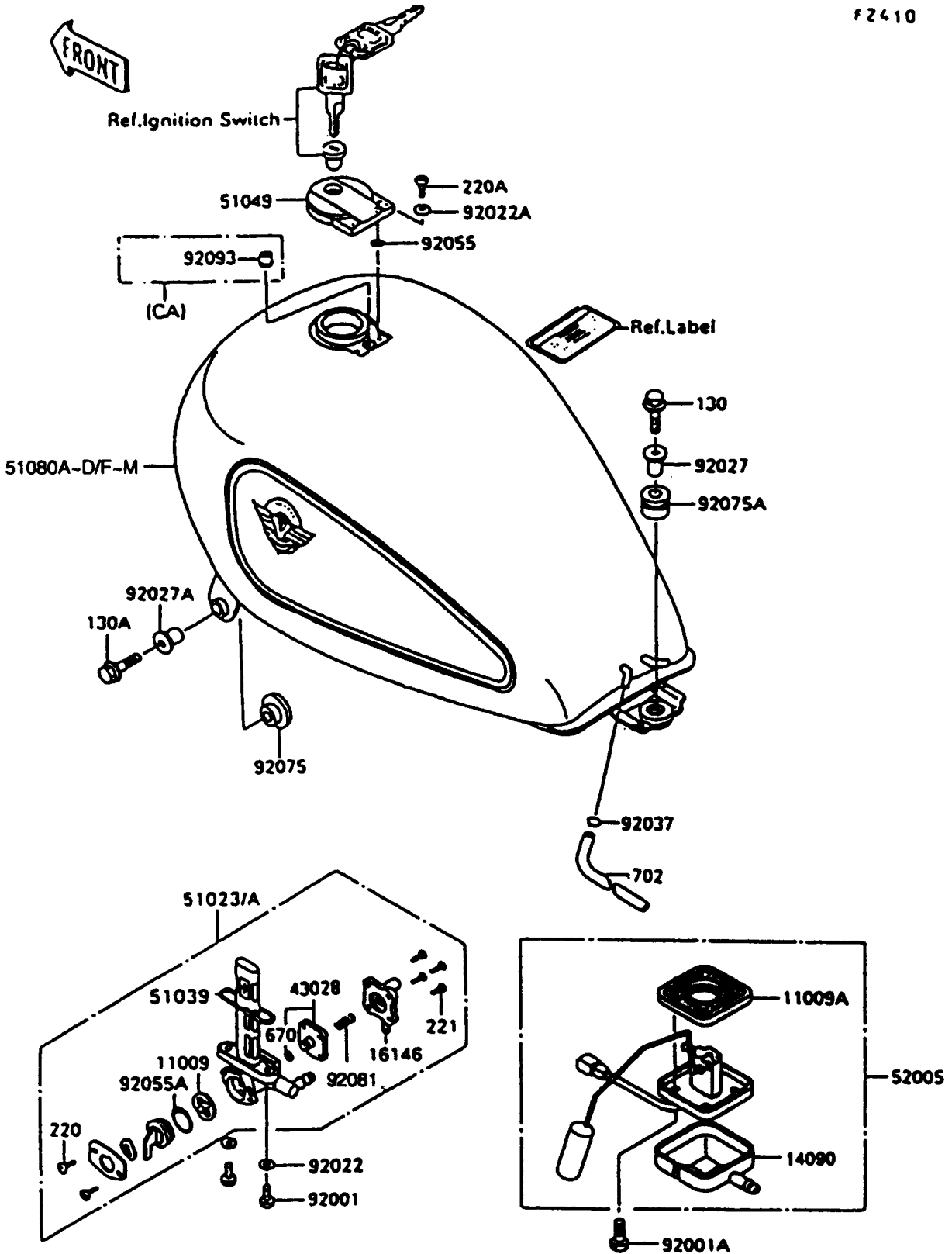

1996 Vulcan 750 PARTS LIST

Fuel Tank

ITEM NAME	PART NUMBER	QUANTITY
GASKET,TAP VALVE (Ref # 11009)	11009-1188	1
GASKET,FUEL GAUGE (Ref # 11009A)	11009-1656	1
COVER,FUEL GAUGE (Ref # 14090)	14090-1624	1
COVER-ASSY,TAP DIAPHRAGM (Ref # 16146)	16146-1010	1
DIAPHRAGM (Ref # 43028)	43028-1033	1
TAP-ASSY,FUEL (Ref # 51023A)	51023-1215	1
RING,TAP FLANGED (Ref # 51039)	51039-003	1
CAP-TANK,FUEL (Ref # 51049)	51049-1083	1
TANK-COMP-FUEL,RED/GRAY (Ref # 51080F)	51080-5217-G7	1
TANK-COMP-FUEL,RED/GRAY (Ref # 51080G)	51080-5218-G7	1
TANK-COMP-FUEL,BLUE/SILVER (Ref # 51080H)	51080-5219-H5	1
TANK-COMP-FUEL,BLUE/SILVER (Ref # 51080I)	51080-5220-H5	1
GAUGE,FUEL (Ref # 52005)	52005-1070	1
BOLT,6X20 (Ref # 92001)	92001-1091	2
BOLT,FUEL GAUGE (Ref # 92001A)	92001-1705	4
WASHER,6.2X11X1.5 (Ref # 92022)	92022-183	2
WASHER,5.1X10X1.0 (Ref # 92022A)	92022-1977	2
COLLAR,L=19.3 (Ref # 92027)	92027-1780	1
COLLAR (Ref # 92027A)	92027-1929	2
CLAMP,TUBE (Ref # 92037)	92037-1461	1
RING-O (Ref # 92055)	92055-1023	2
BOLT-FLANGED,8X25,BLACK (Ref # 130)	130C0825	2
BOLT-FLANGED,8X30 (Ref # 130A)	130G0830	1
SCREW-PAN-CROS (Ref # 220)	220B0308	2
SCREW-PAN-CROS (Ref # 220A)	220B0510	2
SCREW-CSK-CROS,4X14 (Ref # 221)	221B0414	4
O RING,4MM (Ref # 670)	670B1504	1
TUBE-RUBBER,5X8X630 (Ref # 702)	702A05630	1
RING-O,TAP LEVER (Ref # 92055A)	92055-1085	1

1996 Vulcan 750 PARTS LIST

Fuel Tank

ITEM NAME	PART NUMBER	QUANTITY
DAMPER,FUEL TANK (Ref # 92075)	92075-1677	2
DAMPER (Ref # 92075A)	92075-1736	1
SPRING,TAP DIAPHRAGM (Ref # 92081)	92081-1240	1
SEAL,FUEL TANK CAP (Ref # 92093)	92093-1030	1