

# 1990 Vulcan 750 PARTS DIAGRAM

Front Master Cylinder(VN750-A6)

F 2291

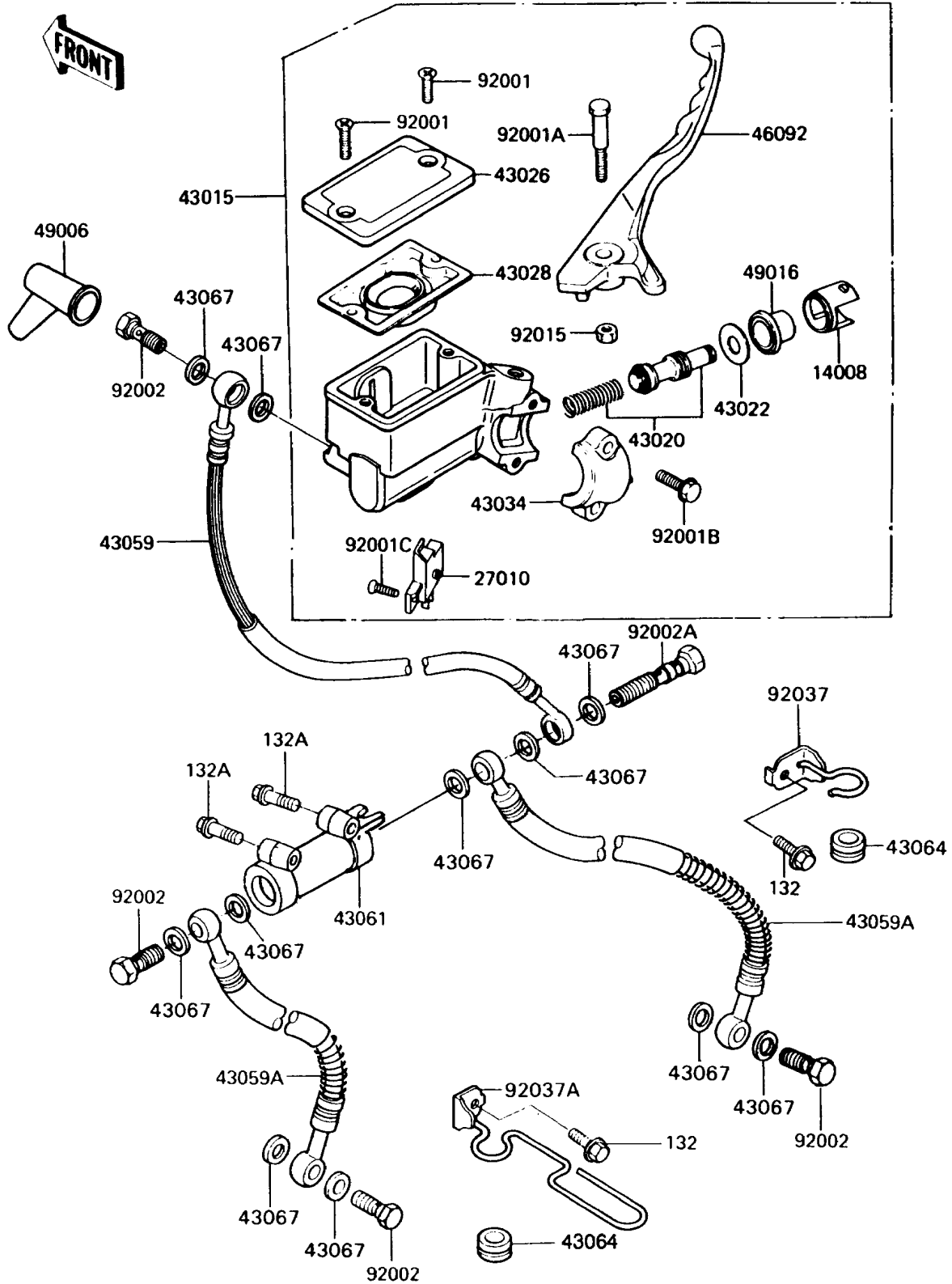

# 1990 Vulcan 750 PARTS LIST

Front Master Cylinder(VN750-A6)

ITEM NAME	PART NUMBER	QUANTITY
BOLT-FLANGED-SMALL (Ref # 132)	132E0612	2
BOLT-FLANGED-SMALL (Ref # 132A)	132G0635	2
LINER,PISTON (Ref # 14008)	14008-1035	1
SWITCH,BRAKE (Ref # 27010)	27010-1056	1
CYLINDER-ASSY-MASTER,FR (Ref # 43015)	43015-1313	1
PISTON-COMP-BRAKE (Ref # 43020)	43020-1079	1
STOPPER-BRAKE,PISTON (Ref # 43022)	43022-1009	1
CAP-BRAKE (Ref # 43026)	43026-1056	1
DIAPHRAGM,MASTER CYLINDER (Ref # 43028)	43028-1029	1
HOLDER-BRAKE,MASTER CYLINDER (Ref # 43034)	43034-1001	1
HOSE-BRAKE (Ref # 43059)	43059-1293	1
HOSE-BRAKE (Ref # 43059A)	43059-1310	2
JOINT-BRAKE (Ref # 43061)	43061-1002	1
GROMMET,HOSE CLAMP (Ref # 43064)	43064-006	2
WASHER,10.5X15X1.5 (Ref # 43067)	43067-001	11
LEVER-GRIP,FRONT BRAKE (Ref # 46092)	46092-1150	1
BOOT,DUST (Ref # 49006)	49006-1040	1
COVER-SEAL,BRAKE PISTON (Ref # 49016)	49016-1041	1
SCREW-CSK-CROS,5X12,BLACK (Ref # 92001)	92001-1055	2
BOLT,6X37.3,BLACK (Ref # 92001A)	92001-1512	1
BOLT,6X25,W/WASHER,BLACK (Ref # 92001B)	92001-1513	2
SCREW-CSK-CROS,4X10,BLACK (Ref # 92001C)	92001-1532	1
BOLT,OIL,L=23 (Ref # 92002)	92002-1888	4
BOLT,OIL,L=37 (Ref # 92002A)	92002-1909	1
NUT,LOCK,6MM,BLACK (Ref # 92015)	92015-1191	1
CLAMP,BRAKE HOSE (Ref # 92037)	92037-1218	1
CLAMP,BRAKE HOSE,LH (Ref # 92037A)	92037-1367	1