

1990 Vulcan 750 PARTS DIAGRAM

Front Fork

F 2340

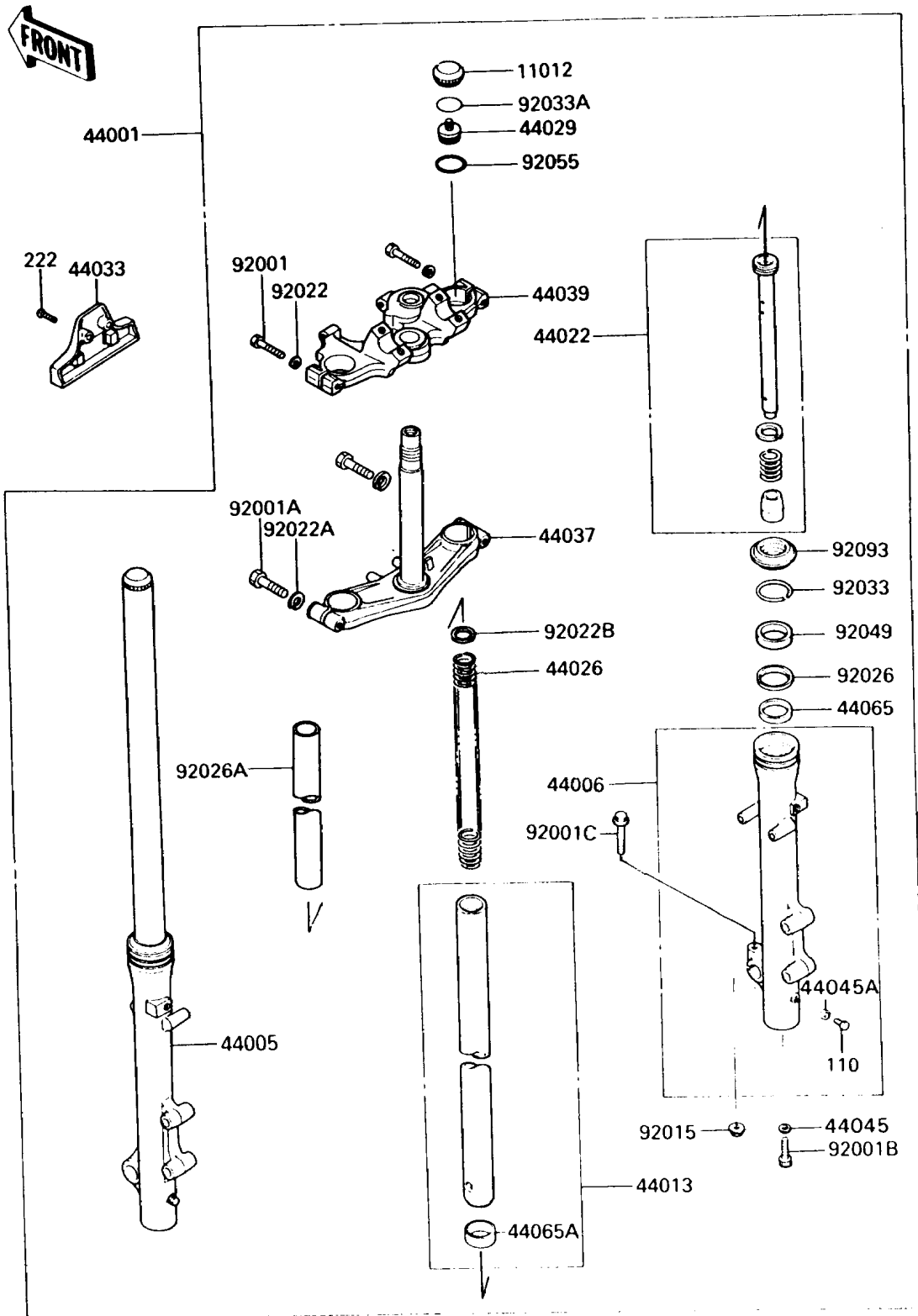

1990 Vulcan 750 PARTS LIST

Front Fork

| ITEM NAME | PART NUMBER | QUANTITY |
|--|-------------|----------|
| BOLT,6X8 (Ref # 110) | 110B0608 | 2 |
| SCREW-CSK-RD-CROS (Ref # 222) | 222C0520 | 2 |
| CAP,FORK TOP (Ref # 11012) | 11012-1696 | 2 |
| FORK-FRONT (Ref # 44001) | 44001-1723 | 1 |
| PIPE-LEFT FORK OUTER (Ref # 44005) | 44005-1231 | 1 |
| PIPE-RIGHT FORK OUTER (Ref # 44006) | 44006-1231 | 1 |
| PIPE-FORK INNER (Ref # 44013) | 44013-1230 | 2 |
| CYLINDER-FORK (Ref # 44022) | 44022-1180 | 2 |
| SPRING-FRONT FORK,K=0.5 (Ref # 44026) | 44026-1301 | 2 |
| SEAT-FORK SPRING (Ref # 44029) | 44029-1135 | 2 |
| COVER-FORK (Ref # 44033) | 44033-1166 | 1 |
| HOLDER-FORK UNDER (Ref # 44037) | 44037-1175 | 1 |
| HOLDER-FORK UPPER (Ref # 44039) | 44039-1117 | 1 |
| GASKET,FORK CYLINDER BOLT (Ref # 44045) | 44045-051 | 2 |
| GASKET,DRAIN PLUG (Ref # 44045A) | 44045-052 | 2 |
| BUSHING-FRONT FORK (Ref # 44065) | 44065-1070 | 2 |
| BUSHING-FRONT FORK,INNER PIPE (Ref # 44065A) | 44065-1071 | 2 |
| BOLT,8X40 (Ref # 92001) | 92001-1063 | 2 |
| BOLT,10X40 (Ref # 92001A) | 92001-1454 | 2 |
| BOLT,FORK CYLINDER (Ref # 92001B) | 92001-1464 | 2 |
| BOLT,FLANGED,8X50 (Ref # 92001C) | 92001-1486 | 1 |
| NUT,FLANGED,8MM (Ref # 92015) | 92015-1055 | 1 |
| WASHER,SPRING,8MM (Ref # 92022) | 92022-1703 | 2 |
| WASHER,SPRING,10MM (Ref # 92022A) | 92022-1704 | 2 |
| WASHER,SPRING SEAT (Ref # 92022B) | 92022-1713 | 2 |
| SPACER,FORK (Ref # 92026) | 92026-1254 | 2 |
| SPACER,FRONT FORK SPRING (Ref # 92026A) | 92026-1255 | 2 |
| RING-SNAP,FORK (Ref # 92033) | 92033-1200 | 2 |
| RING-SNAP (Ref # 92033A) | 92033-1201 | 2 |

1990 Vulcan 750 PARTS LIST

Front Fork

| ITEM NAME | PART NUMBER | QUANTITY |
|---------------------------------------|-------------|----------|
| SEAL-OIL,FORK (Ref # 92049) | 92049-1230 | 2 |
| RING-O,FORK SPRING SEAT (Ref # 92055) | 92055-1309 | 2 |
| SEAL,FORK (Ref # 92093) | 92093-1197 | 2 |