

2008 Vulcan® 2000 Classic PARTS DIAGRAM

Fuel Tank

F2410

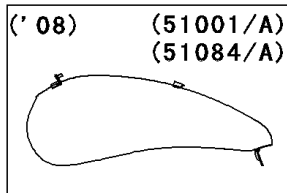

WOD

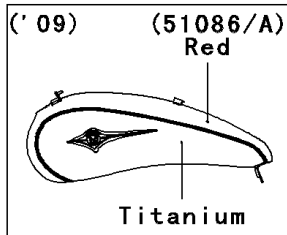

WD

(51001)	Black
(51001A)	Silver
(51084)	Black
(51084A)	Silver

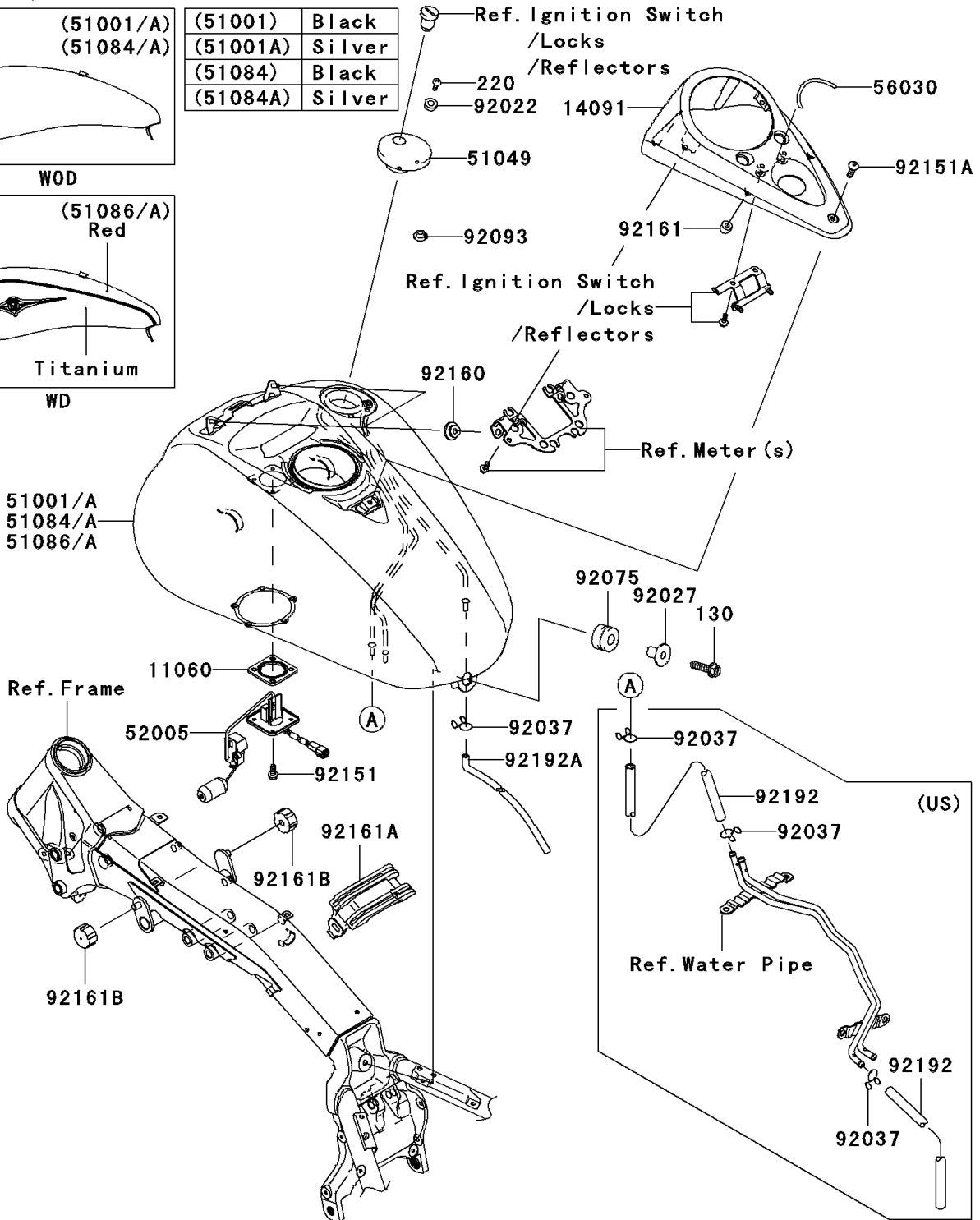

2008 Vulcan® 2000 Classic PARTS LIST

Fuel Tank

ITEM NAME	PART NUMBER	QUANTITY
GASKET,FUEL GAUGE (Ref # 11060)	11060-1952	1
COVER,METER (Ref # 14091)	14091-0530	1
CAP-TANK,FUEL (Ref # 51049)	51049-0003	1
GAUGE,FUEL (Ref # 52005)	52005-0022	1
LABEL,IGNITION SWITCH (Ref # 56030)	56030-0103	1
WASHER,5.1X10X1.0 (Ref # 92022)	92022-1977	2
COLLAR,L=19.3 (Ref # 92027)	92027-1780	1
DAMPER (Ref # 92075)	92075-1736	1
SEAL,FUEL TANK CAP (Ref # 92093)	92093-1030	1
BOLT,5X12 (Ref # 92151)	92151-1599	4
BOLT,SOCKET,6X12 (Ref # 92151A)	92151-1940	1
BOLT-FLANGED,8X30 (Ref # 130)	130BA0830	1
SCREW-PAN-CROSS,5X10 (Ref # 220)	220AA0510	2
DAMPER (Ref # 92160)	92160-1613	2
DAMPER,METER COVER (Ref # 92161)	92161-0040	4
DAMPER,FUEL TANK,CNT (Ref # 92161A)	92161-0042	1
DAMPER,FUEL TANK (Ref # 92161B)	92161-0293	2
TUBE,DRAIN (Ref # 92192A)	92192-0316	1
TANK-COMP-FUEL,M.D,BLACK (Ref # 51001)	51001-0224-17K	1
TANK-COMP-FUEL,A.SILVER (Ref # 51001A)	51001-0224-17M	1
TANK-COMP-FUEL,M.D,BLACK (Ref # 51084)	51084-5201-17K	1
TANK-COMP-FUEL,A.SILVER (Ref # 51084A)	51084-5201-17M	1
CLAMP,TUBE (Ref # 92037)	92037-147	1
CLAMP,TUBE (Ref # 92037)	92037-147	4
TUBE,BLUE (Ref # 92192)	92192-0037	2