

# 1999 Vulcan 800 PARTS DIAGRAM

Camshaft(s)/Tensioner

E1230

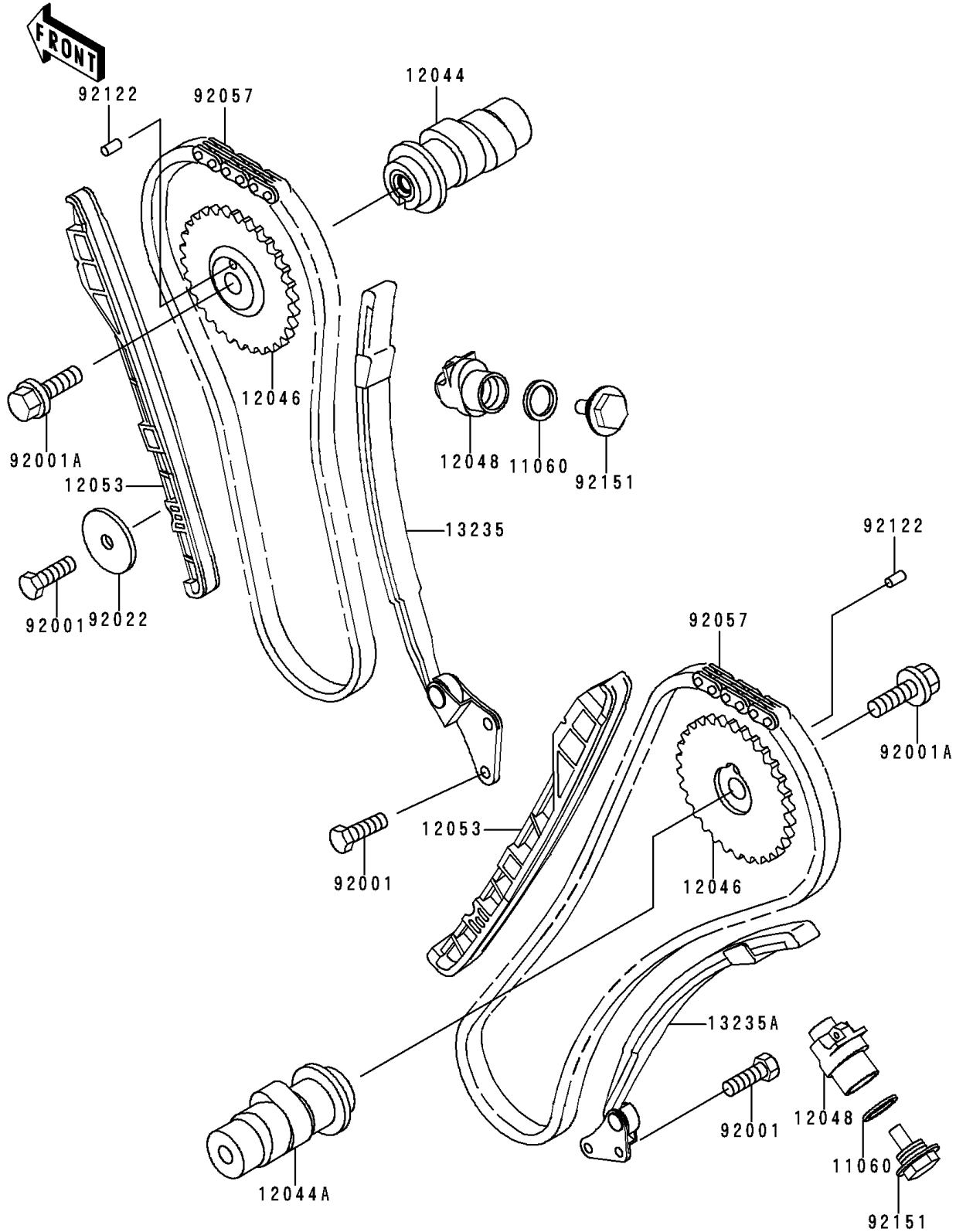

# 1999 Vulcan 800 PARTS LIST

## Camshaft(s)/Tensioner

| ITEM NAME                        | PART NUMBER | QUANTITY |
|----------------------------------|-------------|----------|
| GASKET,TENSIONER (Ref # 11060)   | 11060-1682  | 2        |
| CAMSHAFT-VALVE,FR (Ref # 12044)  | 12044-1377  | 1        |
| CAMSHAFT-VALVE,RR (Ref # 12044A) | 12044-1378  | 1        |
| SPROCKET (Ref # 12046)           | 12046-1171  | 2        |
| TENSIONER-ASSY (Ref # 12048)     | 12048-1145  | 2        |
| GUIDE-CHAIN (Ref # 12053)        | 12053-1354  | 2        |
| GUIDE-COMP,FR (Ref # 13235)      | 13235-1067  | 1        |
| GUIDE-COMP,RR (Ref # 13235A)     | 13235-1068  | 1        |
| BOLT,6X16 (Ref # 92001)          | 92001-1457  | 5        |
| BOLT,10X23 (Ref # 92001A)        | 92001-1859  | 2        |
| WASHER,7X27X1.6 (Ref # 92022)    | 92022-227   | 1        |
| CHAIN,CAM (Ref # 92057)          | 92057-1403  | 2        |
| ROLLER,4X9.8 (Ref # 92122)       | 92122-1197  | 2        |
| BOLT,TENSIONER (Ref # 92151)     | 92151-1136  | 2        |