

1996 Vulcan 800 PARTS DIAGRAM

Front Fork

F2340

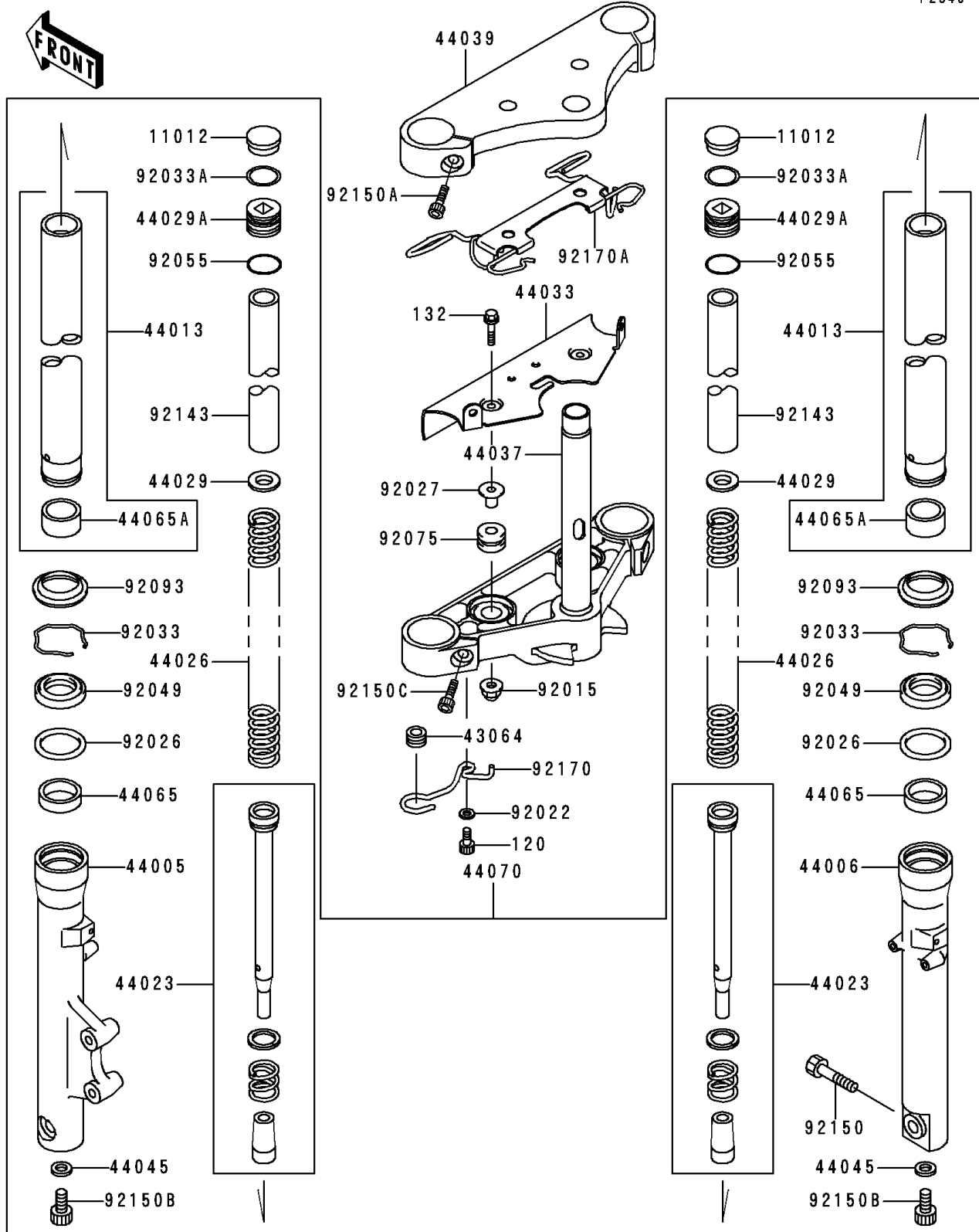

1996 Vulcan 800 PARTS LIST

Front Fork

ITEM NAME	PART NUMBER	QUANTITY
BOLT-SOCKET,6X14 (Ref # 120)	120P0614	1
BOLT-FLANGED-SMALL (Ref # 132)	132E0625	2
CAP,FORK TOP (Ref # 11012)	11012-1618	2
GROMMET,HOSE CLAMP (Ref # 43064)	43064-006	1
PIPE-LEFT FORK OUTER (Ref # 44005)	44005-1357	1
PIPE-RIGHT FORK OUTER (Ref # 44006)	44006-1356	1
PIPE-FORK INNER (Ref # 44013)	44013-1412	2
CYLINDER-COMP-FORK (Ref # 44023)	44023-1097	2
SPRING-FRONT FORK (Ref # 44026)	44026-1589	2
SEAT-FORK SPRING (Ref # 44029)	44029-1131	2
SEAT-FORK SPRING (Ref # 44029A)	44029-1144	2
COVER-FORK (Ref # 44033)	44033-1211	1
HOLDER-FORK UNDER (Ref # 44037)	44037-1334	1
HOLDER-FORK UPPER (Ref # 44039)	44039-1260	1
GASKET,FORK CYLINDER BOLT (Ref # 44045)	44045-051	2
BUSHING-FRONT FORK (Ref # 44065)	44065-1079	2
BUSHING-FRONT FORK,INNER PIPE (Ref # 44065A)	44065-1087	2
DAMPER-ASSY,FORK (Ref # 44070)	44070-1429	1
NUT,CAP,6MM (Ref # 92015)	92015-1385	2
WASHER,6.5X13X2.0 (Ref # 92022)	92022-1523	1
SPACER,FORK OUTER (Ref # 92026)	92026-1276	2
COLLAR,L=16.1 (Ref # 92027)	92027-1847	2
RING-SNAP,FORK OUTER (Ref # 92033)	92033-1222	2
RING-SNAP,SPRING SEAT (Ref # 92033A)	92033-1223	2
SEAL-OIL,FORK (Ref # 92049)	92049-1363	2
RING-O (Ref # 92055)	92055-1481	2
DAMPER (Ref # 92075)	92075-1035	2
SEAL,FORK (Ref # 92093)	92093-1268	2
COLLAR,FORK,L=100 (Ref # 92143)	92143-1792	2

1996 Vulcan 800 PARTS LIST

Front Fork

ITEM NAME	PART NUMBER	QUANTITY
BOLT,SOCKET,10X40 (Ref # 92150)	92150-1029	1
BOLT,SOCKET,8MM (Ref # 92150A)	92150-1031	2
BOLT,SOCKET,8X18 (Ref # 92150B)	92150-1432	2
BOLT (Ref # 92150C)	92150-1960	2
CLAMP,HOSE (Ref # 92170)	92170-1545	1
CLAMP (Ref # 92170A)	92170-1546	1