

2003 Vulcan 800 PARTS DIAGRAM

Camshaft(s)/Tensioner

E1230

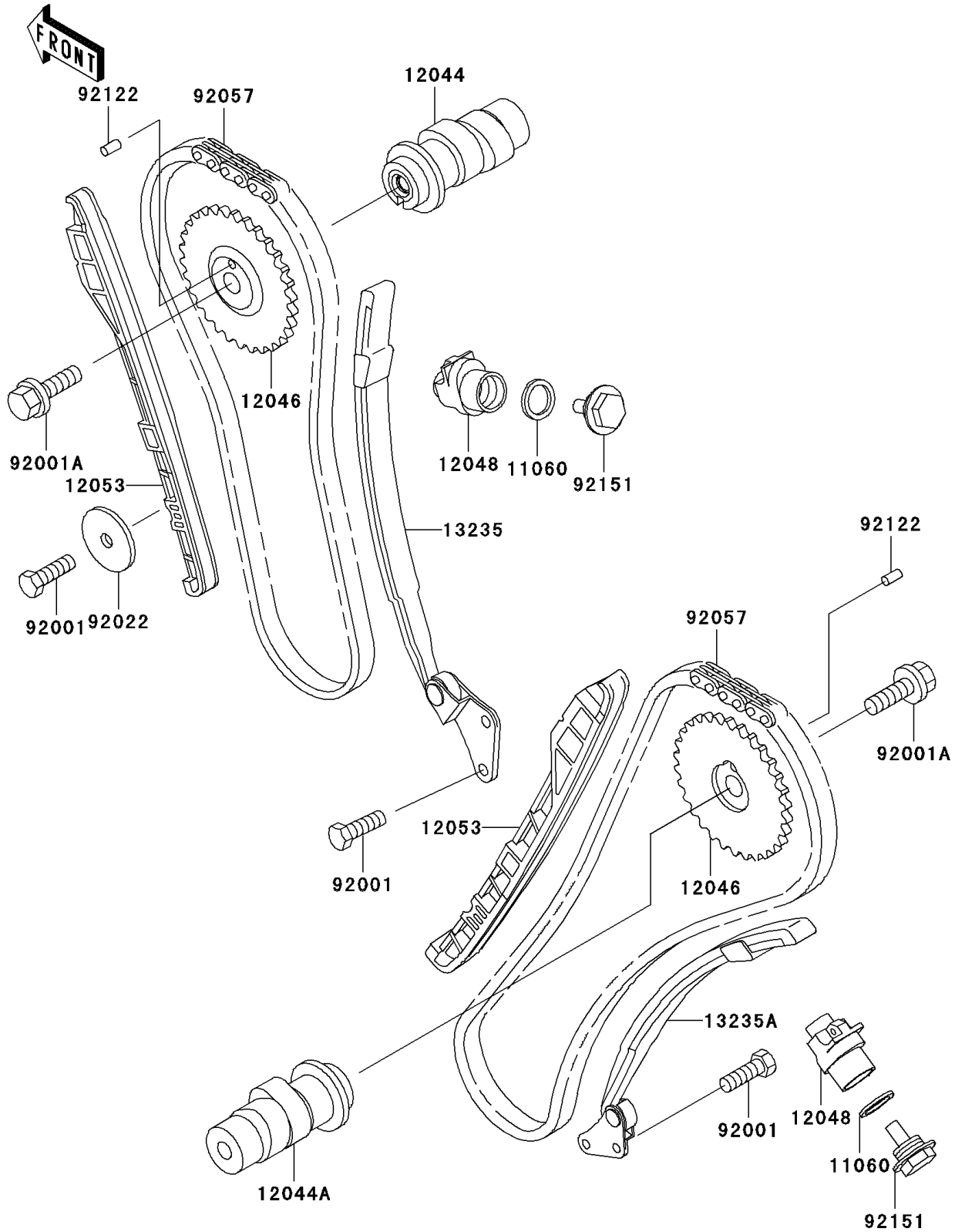

2003 Vulcan 800 PARTS LIST

Camshaft(s)/Tensioner

| ITEM NAME | PART NUMBER | QUANTITY |
|----------------------------------|-------------|----------|
| GASKET,TENSIONER (Ref # 11060) | 11060-1682 | 2 |
| CAMSHAFT-VALVE,FR (Ref # 12044) | 12044-1377 | 1 |
| CAMSHAFT-VALVE,RR (Ref # 12044A) | 12044-1378 | 1 |
| SPROCKET (Ref # 12046) | 12046-1171 | 2 |
| TENSIONER-ASSY (Ref # 12048) | 12048-1145 | 2 |
| GUIDE-CHAIN (Ref # 12053) | 12053-1354 | 2 |
| GUIDE-COMP,FR (Ref # 13235) | 13235-1067 | 1 |
| GUIDE-COMP,RR (Ref # 13235A) | 13235-1068 | 1 |
| BOLT,6X16 (Ref # 92001) | 92001-1457 | 5 |
| BOLT,10X23 (Ref # 92001A) | 92001-1859 | 2 |
| WASHER,7X27X1.6 (Ref # 92022) | 92022-227 | 1 |
| CHAIN,CAM (Ref # 92057) | 92057-1403 | 2 |
| ROLLER,4X9.8 (Ref # 92122) | 92122-1197 | 2 |
| BOLT,TENSIONER (Ref # 92151) | 92151-1136 | 2 |