

2003 Vulcan 800 Drifter PARTS DIAGRAM

Turn Signals

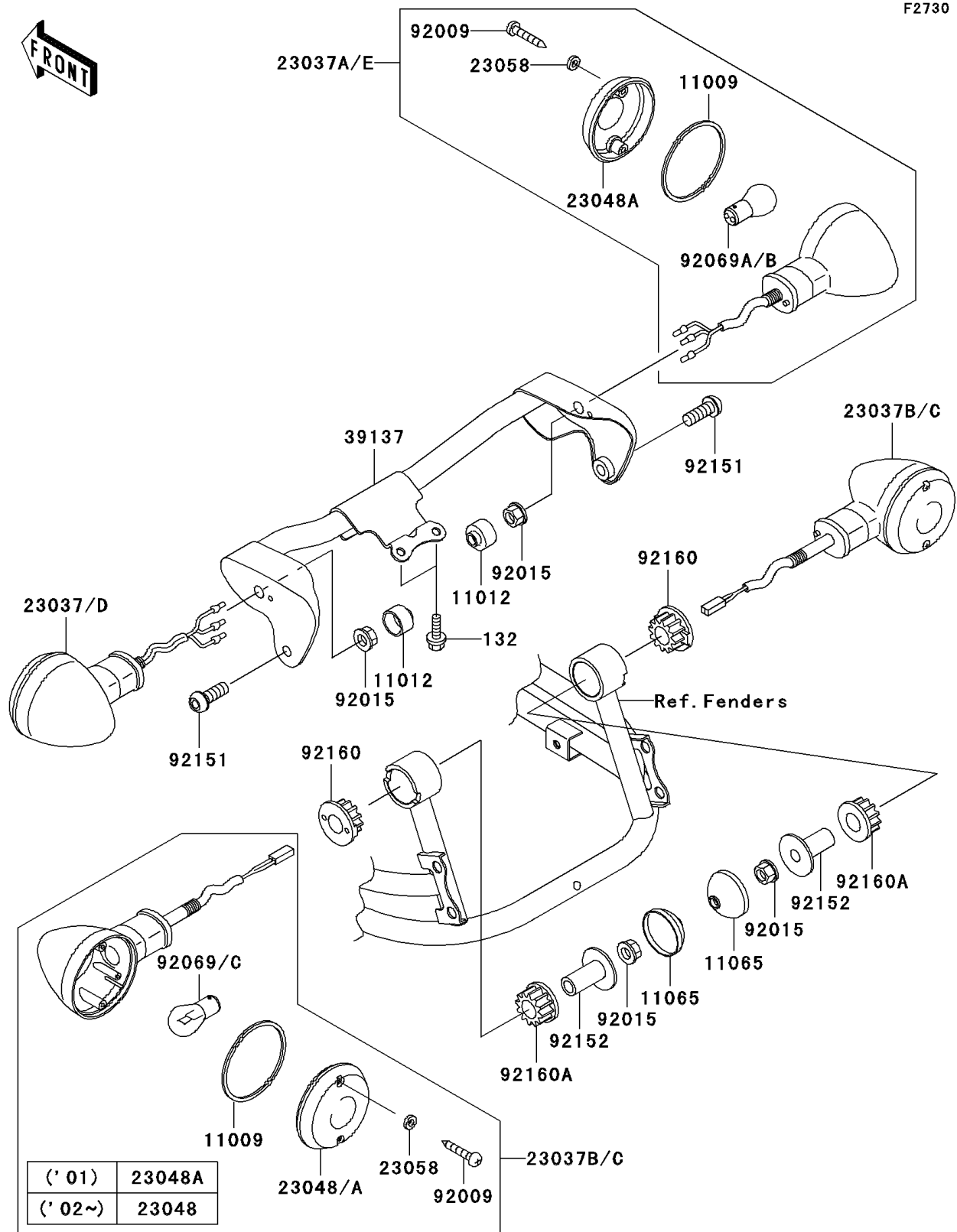

2003 Vulcan 800 Drifter PARTS LIST

Turn Signals

ITEM NAME	PART NUMBER	QUANTITY
BOLT-FLANGED-SMALL (Ref # 132)	132E0612	2
GASKET,SIGNAL LAMP (Ref # 11009)	11009-1413	4
CAP (Ref # 11012)	11012-1367	2
CAP,REAR SIGNAL LAMP (Ref # 11065)	11065-1115	2
LAMP-ASSY-SIGNAL,RR (Ref # 23037C)	23037-1401	2
LAMP-ASSY-SIGNAL,FR,LH (Ref # 23037D)	23037-1426	1
LAMP-ASSY-SIGNAL,FR,RH (Ref # 23037E)	23037-1427	1
LENS-SIGNAL LAMP (Ref # 23048)	23048-1065	2
LENS-SIGNAL LAMP (Ref # 23048A)	23048-1066	2
WASHER,PLAIN,4MM (Ref # 23058)	23058-002	8
STAY-COMP,SIGNAL LAMP,FR (Ref # 39137)	39137-1078	1
SCREW,TAPPING,4X25 (Ref # 92009)	92009-1637	8
NUT,10MM (Ref # 92015)	92015-1356	4
BULB,12V 21/5W (Ref # 92069B)	92069-063	2
BULB,12V 21W (Ref # 92069C)		2
BOLT,SOCKET,8X25 (Ref # 92151)	92151-1327	2
COLLAR,REAR SIGNAL LAMP (Ref # 92152)	92152-1202	2
DAMPER (Ref # 92160)	92160-1966	2
DAMPER (Ref # 92160A)	92160-1967	2