

1988 Concours PARTS DIAGRAM

Front Fork

F2340-0275

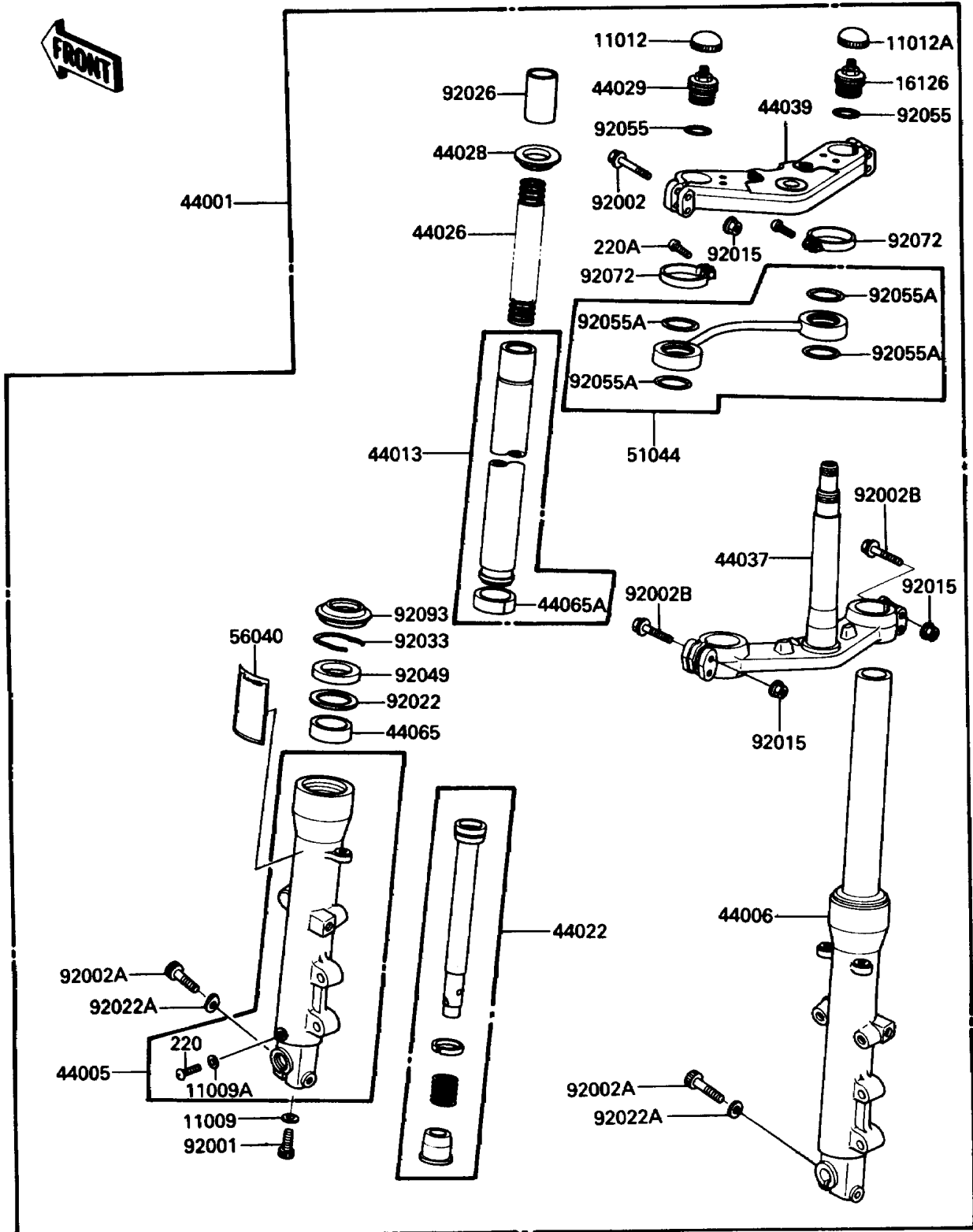

1988 Concours PARTS LIST

Front Fork

ITEM NAME	PART NUMBER	QUANTITY
GASKET,FORK CYLINDER BOLT (Ref # 11009)	11009-1127	2
GASKET,FORK DRAIN PLUG (Ref # 11009A)	44045-002	2
CAP,FORK TOP (Ref # 11012)	11012-1500	1
CAP,FORK TOP (Ref # 11012A)	11012-1501	1
VALVE (Ref # 16126)	16126-1150	1
FORK-FRONT (Ref # 44001)	44001-1623	1
PIPE-LEFT FORK OUTER (Ref # 44005)	44005-1251	1
PIPE-RIGHT FORK OUTER (Ref # 44006)	44006-1250	1
PIPE-FORK INNER (Ref # 44013)	44013-1254	2
CYLINDER-FORK (Ref # 44022)	44022-1197	2
SPRING-FRONT FORK (Ref # 44026)	44026-1340	2
GUIDE-FORK SPRING (Ref # 44028)	44028-1059	2
SEAT-FORK SPRING (Ref # 44029)	44029-1122	1
HOLDER-FORK UNDER (Ref # 44037)	44037-1198	1
HOLDER-FORK UPPER (Ref # 44039)	44039-1135	1
BUSHING-FRONT FORK (Ref # 44065)	44065-1064	2
BUSHING-FRONT FORK,INNER PIPE (Ref # 44065A)	44065-1081	2
TUBE-ASSY,FORK,AIR (Ref # 51044)	51044-1083	1
LABEL-WARNING,AIR SUSPENSION (Ref # 56040)	56040-1117	1
BOLT,FORK CYLINDER (Ref # 92001)	92001-1309	2
BOLT,FLANGED,8X55 (Ref # 92002)	92002-1158	4
BOLT,SOCKET,8X45 (Ref # 92002A)	92002-1847	2
BOLT,FLANGED,8X50 (Ref # 92002B)	92002-1848	4
NUT,FLANGED,8MM (Ref # 92015)	92015-1408	8
WASHER,FORK OUTER TUBE (Ref # 92022)	92022-1298	2
WASHER (Ref # 92022A)	92022-1598	2
SPACER,FORK SPRING (Ref # 92026)	92026-1277	2
RING-SNAP (Ref # 92033)	92033-1036	2
SEAL-OIL,FORK OUTER (Ref # 92049)	92049-1273	2

1988 Concours PARTS LIST

Front Fork

ITEM NAME	PART NUMBER	QUANTITY
RING-O,FORK TOP (Ref # 92055)	92055-1052	2
RING-O,FORK AIR TUBE (Ref # 92055A)	92055-1106	4
BAND (Ref # 92072)	92072-1157	2
SEAL,FORK OUTER TUBE (Ref # 92093)	92093-1232	2
SCREW-PAN-CROS (Ref # 220)	220E0408	2
SCREW-PAN-CROS (Ref # 220A)	220E0412	2