

2000 Concours PARTS DIAGRAM

Clutch

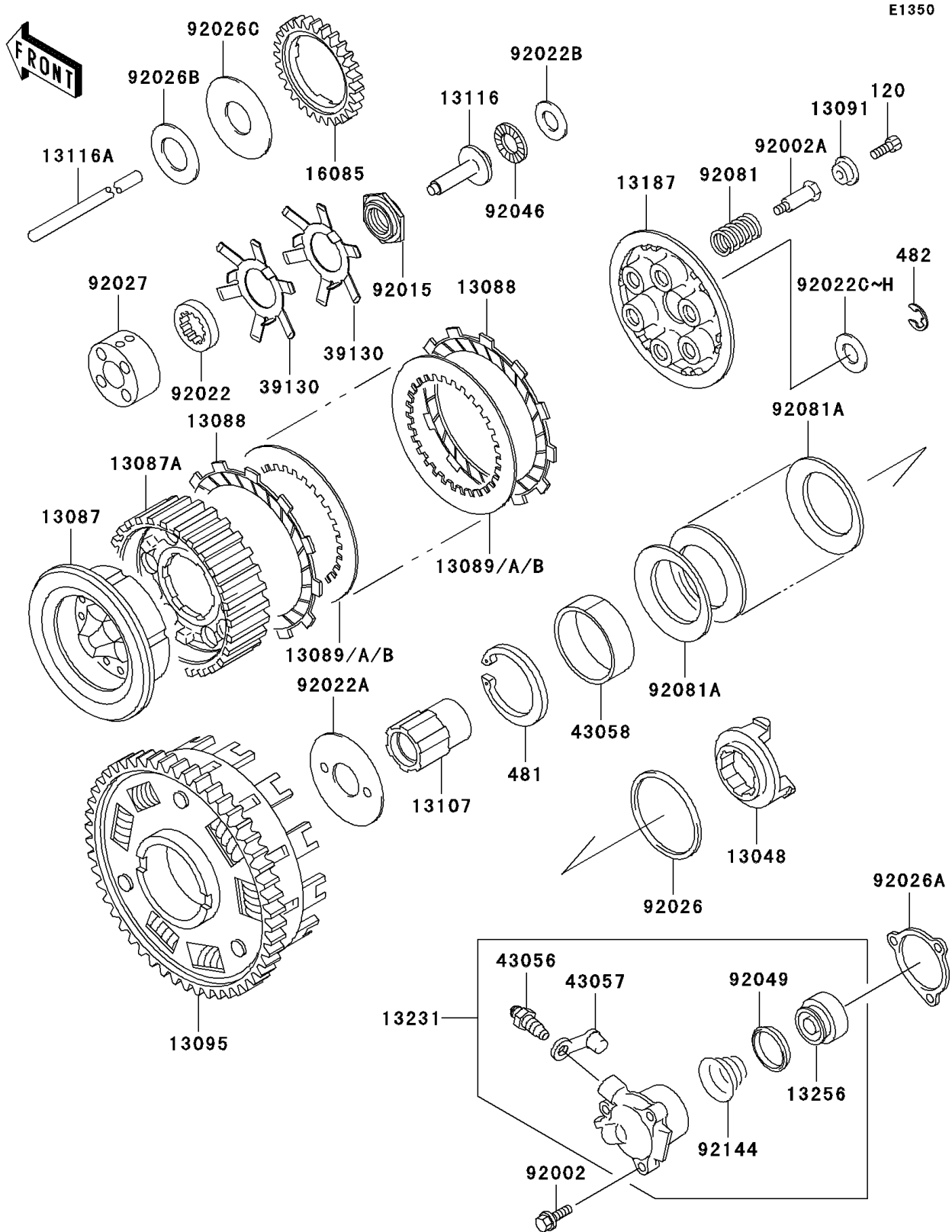

2000 Concours PARTS LIST

Clutch

| ITEM NAME | PART NUMBER | QUANTITY |
|--------------------------------------|-------------|----------|
| CAM-DAMPER (Ref # 13048) | 13048-1007 | 1 |
| HUB-CLUTCH (Ref # 13087) | 13087-1071 | 1 |
| HUB-CLUTCH (Ref # 13087A) | 13087-1072 | 1 |
| PLATE-FRICTION (Ref # 13088) | 13088-1051 | 9 |
| PLATE-CLUTCH,T=2.3 (Ref # 13089) | 13089-1004 | AR |
| PLATE-CLUTCH,T=2.6 (Ref # 13089A) | 13089-1067 | AR |
| PLATE-CLUTCH,T=2.0 (Ref # 13089B) | 13089-1068 | AR |
| HOLDER,CLUTCH SPRING (Ref # 13091) | 13091-1041 | 6 |
| HOUSING-COMP-CLUTCH (Ref # 13095) | 13095-1146 | 1 |
| SHAFT,CLUTCH (Ref # 13107) | 13107-1299 | 1 |
| ROD-PUSH,CLUTCH (Ref # 13116) | 13116-1119 | 1 |
| ROD-PUSH,CLUTCH (Ref # 13116A) | 13116-1140 | 1 |
| PLATE-CLUTCH OPERATING (Ref # 13187) | 13187-1055 | 1 |
| RELEASE-ASSY-CLUTCH (Ref # 13231) | 13231-1072 | 1 |
| PISTON (Ref # 13256) | 13256-1052 | 1 |
| GEAR,OIL PUMP (Ref # 16085) | 16085-1108 | 1 |
| SPRING-LEAF (Ref # 39130) | 39130-1071 | 2 |
| BREATHER (Ref # 43056) | 43056-1052 | 1 |
| CAP-BREATHER (Ref # 43057) | 43057-1001 | 1 |
| RING (Ref # 43058) | 43058-1059 | 1 |
| BOLT,6X25 (Ref # 92002) | 92002-1344 | 3 |
| BOLT,CLUTCH (Ref # 92002A) | 92002-1639 | 6 |
| NUT (Ref # 92015) | 92015-1929 | 1 |
| WASHER,TOOTHED,25X40X5 (Ref # 92022) | 92022-1114 | 1 |
| WASHER,CLUTCH THRUST (Ref # 92022A) | 92022-1221 | 1 |
| WASHER,15.1X29X1.0 (Ref # 92022B) | 92022-1463 | 1 |
| WASHER,15.1X23X1.0 (Ref # 92022C) | 92022-1750 | AR |
| WASHER,15.1X23X0.8 (Ref # 92022D) | 92022-1751 | AR |
| WASHER,15.1X23X1.2 (Ref # 92022E) | 92022-1752 | AR |

2000 Concours PARTS LIST

Clutch

| ITEM NAME | PART NUMBER | QUANTITY |
|--------------------------------------|-------------|----------|
| WASHER,15.1X23X1.4 (Ref # 92022F) | 92022-1753 | AR |
| WASHER,15.1X23X1.6 (Ref # 92022G) | 92022-1754 | AR |
| WASHER,15.1X23X1.8 (Ref # 92022H) | 92022-1755 | AR |
| SPACER,59X70X3.5 (Ref # 92026) | 92026-1043 | 1 |
| SPACER,CLUTCH RELEASE (Ref # 92026A) | 92026-1263 | 1 |
| SPACER,25X45X2.0 (Ref # 92026B) | 92026-1306 | 1 |
| SPACER,25X62X2.0 (Ref # 92026C) | 92026-1307 | 1 |
| COLLAR (Ref # 92027) | 92027-1710 | 1 |
| BEARING-NEEDLE,AXK1102 (Ref # 92046) | 92046-1052 | 1 |
| SEAL-OIL,PISTON (Ref # 92049) | 92049-1165 | 1 |
| SPRING,CLUTCH (Ref # 92081) | 92081-1114 | 6 |
| BOLT-SOCKET,6X16 (Ref # 120) | 120Q0616 | 6 |
| CIRCLIP (Ref # 481) | 481J9500 | 1 |
| CIRCLIP-TYPE-E,12MM (Ref # 482) | 482J0200 | 1 |
| SPRING (Ref # 92081A) | 92081-1906 | 7 |
| SPRING,CLUTCH RELEASE (Ref # 92144) | 92144-1084 | 1 |