

# 2012 KLX® 250S PARTS DIAGRAM

Muffler(s)

E1140

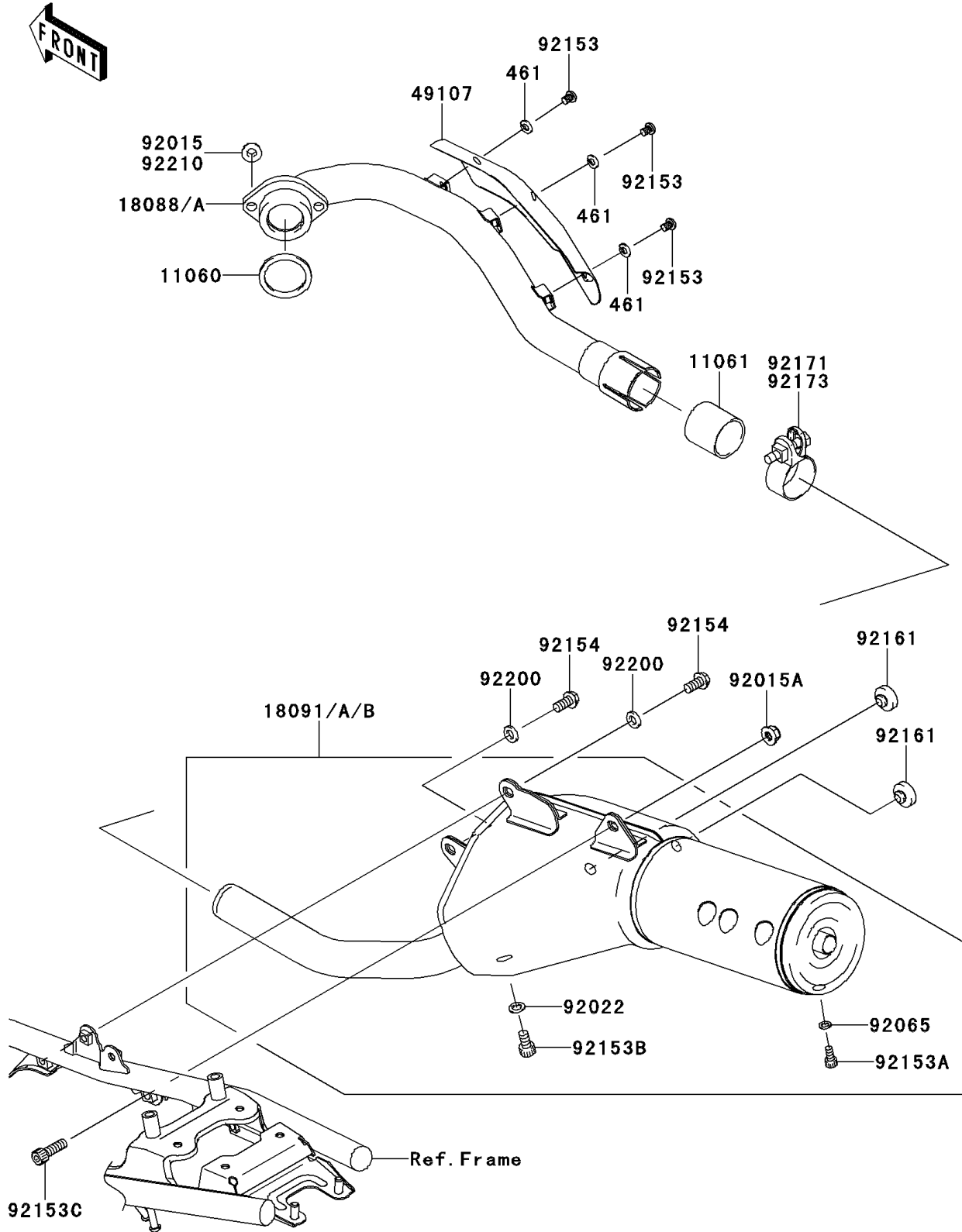

## 2012 KLX® 250S PARTS LIST

### Muffler(s)

| ITEM NAME                                    | PART NUMBER | QUANTITY |
|--|-------------|----------|
| WASHER-SPRING,6MM (Ref # 461)                | 461S0600    | 3        |
| GASKET,EXHAUST PIPE (Ref # 11060)            | 11060-1203  | 1        |
| GASKET,EXHAUST PIPE CONNECTING (Ref # 11061) | 11061-1055  | 1        |
| PIPE-EXHAUST (Ref # 18088A)                  | 18088-0594  | 1        |
| BODY-COMP-MUFFLER (Ref # 18091B)             | 18091-0842  | 1        |
| COVER-EXHAUST PIPE (Ref # 49107)             | 49107-0062  | 1        |
| NUT,8MM (Ref # 92015A)                       | 92015-1432  | 1        |
| WASHER,8.2X14X1.0 (Ref # 92022)              | 92022-1488  | 1        |
| GASKET (Ref # 92065)                         | 92065-096   | 1        |
| BOLT,6X8 (Ref # 92153)                       | 92153-0578  | 3        |
| BOLT,SOCKET,6X12 (Ref # 92153A)              | 92153-1347  | 1        |
| BOLT,SOCKET,8X14 (Ref # 92153B)              | 92153-1348  | 1        |
| BOLT,SOCKET,8X25 (Ref # 92153C)              | 92153-1350  | 1        |
| BOLT,FLANGED,8X16 (Ref # 92154)              | 92154-0059  | 2        |
| DAMPER (Ref # 92161)                         | 92161-0336  | 2        |
| CLAMP (Ref # 92171)                          | 92171-0631  | 1        |
| WASHER,8.1X15X2.3 (Ref # 92200)              | 92200-0449  | 2        |
| NUT,8MM (Ref # 92210)                        | 92210-0076  | 2        |