

2023 Z900 SE PARTS DIAGRAM

Fuel Tank

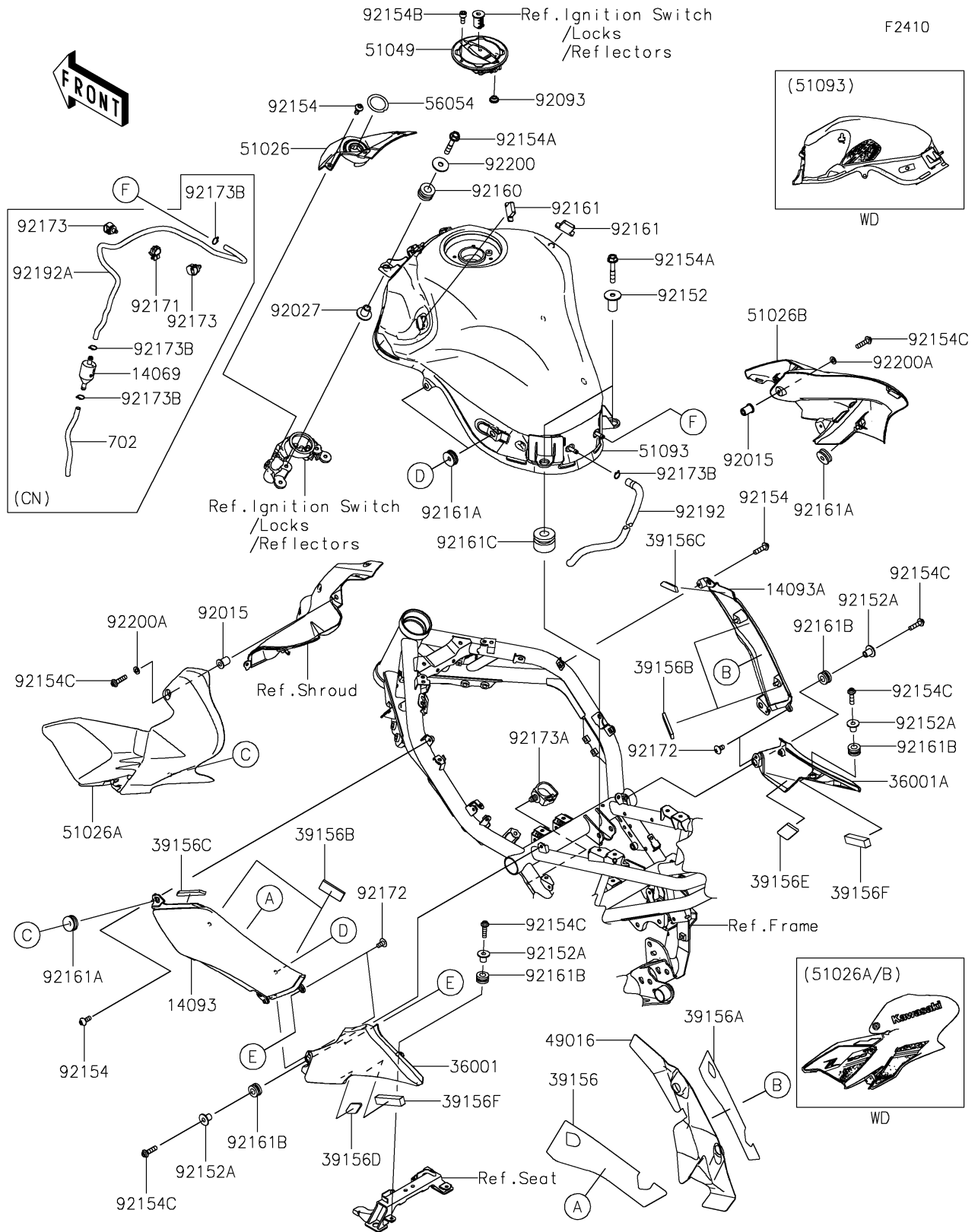

2023 Z900 SE PARTS LIST

Fuel Tank

| ITEM NAME | PART NUMBER | QUANTITY |
|---|----------------|----------|
| BREATHER,TANK (Ref # 14069) | 14069-0008 | 1 |
| COVER,KNEE GRIP,LH (Ref # 14093) | 14093-0667 | 1 |
| COVER,KNEE GRIP,RH (Ref # 14093A) | 14093-0668 | 1 |
| COVER-SIDE,SEAT,LH,M.S.BLACK (Ref # 36001) | 36001-0685-660 | 1 |
| COVER-SIDE,SEAT,RH,M.S.BLACK (Ref # 36001A) | 36001-0686-660 | 1 |
| PAD,KNEE GRIP COVER,LH (Ref # 39156) | 39156-2147 | 1 |
| PAD,KNEE GRIP COVER,RH (Ref # 39156A) | 39156-2148 | 1 |
| PAD,20X50X5 (Ref # 39156B) | 39156-2191 | 4 |
| PAD,10X76X5 (Ref # 39156C) | 39156-2192 | 2 |
| PAD,20X20X5 (Ref # 39156D) | 39156-2194 | 1 |
| PAD,25X50X5 (Ref # 39156E) | 39156-2195 | 1 |
| PAD,15X66X10 (Ref # 39156F) | 39156-2215 | 2 |
| COVER-SEAL (Ref # 49016) | 49016-0683 | 1 |
| COVER TANK,CNT (Ref # 51026) | 51026-0013 | 1 |
| COVER TANK,LH,M.S.BLACK (Ref # 51026A) | 51026-5216-660 | 1 |
| COVER TANK,RH,M.S.BLACK (Ref # 51026B) | 51026-5217-660 | 1 |
| CAP-TANK (Ref # 51049) | 51049-0735 | 1 |
| TANK-COMP-FUEL,M.S.BLACK (Ref # 51093) | 51093-5001-660 | 1 |
| MARK,IG. SWITCH (Ref # 56054) | 56054-2963 | 1 |
| NUT,WELL,5MM (Ref # 92015) | 92015-1757 | 2 |
| COLLAR,6.5X10X14.1 (Ref # 92027) | 92027-1183 | 2 |
| SEAL,FUEL TANK CAP (Ref # 92093) | 92093-1030 | 1 |
| COLLAR,6.3X12X22.6 (Ref # 92152) | 92152-2252 | 2 |
| COLLAR,5.6X8X11.2 (Ref # 92152A) | 92152-2342 | 4 |
| BOLT,SOCKET,5X12 (Ref # 92154) | 92154-4289 | 4 |
| BOLT-FLANGED,6X35 (Ref # 92154A) | 92154-4290 | 4 |
| BOLT-SOCKET,5X12 (Ref # 92154B) | 92154-4291 | 4 |
| BOLT,SOCKET,5X20 (Ref # 92154C) | 92154-4301 | 6 |
| DAMPER,10X20X12 (Ref # 92160) | 92160-1167 | 2 |

2023 Z900 SE PARTS LIST

Fuel Tank

| ITEM NAME | PART NUMBER | QUANTITY |
|-------------------------------------|-------------|----------|
| DAMPER (Ref # 92161) | 92161-0365 | 2 |
| DAMPER (Ref # 92161A) | 92161-0588 | 6 |
| DAMPER,8X16X8.6 (Ref # 92161B) | 92161-0685 | 4 |
| DAMPER,12X28X21 (Ref # 92161C) | 92161-1468 | 2 |
| CLAMP,EDGE CLIP (Ref # 92171) | 92171-1722 | 1 |
| SCREW,5X10 (Ref # 92172) | 92172-0864 | 4 |
| CLAMP,12MM DIA. (Ref # 92173) | 92173-0736 | 2 |
| CLAMP (Ref # 92173A) | 92173-0861 | 1 |
| CLAMP,TUBE (Ref # 92173B) | 92173-2442 | 1 |
| TUBE,6X9X670/30 (Ref # 92192) | 92192-1688 | 1 |
| TUBE,6X9X670/30,BLUE (Ref # 92192A) | 92192-2619 | 1 |
| WASHER,6.5X22X1.6 (Ref # 92200) | 92200-1087 | 2 |
| WASHER,5.2X10X1 (Ref # 92200A) | 92200-2286 | 2 |
| TUBE-RUBBER,6X9X300 (Ref # 702) | 702A06300 | 1 |
| CLAMP,TUBE (Ref # 92173B) | 92173-2442 | 4 |