

1988 Voyager PARTS DIAGRAM

Fuel Tank

F2410-0361

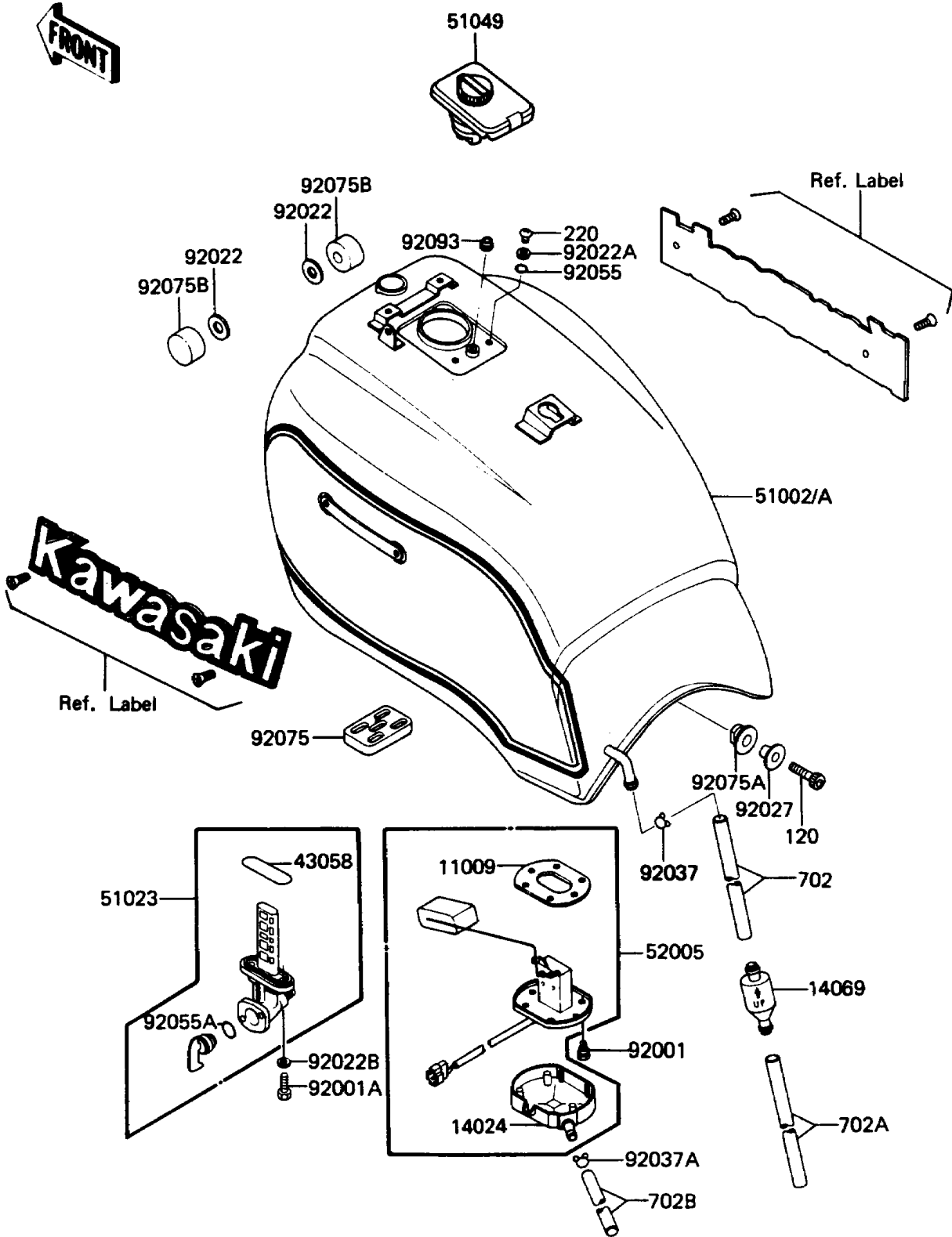

1988 Voyager PARTS LIST

Fuel Tank

ITEM NAME	PART NUMBER	QUANTITY
GASKET,FUEL GAUGE (Ref # 11009)	11009-1037	1
COVER,FUEL GAUGE (Ref # 14024)	14025-1400	1
BREATHER,FUEL TANK (Ref # 14069)	14069-1004	1
RING,TAP FLANGED (Ref # 43058)	51039-010	1
TANK-COMP-FUEL,RED/GRAYSTONE (Ref # 51002)	51002-5160-T1	1
TANK-COMP-FUEL,RED/GRAYSTONE (Ref # 51002A)	51002-5164-T1	1
TAP-ASSY (Ref # 51023)	51023-1054	1
CAP-TANK,FUEL (Ref # 51049)	51049-1059	1
GAUGE,FUEL (Ref # 52005)	52005-1053	1
BOLT,FUEL GAUGE (Ref # 92001)	92001-1069	6
BOLT,6X20 (Ref # 92001A)	92001-1091	2
WASHER,10.5X26X2.3 (Ref # 92022)	92022-044	2
WASHER,5.3X10X0.8 (Ref # 92022A)	92022-1038	2
WASHER,6.2X11X1.5 (Ref # 92022B)	92022-183	2
COLLAR,L=14 (Ref # 92027)	92027-1134	1
CLAMP,TUBE (Ref # 92037)	92037-010	1
CLAMP,TUBE (Ref # 92037A)	92037-147	1
RING-O (Ref # 92055)	92055-1023	2
RING-O (Ref # 92055A)	92055-1036	1
DAMPER,FUEL TANK,RR (Ref # 92075)	92075-1114	1
DAMPER,FUEL TANK (Ref # 92075A)	92075-1116	1
DAMPER,FUEL TANK (Ref # 92075B)	92075-125	2
SEAL,FUEL TANK CAP (Ref # 92093)	92093-1030	1
BOLT-SOCKET,8X30 (Ref # 120)	120P0830	1
SCREW-PAN-CROS (Ref # 220)	220B0510	2
TUBE-RUBBER,7X10X120 (Ref # 702)	702A07120	1
TUBE-RUBBER,7X10X400 (Ref # 702A)	702A07400	1
TUBE-RUBBER,7X10X780 (Ref # 702B)	702A07780	1