

2023 NINJA® 400 KRT EDITION PARTS DIAGRAM

Cowling Lower(HPFNN-HPFBL)

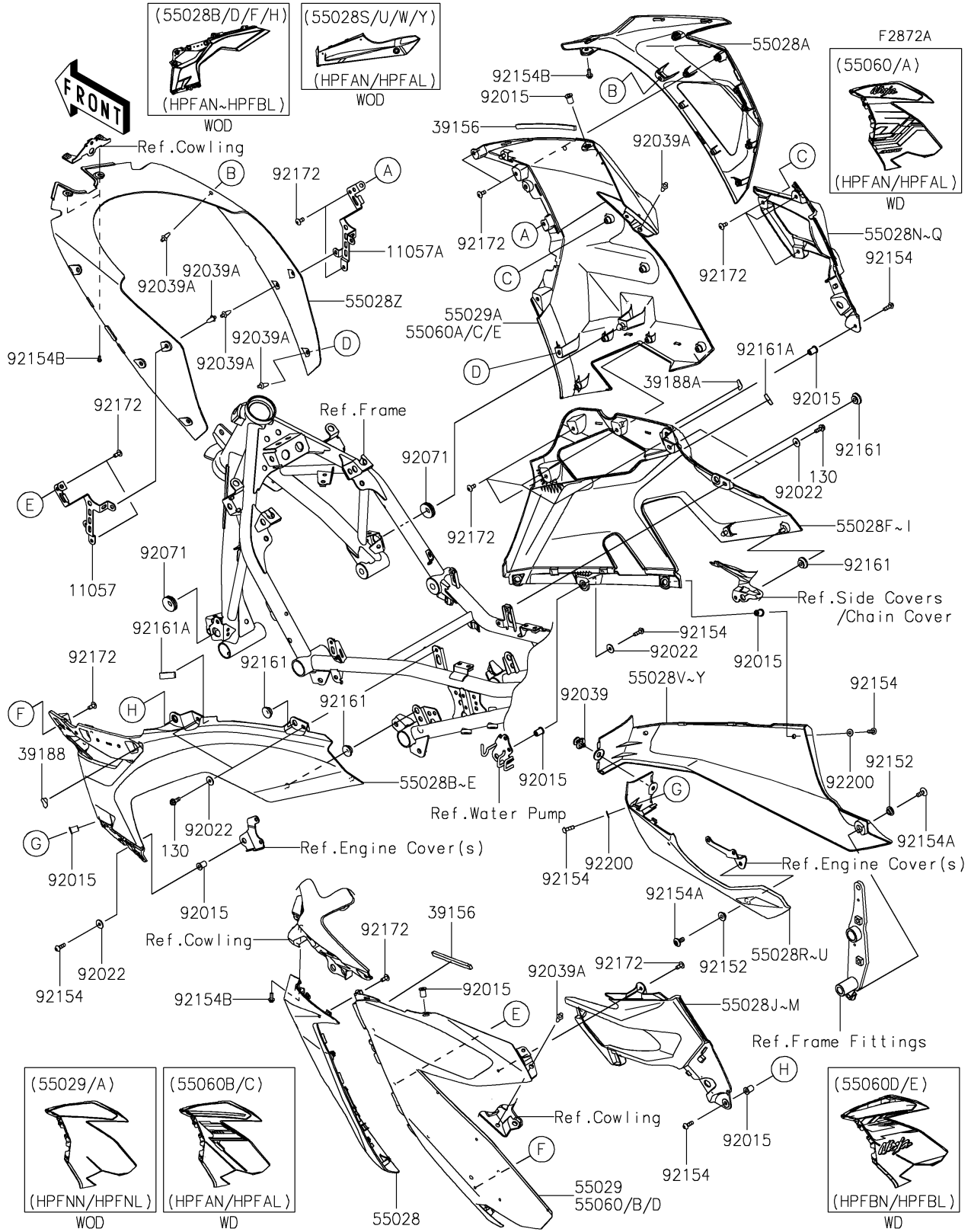

2023 NINJA® 400 KRT EDITION PARTS LIST

Cowling Lowers(HPFNN-HPFBL)

ITEM NAME	PART NUMBER	QUANTITY
BRACKET,COWL.,FR,LH (Ref # 11057)	11057-1197	1
BRACKET,COWL.,FR,RH (Ref # 11057A)	11057-1198	1
PAD,7X130X5 (Ref # 39156)	39156-2296	2
TAPE,LWR SIDE COWL.,LH (Ref # 39188)	39188-0573	1
TAPE,LWR SIDE COWL.,RH (Ref # 39188A)	39188-0574	1
COWLING,SIDE,FR,LH (Ref # 55028)	55028-0637	1
COWLING,SIDE,FR,RH (Ref # 55028A)	55028-0638	1
COWLING,SIDE,LWR,LH,M.C.GRAY (Ref # 55028B)	55028-0641-51A	1
COWLING,SIDE,LWR,LH,M.M.C.GRAY (Ref # 55028C)	55028-0641-51B	1
COWLING,SIDE,LWR,LH,L.GREEN (Ref # 55028E)	55028-0641-777	1
COWLING,SIDE,LWR,RH,M.C.GRAY (Ref # 55028F)	55028-0642-51A	1
COWLING,SIDE,LWR,RH,M.M.C.GRAY (Ref # 55028G)	55028-0642-51B	1
COWLING,SIDE,LWR,RH,L.GREEN (Ref # 55028I)	55028-0642-777	1
COWLING,FIN,LH,M.S.SILVER (Ref # 55028J)	55028-0643-35Z	1
COWLING,FIN,LH,C.L.GREEN (Ref # 55028K)	55028-0643-51P	1
COWLING,FIN,LH,EBONY (Ref # 55028M)	55028-0643-H8	1
COWLING,FIN,RH,M.S.SILVER (Ref # 55028N)	55028-0644-35Z	1
COWLING,FIN,RH,C.L.GREEN (Ref # 55028O)	55028-0644-51P	1
COWLING,FIN,RH,EBONY (Ref # 55028Q)	55028-0644-H8	1
COWLING,LWR,LH,M.C.GRAY (Ref # 55028R)	55028-0645-51A	1
COWLING,LWR,LH,P.B.WHITE (Ref # 55028S)	55028-0645-54X	1
COWLING,LWR,LH,L.GREEN (Ref # 55028U)	55028-0645-777	1
COWLING,LWR,RH,M.C.GRAY (Ref # 55028V)	55028-0646-51A	1
COWLING,LWR,RH,P.B.WHITE (Ref # 55028W)	55028-0646-54X	1
COWLING,LWR,RH,L.GREEN (Ref # 55028Y)	55028-0646-777	1
COWLING,INNER (Ref # 55028Z)	55028-0647	1
COWLING,SIDE,UPP,LH,M.C.GRAY (Ref # 55029)	55028-0686-51A	1
COWLING,SIDE,UPP,RH,M.C.GRAY (Ref # 55029A)	55028-0687-51A	1
COWLING,SIDE,UPP,LH,EBONY (Ref # 55060)	55060-5157-H8	1

2023 NINJA® 400 KRT EDITION PARTS LIST

Cowling Lowers(HPFNN-HPFBL)

ITEM NAME	PART NUMBER	QUANTITY
COWLING,SIDE,UPP,RH,EBONY (Ref # 55060A)	55060-5159-H8	1
COWLING,SIDE,UPP,LH,P.B.WHITE (Ref # 55060B)	55060-5179-54X	1
COWLING,SIDE,UPP,RH,P.B.WHITE (Ref # 55060C)	55060-5183-54X	1
NUT,WELL,5MM (Ref # 92015)	92015-1757	10
WASHER,5.2X16X1.2 (Ref # 92022)	92022-263	6
RIVET,HOLE 8MM (Ref # 92039)	92039-0014	1
RIVET (Ref # 92039A)	92039-0060	10
GROMMET (Ref # 92071)	92071-1043	2
COLLAR,6.5X16X5.6 (Ref # 92152)	92152-1838	2
BOLT,SOCKET,5X16 (Ref # 92154)	92154-0209	8
BOLT,SOCKET,6X14 (Ref # 92154A)	92154-0932	2
BOLT,SOCKET,5X12 (Ref # 92154B)	92154-1421	4
DAMPER (Ref # 92161)	92161-1531	6
DAMPER,10X28X5 (Ref # 92161A)	92161-2107	2
SCREW,5X12 (Ref # 92172)	92172-0821	22
WASHER,5.2X12X1.0 (Ref # 92200)	92200-0784	4
BOLT-FLANGED,5X14 (Ref # 130)	130BA0514	4