

2024 NINJA® e-1 ABS PARTS DIAGRAM

Upper Box

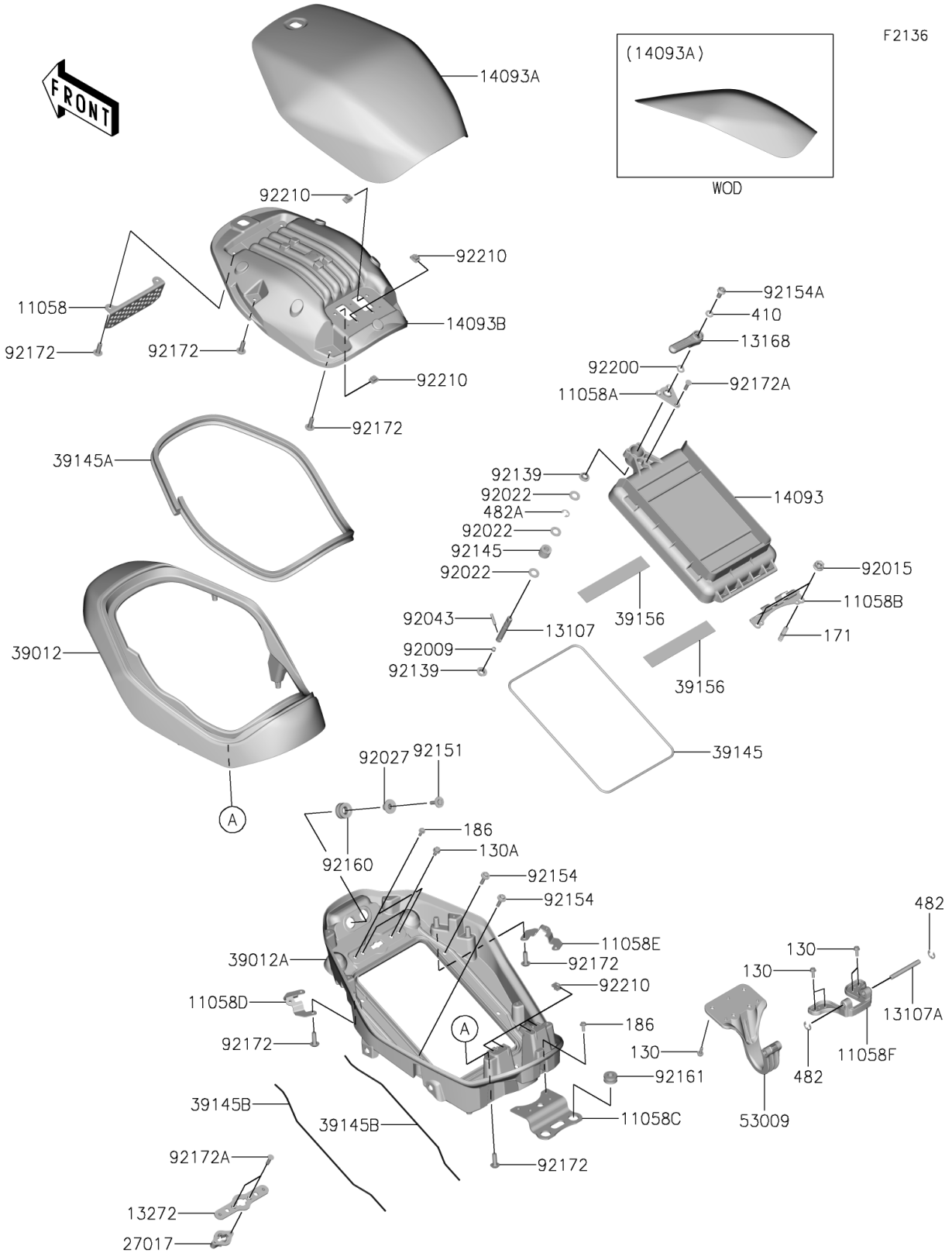

2024 NINJA® e-1 ABS PARTS LIST

Upper Box

ITEM NAME	PART NUMBER	QUANTITY
BRACKET,STORAGE COVER (Ref # 11058)	11058-0757	1
BRACKET,BATTERY LOCK SHAFT (Ref # 11058A)	11058-0781	1
BRACKET,BATTERY LOCK (Ref # 11058B)	11058-0782	1
BRACKET,STORAGE BASE,RR (Ref # 11058C)	11058-0784	1
BRACKET,STORAGE BASE,LH (Ref # 11058D)	11058-0785	1
BRACKET,STORAGE BASE,RH (Ref # 11058E)	11058-0786	1
BRACKET,HINGE (Ref # 11058F)	11058-0787	1
SHAFT,BATTERY LOCK (Ref # 13107)	13107-0987	1
SHAFT,HINGE (Ref # 13107A)	13107-0988	1
LEVER,BATTERY LOCK (Ref # 13168)	13168-0942	1
PLATE,BATTERY LOCK (Ref # 13272)	13272-4261	1
COVER,BATTERY (Ref # 14093)	14093-1487	1
COVER,STORAGE,OUTER,M.B.SILVER (Ref # 14093A)	14093-1488-63S	1
COVER,STORAGE,INNER (Ref # 14093B)	14093-1489	1
LOCK,BATTERY (Ref # 27017)	27017-0578	1
CASE-STORAGE,UPP,EBONY (Ref # 39012)	39012-0077-H8	1
CASE-STORAGE,LWR,EBONY (Ref # 39012A)	39012-0078-H8	1
TRIM-SEAL,CASE-STORAGE,LWR,UPP (Ref # 39145)	39145-0765	1
TRIM-SEAL,STORAGE COVER (Ref # 39145A)	39145-0767	1
TRIM-SEAL,CASE-STORAGE,LWR,LWR (Ref # 39145B)	39145-0769	2
PAD,160X26X1 (Ref # 39156)	39156-2853	2
HINGE,STORAGE COVER (Ref # 53009)	53009-0323	1
SCREW,NUT LOCK (Ref # 92009)	92009-1883	1
NUT,FLANGED,6MM (Ref # 92015)	92015-1367	2
WASHER,10.5X20X1 (Ref # 92022)	92022-239	3
COLLAR (Ref # 92027)	92027-1929	2
PIN (Ref # 92043)	92043-1790	1
BUSHING (Ref # 92139)	92139-0230	2
SPRING (Ref # 92145)	92145-2297	1

2024 NINJA® e-1 ABS PARTS LIST

Upper Box

ITEM NAME	PART NUMBER	QUANTITY
BOLT,6X25 (Ref # 92151)	92151-1241	2
BOLT,6X25 (Ref # 92154)	92154-0467	4
BOLT,SOCKET,5X12 (Ref # 92154A)	92154-1421	1
DAMPER (Ref # 92160)	92160-1007	2
DAMPER,10X24X12 (Ref # 92161)	92161-0927	2
SCREW,TAPPING,5X16 (Ref # 92172)	92172-0175	18
SCREW,4X14 (Ref # 92172A)	92172-1489	5
WASHER,LOCK (Ref # 92200)	92200-2587	1
NUT,PLATE,5MM (Ref # 92210)	92210-0935	8
BOLT-FLANGED,5X14 (Ref # 130)	130BA0514	8
BOLT-FLANGED,6X12 (Ref # 130A)	130BB0612	2
BOLT-STUD,6X14 (Ref # 171)	171BA0614	2
BOLT-UPSET-WP,5X14 (Ref # 186)	186BB0514	6
WASHER-PLAIN-SMALL (Ref # 410)	410AA0500	1
CIRCLIP-TYPE-E,6MM (Ref # 482)	482EA6000	2
CIRCLIP-TYPE-E,8MM (Ref # 482A)	482EA8000	1