

2009 Mule 4010 4x4 PARTS DIAGRAM

Fuel Tank(M9F/MAF)

F2410

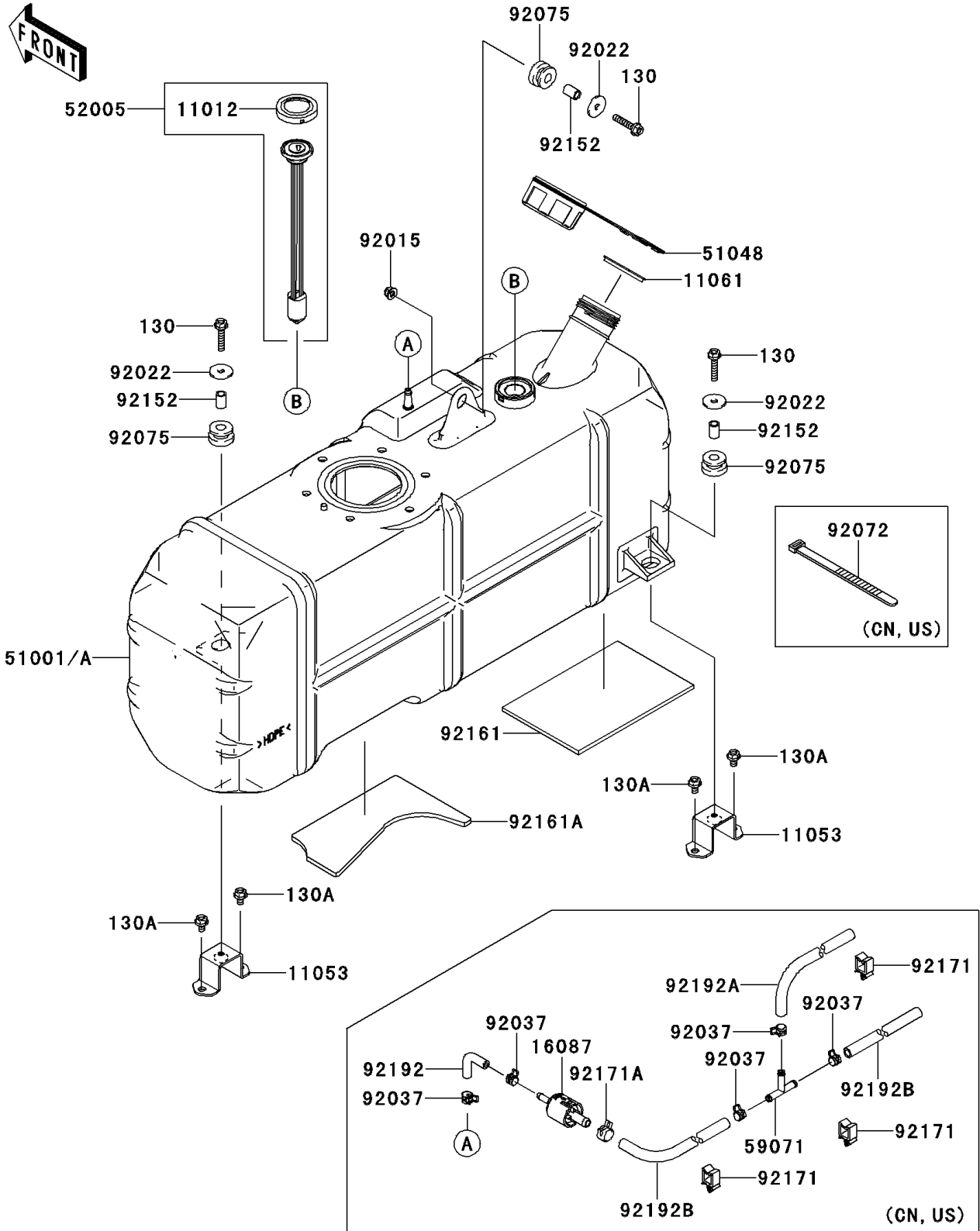

2009 Mule 4010 4x4 PARTS LIST

Fuel Tank(M9F/MAF)

| ITEM NAME | PART NUMBER | QUANTITY |
|--|-------------|----------|
| CAP,FUEL GAUGE (Ref # 11012) | 11012-1627 | 1 |
| BRACKET (Ref # 11053) | 11053-7512 | 2 |
| GASKET,FUEL TANK CAP (Ref # 11061) | 11061-0395 | 1 |
| VALVE-CHECK (Ref # 16087) | 16087-0002 | 1 |
| TANK-COMP-FUEL (Ref # 51001) | 51001-0292 | 1 |
| TANK-COMP-FUEL (Ref # 51001A) | 51001-0293 | 1 |
| CAP-ASSY-TANK,FUEL (Ref # 51048) | 51048-0026 | 1 |
| GAUGE,FUEL (Ref # 52005) | 52005-7501 | 1 |
| JOINT (Ref # 59071) | 59071-3705 | 1 |
| NUT,LOCK,FLANGED,6MM (Ref # 92015) | 92015-1675 | 1 |
| WASHER,6.5X24X2 (Ref # 92022) | 92022-1690 | 3 |
| CLAMP,TUBE (Ref # 92037) | 92037-1461 | 5 |
| BAND,L=123 (Ref # 92072) | 92072-030 | 1 |
| DAMPER (Ref # 92075) | 92075-1787 | 3 |
| COLLAR,7.02X10.32X15.3 (Ref # 92152) | 92152-7511 | 3 |
| DAMPER,92X35X4.76 (Ref # 92161) | 92161-7508 | 1 |
| DAMPER,92X19X4.76 (Ref # 92161A) | 92161-7513 | 1 |
| CLAMP (Ref # 92171) | 92171-0290 | 3 |
| CLAMP (Ref # 92171A) | 92171-0515 | 1 |
| TUBE,FUEL TANK-CHECK VALVE (Ref # 92192) | 92192-0067 | 1 |
| TUBE,7X11X370 (Ref # 92192A) | 92192-7512 | 1 |
| TUBE,7X11X225 (Ref # 92192B) | 92192-7513 | 2 |
| BOLT-FLANGED,6X30 (Ref # 130) | 130BA0630 | 3 |
| BOLT-FLANGED,6X10 (Ref # 130A) | 130BB0610 | 4 |