

# 2010 Mule 4000 PARTS DIAGRAM

Drive Converter

E1391

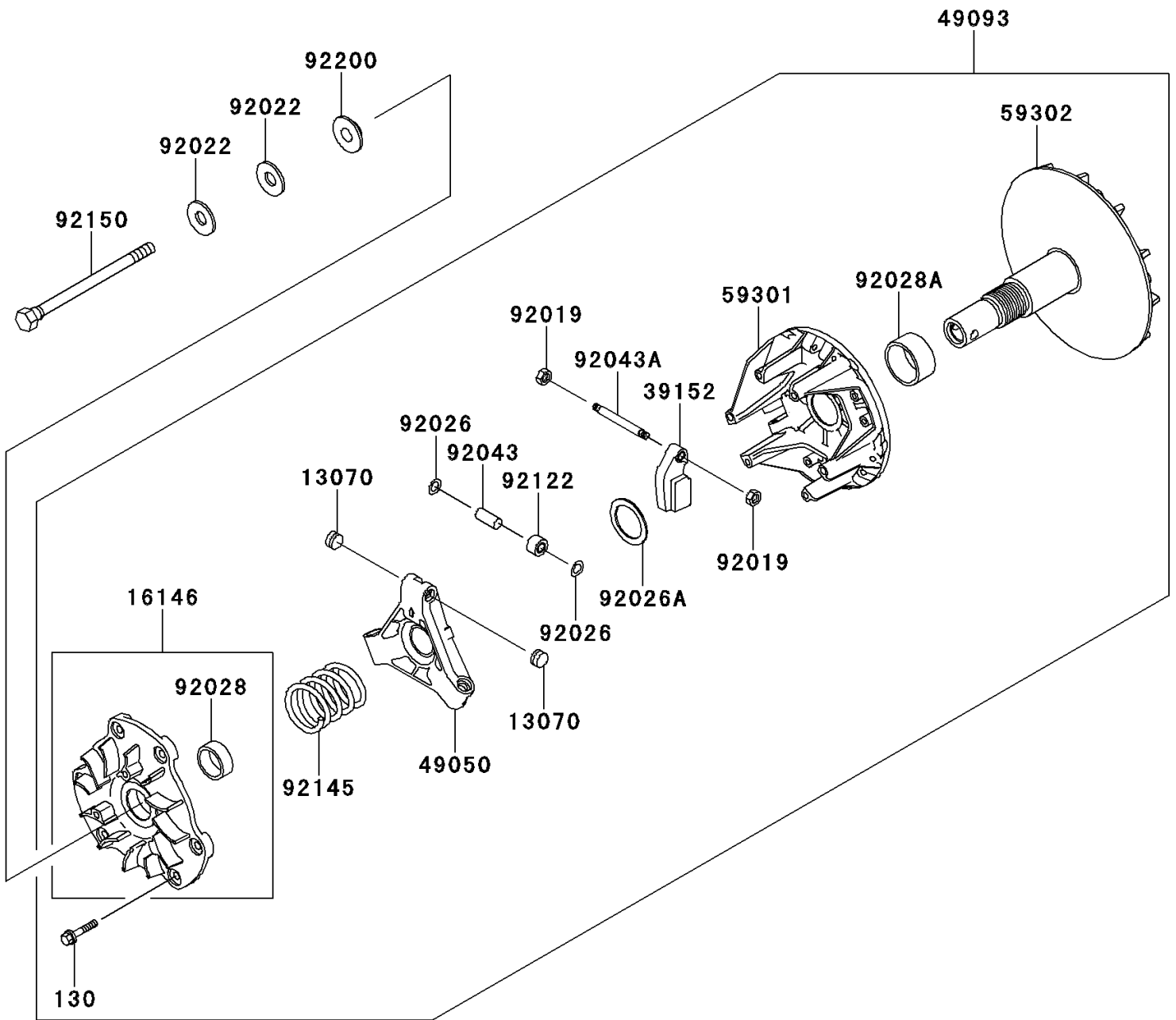

## 2010 Mule 4000 PARTS LIST

### Drive Converter

| ITEM NAME                            | PART NUMBER | QUANTITY |
|--------------------------------------|-------------|----------|
| GUIDE (Ref # 13070)                  | 13070-1330  | 6        |
| COVER-ASSY (Ref # 16146)             | 16146-1219  | 1        |
| WEIGHT-RAMP (Ref # 39152)            | 39152-1078  | 3        |
| SPIDER (Ref # 49050)                 | 49050-0013  | 1        |
| CONVERTER-ASSY-DRIVE (Ref # 49093)   | 49093-0025  | 1        |
| SHEAVE-MOVABLE (Ref # 59301)         | 59301-0016  | 1        |
| SHEAVE-COMP (Ref # 59302)            | 59302-1085  | 1        |
| NUT,LOCK,6MM (Ref # 92019)           | 92019-008   | 6        |
| WASHER,SPECIAL CONICAL (Ref # 92022) | 92022-1901  | 2        |
| SPACER (Ref # 92026)                 | 92026-1512  | 6        |
| SPACER,32.3X44.3X3.6 (Ref # 92026A)  | 92026-1591  | 1        |
| BUSHING (Ref # 92028)                | 92028-1861  | 1        |
| BUSHING (Ref # 92028A)               | 92028-1864  | 1        |
| PIN (Ref # 92043)                    | 92043-1572  | 3        |
| PIN (Ref # 92043A)                   | 92043-1573  | 3        |
| ROLLER (Ref # 92122)                 | 92122-1204  | 3        |
| SPRING,YELLOW PAINT (Ref # 92145)    | 92145-0639  | 1        |
| BOLT,12X163.5 (Ref # 92150)          | 92150-1008  | 1        |
| WASHER (Ref # 92200)                 | 92200-1401  | 1        |
| BOLT-FLANGED,6X30 (Ref # 130)        | 130CA0630   | 6        |