

2004 ZRX1200R PARTS DIAGRAM

Front Brake(A4)

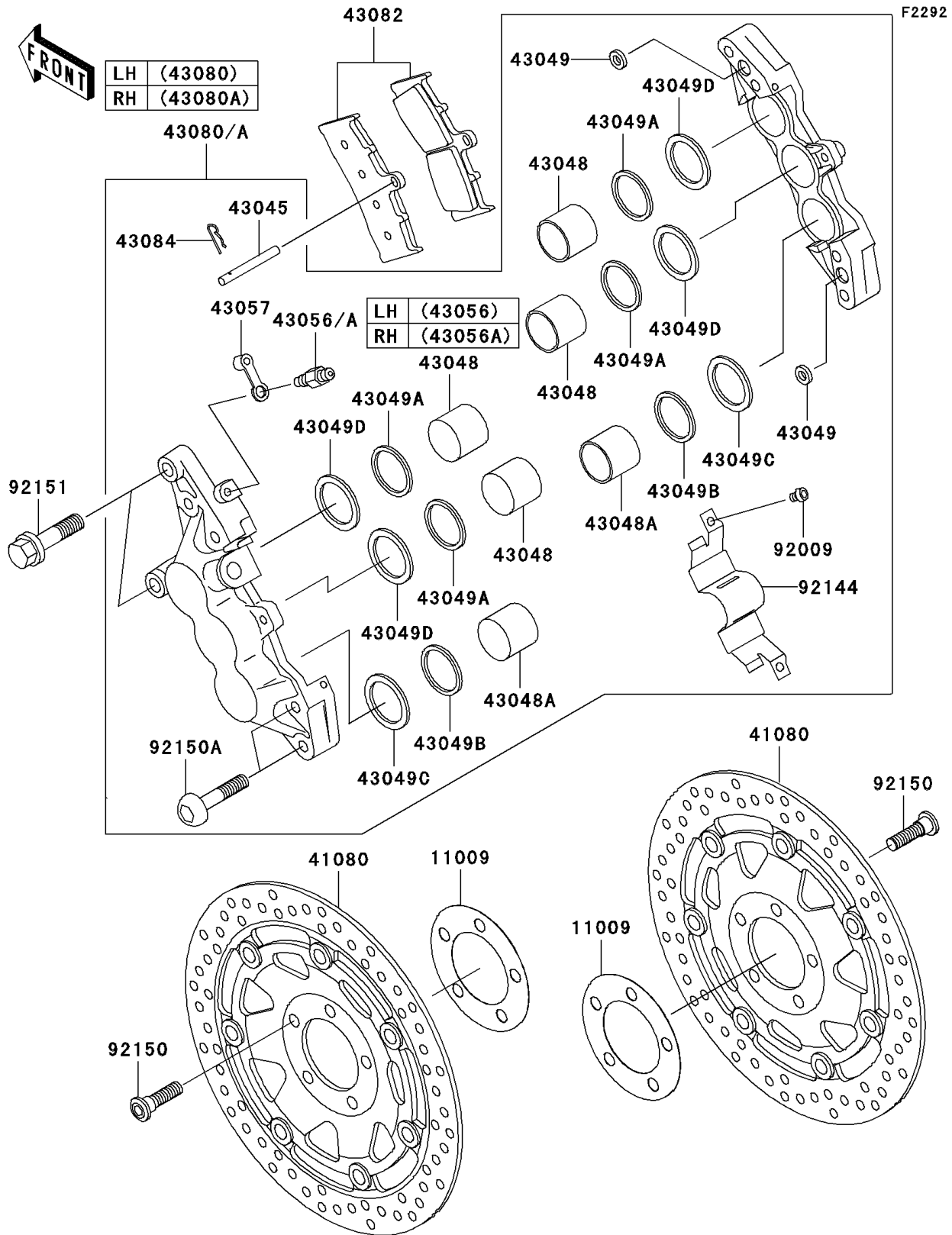

2004 ZRX1200R PARTS LIST

Front Brake(A4)

ITEM NAME	PART NUMBER	QUANTITY
GASKET,DISC PLATE (Ref # 11009)	11009-1754	2
DISC,FR,HOUSING GOLD+DISC SIL (Ref # 41080)	41080-0066-488	2
SHAFT-CALIPER (Ref # 43045)	43045-007	2
PISTON-CALIPER (Ref # 43048)	43048-1078	8
PISTON-CALIPER (Ref # 43048A)	43048-1079	4
PACKING,SEAL,6.5X11.5X2.2 (Ref # 43049)	43049-1004	4
PACKING,PISTON (Ref # 43049A)	43049-1055	8
PACKING,PISTON (Ref # 43049B)	43049-1059	4
PACKING,PISTON SEAL (Ref # 43049C)	43049-1090	4
PACKING,PISTON SEAL (Ref # 43049D)	43049-1096	8
BREATHER (Ref # 43056)	43056-003	1
BREATHER-BRAKE (Ref # 43056A)	43056-1056	1
CAP-BREATHER (Ref # 43057)	43057-003	2
CALIPER-SUB-ASSY,FR,LH,BLACK (Ref # 43080)	43080-5026-DJ	1
CALIPER-SUB-ASSY,FR,RH,BLACK (Ref # 43080A)	43080-5027-DJ	1
PAD-ASSY-BRAKE (Ref # 43082)	43082-1272	2
CLAMP,PAD (Ref # 43084)	43084-003	2
BOLT,SOCKET,4X6 (Ref # 92009)	92009-1758	4
SPRING (Ref # 92144)	92144-1903	2
BOLT,SOCKET,8X30 (Ref # 92150)	92150-1771	10
BOLT,SOCKET,8X40 (Ref # 92150A)	92150-1973	8
BOLT,FLANGED,10X38 (Ref # 92151)	92151-1288	4