

# 2003 ZR-7S PARTS DIAGRAM

## Secondary Shaft

E1322

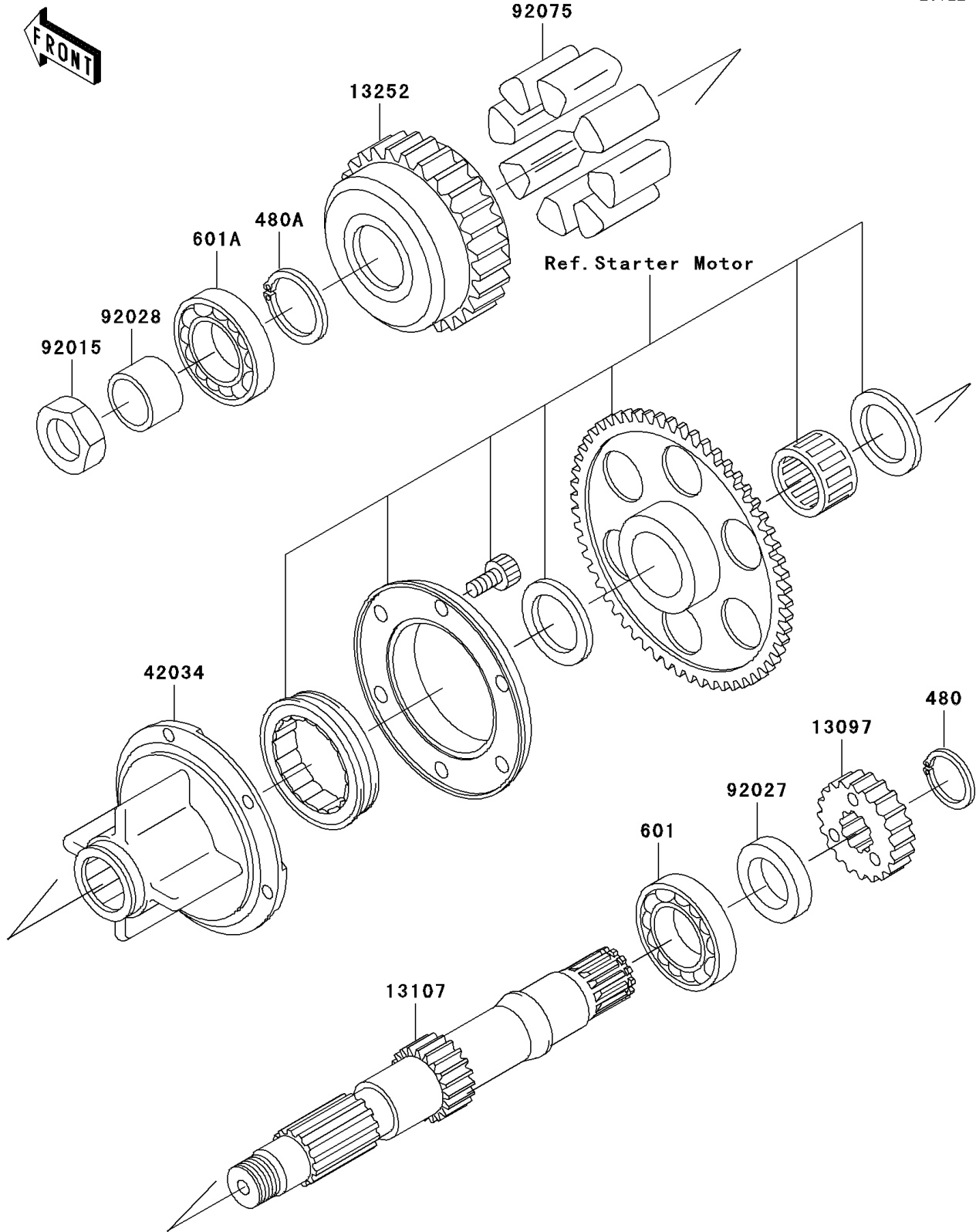

## 2003 ZR-7S PARTS LIST

### Secondary Shaft

| ITEM NAME                                    | PART NUMBER | QUANTITY |
|--|-------------|----------|
| CIRCLIP-TYPE-C,22MM (Ref # 480)              | 480J2200    | 1        |
| CIRCLIP-TYPE-C,28MM (Ref # 480A)             | 480J2800    | 1        |
| BEARING-BALL,#6305 (Ref # 601)               | 601A6305    | 1        |
| BEARING-BALL,#6205C3 (Ref # 601A)            | 601B6205    | 1        |
| GEAR,SECONDARY SHAFT,29T (Ref # 13097)       | 13097-1345  | 1        |
| SHAFT,SECONDARY (Ref # 13107)                | 13107-1426  | 1        |
| COUPLING,OUTER,SECONDARY SHAFT (Ref # 13252) | 13252-001   | 1        |
| COUPLING (Ref # 42034)                       | 42034-1151  | 1        |
| NUT,18MM (Ref # 92015)                       | 92015-019   | 1        |
| COLLAR,23X46X4.5 (Ref # 92027)               | 92027-263   | 1        |
| BUSHING,20X25X16.6 (Ref # 92028)             | 92028-1037  | 1        |
| DAMPER (Ref # 92075)                         | 92075-1227  | 8        |