

# 1988 NINJA® ZX-10 PARTS DIAGRAM

Seat

F2510-0355

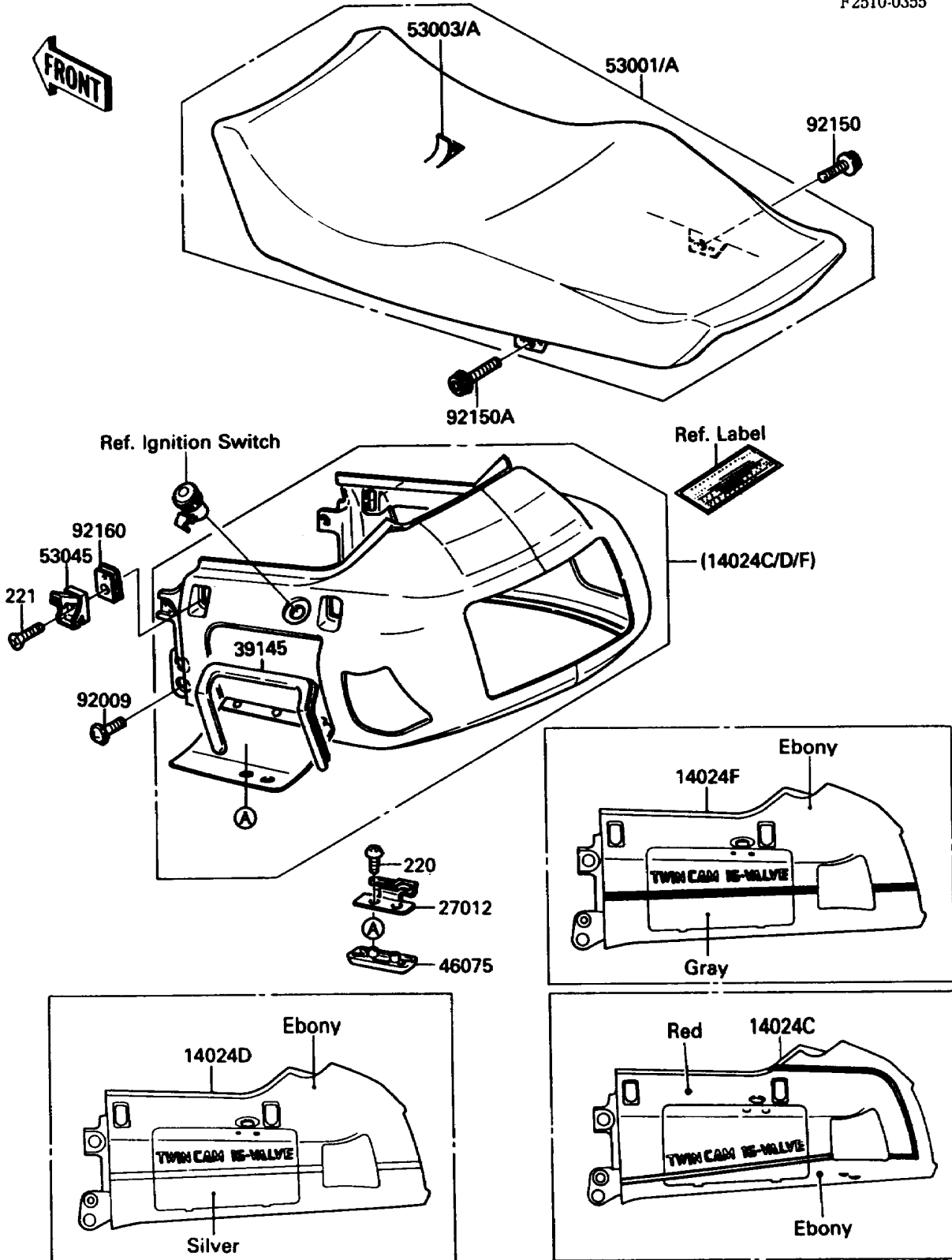

# 1988 NINJA® ZX-10 PARTS LIST

## Seat

| ITEM NAME                              | PART NUMBER   | QUANTITY |
|--|---------------|----------|
| SCREW-PAN-CROS,4X6 (Ref # 220)         | 220D0406      | 2        |
| SCREW-CSK-CROS (Ref # 221)             | 221E0625      | 4        |
| COVER,SEAT,EBONY/RED (Ref # 14024C)    | 14024-5093-J3 | 1        |
| HOOK,TOOL BOX COVER (Ref # 27012)      | 27012-1395    | 1        |
| TRIM-SEAL,TOOL BOX (Ref # 39145)       | 39145-1088    | 1        |
| GRIP,TOOL BOX COVER (Ref # 46075)      | 46075-1077    | 1        |
| SEAT-ASSY,DUAL,BLACK (Ref # 53001A)    | 53001-1545-NR | 1        |
| LEATHER,SEAT,BLACK (Ref # 53003A)      | 53003-1206-NR | 1        |
| HOOK-ASSY,TOOL BOX (Ref # 53045)       | 53045-1053    | 4        |
| SCREW,6X18,BLACK (Ref # 92009)         | 92009-1181    | 2        |
| BOLT,SOCKET,8X20 (Ref # 92150)         | 92150-1155    | 1        |
| BOLT,SOCKET,8X30 (Ref # 92150A)        | 92150-1156    | 1        |
| DAMPER,ROPE HOOK (Ref # 92160)         | 92160-1042    | 4        |
| COVER,SEAT,EBONY/SILVER (Ref # 14024D) | 14024-5094-DE | 1        |