

1990 Ninja® ZX™-10 PARTS DIAGRAM

Rear Brake

F 2294

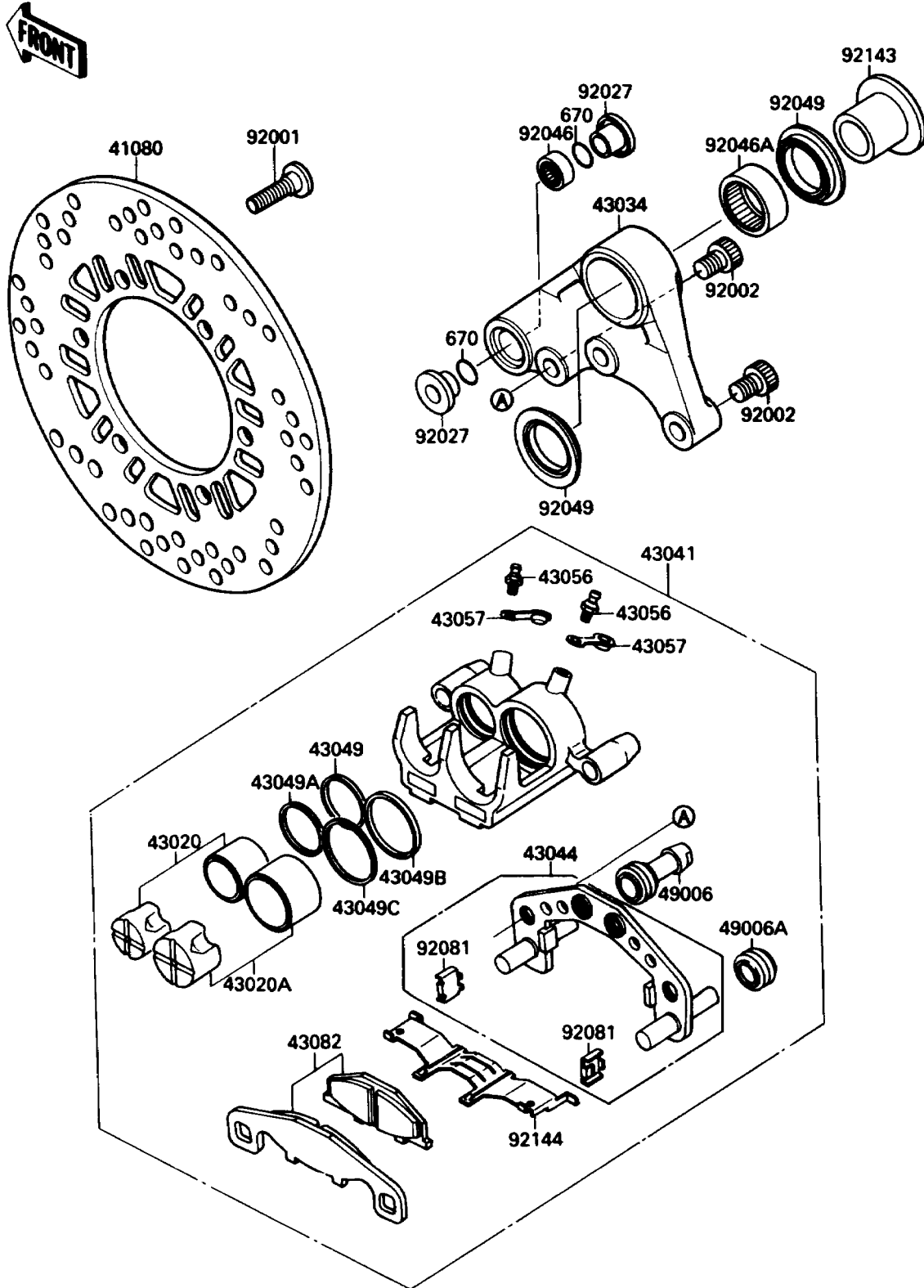

1990 Ninja® ZX™-10 PARTS LIST

Rear Brake

| ITEM NAME | PART NUMBER | QUANTITY |
|---|---------------|----------|
| DISC,RR,SILVER NO.1 (Ref # 41080) | 41080-1219-CM | 1 |
| PISTON-COMP-BRAKE (Ref # 43020) | 43020-1068 | 1 |
| PISTON-COMP-BRAKE (Ref # 43020A) | 43020-1069 | 1 |
| HOLDER-BRAKE,REAR CALIPER,SIL (Ref # 43034) | 43034-1090-CE | 1 |
| CALIPER-ASSY,RR,BLACK (Ref # 43041) | 43041-1261-DJ | 1 |
| HOLDER-COMP-CALIPER (Ref # 43044) | 43044-1067 | 1 |
| PACKING,PISTON SEAL (Ref # 43049) | 43049-1054 | 1 |
| PACKING,PISTON (Ref # 43049A) | 43049-1055 | 1 |
| PACKING,PISTON SEAL (Ref # 43049B) | 43049-1056 | 1 |
| PACKING,PISTON (Ref # 43049C) | 43049-1057 | 1 |
| BREATHER (Ref # 43056) | 43056-003 | 1 |
| CAP-BREATHER (Ref # 43057) | 43057-003 | 2 |
| PAD-ASSY-BRAKE (Ref # 43082) | 43082-1088 | 1 |
| BOOT,CALIPER (Ref # 49006) | 49006-1094 | 1 |
| BOOT,CALIPER (Ref # 49006A) | 49006-1095 | 1 |
| BOLT,DISC PLATE,8X30 (Ref # 92001) | 92001-1951 | 6 |
| BOLT,SOCKET,10X17 (Ref # 92002) | 92002-1713 | 3 |
| COLLAR,L=11.5 (Ref # 92027) | 92027-1040 | 2 |
| BEARING-NEEDLE,HK1216LL (Ref # 92046) | 92046-1009 | 1 |
| BEARING-NEEDLE,BM283417 (Ref # 92046A) | 92046-1111 | 1 |
| SEAL-OIL (Ref # 92049) | 92049-1181 | 2 |
| SPRING,PAD STOPPER (Ref # 92081) | 92081-1661 | 2 |
| COLLAR,L=35 (Ref # 92143) | 92143-1043 | 1 |
| SPRING,PAD (Ref # 92144) | 92144-1070 | 1 |
| O RING,11MM (Ref # 670) | 670B2011 | 2 |