

2006 Ninja® ZX™-10R PARTS DIAGRAM

Throttle

E1510

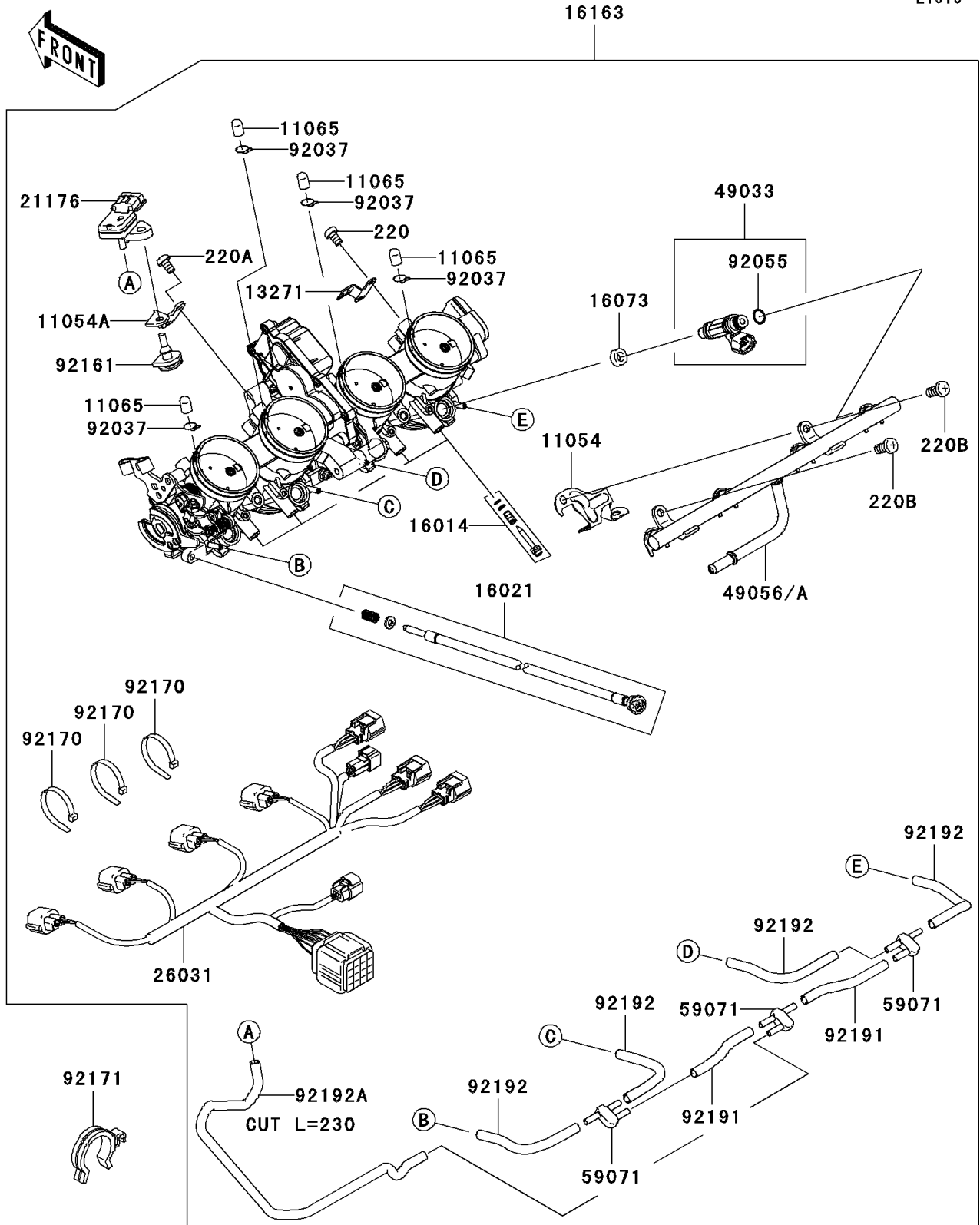

2006 Ninja® ZX™-10R PARTS LIST

Throttle

| ITEM NAME | PART NUMBER | QUANTITY |
|---------------------------------------|-------------|----------|
| SCREW-PAN-CROSS,5X6 (Ref # 220) | 220D0506 | 2 |
| SCREW-PAN-CROS,5X8 (Ref # 220A) | 220D0508 | 2 |
| SCREW-PAN-CROSS,6X12 (Ref # 220B) | 220D0612 | 2 |
| BRACKET (Ref # 11054) | 11054-0554 | 1 |
| BRACKET (Ref # 11054A) | 11054-0556 | 1 |
| CAP (Ref # 11065) | 11065-0072 | 4 |
| PLATE (Ref # 13271) | 13271-0792 | 1 |
| SCREW-PILOT AIR (Ref # 16014) | 16014-0005 | 4 |
| SCREW-THROTTLE STOP (Ref # 16021) | 16021-0007 | 1 |
| INSULATOR,INJECTER (Ref # 16073) | 16073-1123 | 4 |
| THROTTLE-ASSY (Ref # 16163) | 16163-0072 | 1 |
| SENSOR,PRESSURE (Ref # 21176) | 21176-0058 | 1 |
| HARNESS (Ref # 26031) | 26031-0344 | 1 |
| NOZZLE-INJECTION (Ref # 49033) | 49033-0010 | 4 |
| PIPE-INJECTION (Ref # 49056) | 49056-0013 | 1 |
| JOINT (Ref # 59071) | 59071-0022 | 3 |
| CLAMP,TUBE (Ref # 92037) | 92037-1124 | 4 |
| RING-O,INJECTION NOZZLE (Ref # 92055) | 92055-1622 | 4 |
| DAMPER (Ref # 92161) | 92161-0041 | 1 |
| CLAMP (Ref # 92170) | 92170-3749 | 3 |
| CLAMP (Ref # 92171) | 92171-0359 | 1 |
| TUBE,3.2X7.4X70 (Ref # 92191) | 92191-1552 | 2 |
| TUBE (Ref # 92192) | 92192-0131 | 4 |
| TUBE (Ref # 92192A) | 92192-0351 | 1 |